

961-416

7/15/2010

1/26

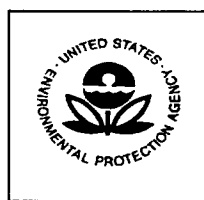

U.S. ENVIRONMENTAL PROTECTION AGENCY
Office of Pesticide Programs
Registration Division (7505P)
Ariel Rios Building
1200 Pennsylvania Ave., NW
Washington, D.C. 20460

EPA Registration Number:

 961-416

Date of Issuance:

 JUL 15 2010

NOTICE OF PESTICIDE:
 Registration
 Reregistration
 (under FIFRA, as amended)

Term of Issuance:
 Conditional

Name of Pesticide Product:
 Turf Fertilizer with Barricade®
 0.29%

Name and Address of Registrant (include ZIP Code):
 Lebanon Seaboard Corporation
 1600 East Cumberland Street
 Lebanon, PA 17042

Note: Changes in labeling differing in substance from that accepted in connection with this registration must be submitted to and accepted by the Registration Division prior to use of the label in commerce. In any correspondence on this product always refer to the above EPA registration number.

On the basis of information furnished by the registrant, the above named pesticide is hereby registered/reregistered under the Federal Insecticide, Fungicide and Rodenticide Act. Registration is in no way to be construed as an endorsement or recommendation of this product by the Agency. In order to protect health and the environment, the Administrator, on his motion, may at any time suspend or cancel the registration of a pesticide in accordance with the Act. The acceptance of any name in connection with the registration of a product under this Act is not to be construed as giving the registrant a right to exclusive use of the name or to its use if it has been covered by others.

This product is conditionally registered in accordance with FIFRA sec. 3 (c) (7) (A) provided that you:

1. Submit and/or cite all data required for the registration/ reregistration review of your product when the Agency requires all registrants of similar products to submit data; and submit acceptable responses required for reregistration of your product under FIFRA section 4.
2. Change the EPA Registration Number to read: "961-416".
3. Make the following label changes:
 - a. Under the "Environmental Hazards" section, first paragraph, add a "period" at the end of the third sentence.
 - b. The "rates" on the proposed label cannot be higher than the rates on the cited label. Make the following revisions:
 - On page 6, under the Maximum Application Rate..." chart, in the turf species for bermudagrass, bahiagrass..." revise the Lbs. Product to read "11.6"; and the Buffalo grass, Kentucky... to read "7.8" lbs.
 - On page 7, under the Overseed Application Chart, change the pound of a.i. from ".75" to ".74".

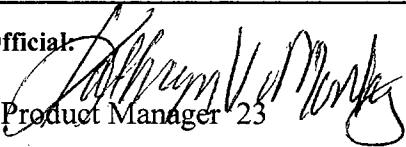
Signature of Approving Official:

 Kathryn V. Montague, Product Manager 23
 Herbicide Branch
 Registration Division (7505P)

Date:

 JUL 15 2010

4. NOTE: Should you wish to add/retain a reference to the company's website on your label, then please be aware that the website becomes labeling under the Federal Insecticide Fungicide and Rodenticide Act and is subject to review by the Agency. If the website is false or misleading, the product would be misbranded and unlawful to sell or distribute under FIFRA section 12(a)(1)(E). 40 CFR 156.10(a)(5) list examples of statements EPA may consider false or misleading. In addition, regardless of whether a website is referenced on your product's label, claims made on the website may not substantially differ from those claims approved through the registration process. Therefore, should the Agency find or if it is brought to our attention that a website contains false or misleading statements or claims substantially differing from the EPA approved registration, the website will be referred to the EPA's Office of Enforcement and Compliance.

5. On page 16, remove the logo "GreenSmart" for a green lawn". It closely resembles a recycling logo and may give a false or misleading impression to the purchaser.

If these conditions are not complied with, the registration will be subject to cancellation in accordance with FIFRA sec. 6(e). Your release for shipment of the product constitutes acceptance of these conditions. Submit one (1) copy of the revised final printed label before the product is released for shipment.

Enclosure

TURF FERTILIZER WITH BARRICADE® 0.29%

ACTIVE INGREDIENT:

Prodiamine: 0.29%

OTHER INGREDIENTS: 99.71%

TOTAL 100.00%

EPA Reg. No. 961-URA (L) (D) EPA Est. No. 961-PA-01:961-IL-01
Superscript used is first letter of lot number

Barricade® is a Registered Trademark of the Syngenta Group Company.

READ THE ENTIRE LABEL BEFORE USING THIS PRODUCT. USE ONLY ACCORDING TO LABEL INSTRUCTIONS.

Before buying this product, read the Warranty Section elsewhere on this label. If terms are not acceptable, return the unopened container to the place of purchase at once.

Guaranteed Fertilizer Analysis	
Total Nitrogen (N).....	XX%
Available Phosphate (P ₂ O ₅).....	XX%
Soluble Potash (K ₂ O).....	XX%

For selective preemergence control of grass and broadleaf weeds in:

- established turfgrasses and lawns
- [landscape ornamentals (including established perennials & wildflower plantings)]

KEEP OUT OF REACH OF CHILDREN CAUTION

ACCEPTED
with **COMMENTS**
In EPA Letter Dated:
JUL 15 2010
Under the Federal Insecticide, Fungicide, and Rodenticide Act as amended, for the pesticide registered under EPA Reg. No.

See back panel for Additional Precautionary Statements.

961-416

MANUFACTURED BY: [Distributed By: [Produced By:] Company name and address]

LEBANON SEABOARD CORPORATION
1600 EAST CUMBERLAND STREET
LEBANON, PA 17042
Made in the U.S.A.

www.lebsea.com [www.LebanonTurf.com] [www.greenviewfertilizer.com] [www.xyz.com]

NET WEIGHT: XX LBS (X.X kg) Net Weight: [Net Wt.:] xx lbs. [LBS.] [POUNDS] [(XX.X kg) [(XX.X KG)], Treats: XX,XXX Sq.Ft. [SQ.FT.] [Square Feet] [SQUARE FEET]

COVERS: [Treats:] X,XXX Sq. Ft. [Covers [X,XXX] Square Feet [SQUARE FEET] [SQ. FT.] [Sq. Ft.]

[Optional Heading: Care & Handling]

**PRECAUTIONARY STATEMENTS
HAZARDS TO HUMANS AND DOMESTIC ANIMALS**

CAUTION

Causes moderate eye injury (irritation). Harmful if inhaled or absorbed through the skin. Avoid contact with skin, eyes, or clothing. Avoid breathing dust. Wash thoroughly with soap and water after handling. Prolonged or frequently repeated skin contact while handling the material may cause allergic reactions in some individuals.

FIRST AID

- IF IN EYES:**
 - Hold eye open and rinse slowly and gently with water for 15-20 minutes.
 - Remove contact lenses, if present, after the first 5 minutes, then continue rinsing eye.
 - Call a poison control center or doctor for treatment advice.
- IF ON SKIN:**
 - Take off contaminated clothing.
- OR CLOTHING:**
 - Rinse skin immediately with plenty of water for 15-20 minutes.
 - Call a poison control center or doctor for treatment advice.
- IF INHALED:**
 - Move person to fresh air.
 - If person is not breathing, call 911 or an ambulance, then give artificial respiration, preferably by mouth-to-mouth, if possible.
 - Call a poison control center or doctor for further treatment advice.

Have the product container or label with you when calling a poison control center or doctor, or going for treatment. You may also contact (888) 208-1368 for emergency medical treatment information.

ENVIRONMENTAL HAZARDS

This product has low solubility in water. At the limits of solubility, this product is not toxic to fish. However, at concentrations above the level of water solubility, it may be toxic to fish. Drift and runoff from treated areas may be hazardous to aquatic organisms in adjacent sites. To protect the environment, do not allow pesticide to enter or run off into storm drains, drainage ditches, gutters or surface waters. Applying this product in calm weather will help to ensure that wind does not blow pesticide off the treatment area. Sweeping any product that lands on a driveway, sidewalk, or street, back onto the treated area of the lawn will help to prevent run off to water bodies and drainage systems.

If material is spilled: Contain and sweep up material of spill for disposal or use per label instructions. Wash cleanup equipment to prevent contamination elsewhere. Excess quantities above normal application rates could result in damage to plants subject to spill. Water-in remainder, disc under, cover with layer of soil, or leave exposed to sunlight, as deemed appropriate to the situation.

DIRECTIONS FOR USE

It is a violation of Federal Law to use this product in a manner inconsistent with its labeling. For Outdoor Residential Use. [TURF FERTILIZER WITH BARRICADE 0.29% or This product] is a selective pre-emergence herbicide that provides residual control of many grass and broadleaf weeds in established turfgrasses and lawns. [landscape ornamentals, established perennials and wildflower plantings.]

[TURF FERTILIZER WITH BARRICADE 0.29% or This product] controls susceptible weeds by inhibiting weed seeds germination and root development. Most effective weed control will be obtained

when [TURF FERTILIZER WITH BARRICADE 0.29% or this product] is activated by at least 0.5 inch of rainfall or irrigation, or with shallow (1-2 inches) incorporation, prior to weed seed germination and within 14 days following application.

[APPLICATION DIRECTIONS]

[Optional heading: SPREADER SETTINGS]

[Note: Registrant/Subregistrant may insert appropriate spreader setting information based on desired spreaders and use rates as listed. See spreader examples at the end of the label.]

Drop Spreaders	Application Rate XX lbs. /1,000 sq.ft.
XXXX	XX
Broadcast Spreaders	Application Rate XX lbs. /1,000 sq.ft.
XXXX	XX

These settings were calibrated and field tested. However, age and condition of spreader, speed of operation, and evenness of terrain may require slightly different settings for desired coverage.

Optional [Application Equipment and Instructions] [Spreader Directions]:

Determining Your Lawn's Square Footage

To determine how much of this product to apply, you must determine the square footage of your lawn. An easy way to do this is to walk the length of your lawn, figuring that one pace equals about 3 feet. Do the same with the width of the lawn. Then multiply the length by the width to arrive at the total. Make sure you subtract the square footage of your home and driveway when calculating the total square footage of your lawn. If your lawn has an irregular shape, try dividing it up into a number of square areas. Calculate the square footage for each area, then add the figures together to reach your total lawn size.

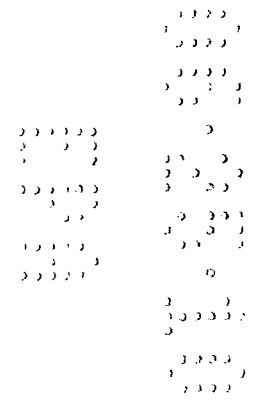
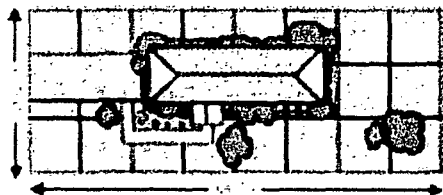

Spreader Tips

The two main types of spreaders are the Drop Spreader, which drops the material straight down the width of the spreader as you push, and the Broadcast Spreader (also known as a rotary), which throws the material from the spreader.

Drop Spreader: First make two passes along the top of the area you'll be covering. Then make two passes along the bottom area. Then move back and forth along the long part of the lawn. On each pass, as you reach the strips at the top and bottom of the area to be covered, shut off the spreader. It's also important to shut off the spreader when you are stopped.

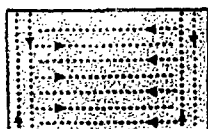

Broadcast Spreader: Apply in a single pass by starting on the outside border and apply in a circular path working toward the center.

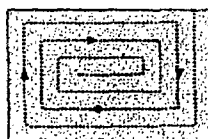

[Optional Spreader Language:]

The above spreader settings are approximate. To check your spreader: XX lb. of material covers approximately XXX sq. ft. (X lbs. of material per XXXX sq. ft.)

Note: if spreader model does not appear above please call [toll free] XXX-XXX-XXXX, X am - Xpm [ET] [CT] [MT] [PT], [Monday – Friday] [Monday – Sunday] [Anytime] [24/7] for additional model settings.

[Optional Heading:] [Use Instructions] [Instructions] [Application Instructions] [Application Directions] [When & How to Apply]

ESTABLISHED TURF

[TURF FERTILIZER WITH BARRICADE 0.29% or this product] is a selective preemergence herbicide that, when properly applied, will control certain grass and broadleaf weeds in established turfgrasses and lawns. The maximum amount of [TURF FERTILIZER WITH BARRICADE 0.29% or this product] that may be applied per year is given for each turfgrass species in the **Maximum Annual Rates** section of this label.

Most effective weed control in turfgrasses will be obtained when [TURF FERTILIZER WITH BARRICADE 0.29% or this product] is activated by at least 0.5 inch of rainfall or irrigation prior to weed seed germination and within 14 days following application. See the map below for approximate crabgrass seed germination dates.

CRABGRASS SEED GERMINATION DATES

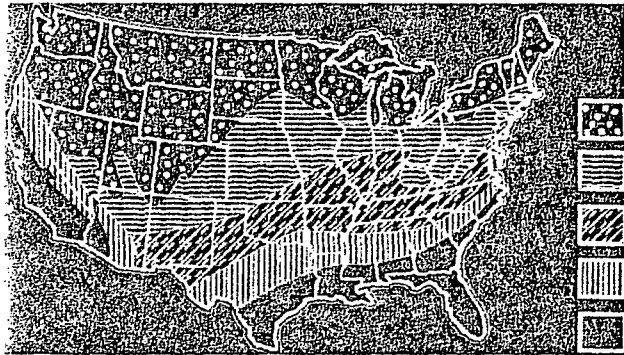

Approximate Date

After May 30

After May 10

After April 20

After March 20

January 1 to March 20

USE PRECAUTIONS

The following precautions apply to the use of [TURF FERTILIZER WITH BARRICADE 0.29% or this product] in turfgrasses and lawns:

Application of [TURF FERTILIZER WITH BARRICADE 0.29% or this product] may thin emerged annual bluegrass and newly overseeded grasses.

Do not apply to overseeded turf within 60 days after seeding or until after the second mowing, whichever is longer. Injury to desirable seedlings is likely if [TURF FERTILIZER WITH BARRICADE 0.29% or this product] is applied before seedling secondary roots are in the second inch of soil, not thatch plus soil.

Do not apply to newly set sod until the following year.

Application of [TURF FERTILIZER WITH BARRICADE 0.29% or this product] to turf stressed by drought, low fertility, or pest damage may result in turf injury.]

[Disturbing the herbicide barrier with cultural practices such as disking may result in reduced weed control.]

RATES OF APPLICATION [Application Rates]

[TURF FERTILIZER WITH BARRICADE 0.29% or This product] may be applied as a single application or in sequential applications to control weeds germinating throughout the year. All applications must be made prior to germination of the target weeds. [TURF FERTILIZER WITH BARRICADE 0.29% or this product] will not control established weeds.

Maximum use rate selection is based on turf species. The length of time of residual weed control provided by [TURF FERTILIZER WITH BARRICADE 0.29% or this product] is related to the rate applied.

MAXIMUM ANNUAL RATES

[TURF FERTILIZER WITH BARRICADE 0.29% or This product] is suggested for use on the turfgrass species listed in the following table. Do not exceed the maximum yearly rate as given in the following table:

MAXIMUM APPLICATION RATE/CALENDAR YEAR of TURF FERTILIZER WITH BARRICADE 0.29% by Turfgrass Species¹⁾

Turf Species:	Lbs. Product/Acre	Lbs. Product/1,000 Sq. Ft.	Lbs. AI/Acre
Bermudagrass ²⁾ , Bahiagrass, Centipede grass, Seashore Paspalum, St. Augustine grass, Tall Fescue (including turf-type), Zoysia	518	11.9	1.5
Buffalograss, Kentucky Bluegrass, Perennial Ryegrass	345	7.9	1.0
Creeping Red Fescue	260	6.0	.75
Creeping Bentgrass	225	5.2	.65

¹⁾ These are the maximum rates per calendar year by species limitations.

²⁾ May be used on newly sprigged or plugged Bermudagrass at rates not to exceed 179 lbs./Acre [4.1 Lbs/1000 Sq.Ft.]. Newly sprigged or plugged Bermudagrass stolon rooting may be temporarily retarded. Suppression only of Foxtail, Goosegrass and Rescuegrass due to reduced product rates used in sprigging situations.

• Do not apply more than 518 lbs/Acre [11.9 Lbs/1000 Sq.Ft.] of [TURF FERTILIZER WITH BARRICADE 0.29% or this product] per calendar year.

[• Use higher rates of [TURF FERTILIZER WITH BARRICADE 0.29% or this product] to achieve higher levels of fertility and longer periods of weed control for each turf type, but do not exceed the maximum application rates specified in the **Maximum Annual Rates Table.**]

WEEDS CONTROLLED

When used in accordance with this label [TURF FERTILIZER WITH BARRICADE 0.29% or this product] will provide control of the following weeds:

Barnyardgrass	Crabgrass (large, smooth)	Junglerice	Purslane, Common	Spurge, Prostrate
Bluegrass, Annual (<i>Poa annua</i>)	Crowfootgrass	Knotweed	Pusley, Florida	Witchgrass
Carpetweed	Cupgrass, Woolly	Kochia	Rescuegrass ³⁾	Woodsorrel, Yellow
Chickweed, Common	Foxtails, Annual	Lambsquarter, Common	Shepherd's Purse ²⁾	(from seed)
Chickweed, Mouseear (from seed)	Goosegrass ¹⁾	Lovegrass	Signalgrass, Broadleaf	
	Henbit	Panicum (Texas, Fall, Browntop)	Speedwell, Persian	
	Itchgrass	Pigweed	Sprangletop	
	Johnsongrass (from seed)			

¹⁾ In many areas a single application of 225 to 518 lbs. /Acre [5.2 to 11.9 Lbs/1000 Sq.Ft.] of [TURF FERTILIZER WITH BARRICADE 0.29% or this product] will control goosegrass. However, under heavy goosegrass pressure and/or an extended growing season, most effective weed control may be obtained by making an initial application of 225 to 345 lbs. /Acre [5.2 to 7.9 Lbs/1000 Sq.Ft.] followed after 60 to 90 days by a second application at doses that would not exceed those given in the **Maximum**

Annual Rate Table. Do not exceed the maximum rate for turfgrass species listed in the **Maximum Annual Rate Table** above.

- ² For this weed, apply this product in late summer, fall or winter prior to germination.
- ³ Suppression only.

Sequential applications may be made so long as the total amount of product applied does not exceed the maximum annual application rates specified for each turf species. All applications must be made prior to germination of the weed seeds.

WHEN TO APPLY AFTER OVERSEEDING TURF

Do not apply to overseeded turf within 60 days after seeding or until after the second mowing, whichever is longer. Injury to desirable seedlings is likely if [TURF FERTILIZER WITH BARRICADE 0.29% or this product] is applied before seedling secondary roots are in the second inch of soil, not thatch plus soil.

WHEN TO OVERSEED AFTER APPLICATION

[TURF FERTILIZER WITH BARRICADE 0.29% or This product] will inhibit the germination of turf species if overseeded too soon after application. Follow rates and intervals in the table below for best overseeding/reseeding results.

TURF FERTILIZER WITH BARRICADE 0.29% Rate (lb./A)		Months Before Overseeding		
Product	AI	North	Transition	South
172	.50	4	4	4
225	.65	5	4	4
260	.75	6	5	5
275	.80	-	6	6
345	1.00	-	7	7
393	1.14	-	-	9
448	1.30	-	-	10
518	1.50	-	-	12

[OPTIONAL LANDSCAPE ORNAMENTAL SECTION]

LANDSCAPE ORNAMENTALS

(including Established Perennials and Wildflower Plantings)

[TURF FERTILIZER WITH BARRICADE 0.29% or This product] may be applied for residual preemergence weed control in ornamentals.

USE RATES

Apply [TURF FERTILIZER WITH BARRICADE 0.29% or this product] at 225 to 518 lbs. /Acre [5.2 to 11.9 lbs/1000 sq.ft.] in fall and/or spring. Use higher rates of application for longer control periods. Sequential applications may be made so long as the total amount of product applied does not exceed the maximum annual application rate of 518 lbs./Acre [11.9 lbs/1000 sq.ft.]

APPLICATION TIMING AND INFORMATION

[TURF FERTILIZER WITH BARRICADE 0.29% or this product] is a preemergence herbicide and will not control emerged weeds. Most effective weed control in ornamentals will be obtained when [TURF FERTILIZER WITH BARRICADE 0.29% or this product] is activated by at least 0.5 inch of rainfall or irrigation, or with shallow (1 to 2 inches) mechanical incorporation, prior to weed seed germination and within 14 days following application.

Best weed control is obtained when [TURF FERTILIZER WITH BARRICADE 0.29% or This product] is applied to soil free of clods, weeds, and debris such as leaves. Prior to application of [TURF FERTILIZER WITH BARRICADE 0.29% or this product], control existing vegetation by hand weeding, cultivation or the use of an appropriate postemergence herbicide.

ESTABLISHED LANDSCAPE ORNAMENTALS

[TURF FERTILIZER WITH BARRICADE 0.29% or This product] may be applied at any time to established ornamentals as a broadcast, over the top or directed application. Irrigation or rainfall soon after application will wash residues off plant foliage and activate [TURF FERTILIZER WITH BARRICADE 0.29% or this product] in the soil.

NEWLY TRANSPLANTED LANDSCAPE ORNAMENTALS

[TURF FERTILIZER WITH BARRICADE 0.29% or This product] may be applied to newly transplanted ornamentals as a broadcast, over the top or directed application. Delay application to allow soil to settle around new transplants and water thoroughly before applying [TURF FERTILIZER WITH BARRICADE 0.29% or this product]. Apply [TURF FERTILIZER WITH BARRICADE 0.29% or this product] after cuttings form roots and become established. Apply before budding/grafting or after buds/grafts have taken to avoid any inhibition of the tissue union.

TOLERANT ORNAMENTAL SPECIES

[TURF FERTILIZER WITH BARRICADE 0.29% or This product] will not harm most trees, shrubs, vines and flowers. The species listed below are tolerant to [TURF FERTILIZER WITH BARRICADE 0.29% or this product]. Best results will be obtained when [TURF FERTILIZER WITH BARRICADE 0.29% or this product] is uniformly applied to the soil surface; avoid applying to ornamental shoots which may defeat the effort to get uniform distribution on the soil surface. [TURF FERTILIZER WITH BARRICADE 0.29% or this product] may be applied over the top of these species.

When plants are under stress (such as heat, drought, or frost damage) some cultivars of listed plants may be sensitive to [TURF FERTILIZER WITH BARRICADE 0.29% or this product].

[List of Weeds]

Scientific Name	Common Name
<i>Abies</i> spp.	Fir species** (Balsam, Fraser, Noble, etc.)
<i>Abelia grandiflora</i>	Abelia: Sherwood
<i>Acer palmatum</i>	Japanese Maple
<i>A. platanoides</i>	Norway Maple
<i>Achillea</i> sp.	Yarrow: King Edwaqrd
<i>Actinidia chinensis</i>	Kiwi*
<i>Agapanthus africanus</i>	Lily-of-the-Nile (African Lily)
<i>Agapanthus orientalis</i>	
<i>Akebia quintata</i>	Five-Leaf or Chocolate Vine
<i>Allium cernuum</i>	Lady's Leek, Nodding Onion
<i>Anemone hybrida</i>	Japanese Anemone
<i>Aquilegia</i> sp.	Aquilegia: Red and Gold
<i>Arctostaphylos densiflora</i>	Vine Hill Manzanita
<i>Arctotheca calendula</i>	Cape Weed
<i>Artemesia</i> sp.	Wormwood; Silver Mound, Castle
<i>Aster</i> sp.	Aster: Bonny Blue, Purple Dome
<i>Aster X Frikartii</i>	

<i>Athrium Filiz-femina</i>	Lady Fern; Fern Lady
<i>Aucuba japonica</i>	Japanese Aucuba
<i>Begonia sp.</i>	Fibrous Begonia: Hardy Grandis
<i>Berberis gladwynensis</i>	Barberry
<i>B. Julianae</i>	Wintergreen Barberry
<i>B. mentorensis</i>	Mentor Barberry
<i>B. Thunbergii</i>	Japanese Barberry
<i>B. verruculosa</i>	Warty Barberry
<i>Bergenia cordifolia</i>	
<i>Boltonia asteroides</i>	Snowbank
<i>Buddleia davidii</i>	Butterfly-Bush (Dwarf Blue); Royal Red
<i>Buxus microphylla</i>	Japanese Boxwood
<i>Callistemon viminalis</i>	Weeping Bottlebrush
<i>Calluna vulgaris</i>	Scotch Heather
<i>Campanula carpatica</i>	Tussock Bellflower, (White Clips)
<i>Campis X Tagliabuana</i>	Trumpet Creeper, Trumpet Flower, Madame Galen
<i>Carpobrotus edulis</i>	Hottentot Fig (Ice Plant)
<i>Cassia artemisoides</i>	Feathery Cassia
<i>Ceanothus rigidus</i>	Wild Lilac
<i>Ceratostigma plumbagonoides</i>	
<i>Chamaecyparis pisifera</i>	False Cypress
<i>Chrysanthemum nipponicum</i>	
<i>Cleyera japonica</i>	Cleyera
<i>Citrus spp.</i>	Citrus species*
<i>Coreopsis sp.</i>	Coreopsis (Calliopsis): Early Sunrise, Moonbeam
<i>Cornus florida</i>	Flowering Dogwood
<i>C. stolonifera</i>	American Dogwood
<i>Cortaderia selloana</i>	Pampas Grass
<i>Cotoneaster apiculatus</i>	Cranberry Cotoneaster
<i>C. buxifolius</i>	Cotoneaster
<i>C. Dammeri</i>	Bearberry Cotoneaster
<i>C. microphyllus</i>	Rockspray Cotoneaster
<i>Cretaegus spp.</i>	Hawthorne
<i>Crocsmia sp.</i>	Lucifer
<i>Cupressus sempervirens</i>	Italian Cypress
<i>Delosperma alba</i>	White Trailing Ice Plant
<i>Delosperma sp.</i>	Cooperi Pink
<i>Delphinium sp.</i>	Larkspur: Blue Elf
<i>Dianthus deltoides</i>	Dianthus: Maiden Pinks "Zing"
<i>D. gratianopolitanus</i>	Cheddar Pink
<i>Dodonea viscosa</i>	Hop Bush
<i>Echinacea pupurea</i>	Coneflower, Purple; Magnu
<i>Elaeagnus pungens</i>	Silverberry
<i>Euonymus Fortunei</i>	Wintercreeper
<i>E. japonica</i>	Japanese Spindle Tree (Evergreen Euonymus)
<i>E. kiautschovica</i>	Spreading Euonymus
<i>Fatsia japonica</i>	Japanese Aralia

<i>Forsythia intermedia</i>	Border Forsythia
<i>Forsythia suspensa</i>	Weeping Forsythia
<i>F. viridissima</i>	Greenstem Forsythia
<i>Gaillardia sp.</i>	Gaillardia, Blanket Flower: "Goblin"
<i>Gardenia jasminoides</i>	Gardenia, Cape-Jasmine, Radicans
<i>Gaura sp.</i>	
<i>Gentiana dahurica</i>	Gentian
<i>Geranium cinereum</i>	Cranesbill
<i>Gladiolus spp.</i>	Gladiolus species**
<i>Gypsophila repens</i>	Baby's Breath
<i>Hedera helix</i>	English Ivy
<i>Hellanthemum sp.</i>	Sunrose
<i>Hemerocallis sp.</i>	Daylily: Aztec Gold, Stella De Oro, Tender Love
<i>Hibiscus</i>	Rose of Sharon
<i>Hibiscus sp.</i>	Mallow: Disco Belle White
<i>Hibiscus Rosa-sinensis</i>	Chinese Hibiscus
<i>Hosta plantaginea</i>	Host, Plantain Lily (Fragrant)
<i>H. Sieboldiana</i>	Hosta, "Searsucker"
<i>Houttuynia cordata var. variegata</i>	
<i>Hydrangea macrophylla</i>	Bigleaf Hydrangea
<i>Ilex Bernyi</i>	Holly
<i>Ilex cornuta</i>	Chinese Holly
<i>I. crenata</i>	Japanese Holly; Helleri
<i>I. opaca</i>	American Holly
<i>I. vomitoria</i>	Yaupon Holly; Schillings
<i>Inula ensifolia</i>	
<i>Iris ensata</i>	Sword-Leaved Iris; Jodlesong
<i>Iris siberica</i>	Siberian Iris; Cabernet
<i>Iris spp.</i>	Iris species**
<i>Jasminium nudiflorum</i>	Winter Jasmine
<i>Juniperus chinensis</i>	Chinese Juniper; Nick's Compact, Parsonii
<i>J. conferta</i>	Shore Juniper; Blue Pacific
<i>J. davurica</i>	Parsoni
<i>J. horizontalis</i>	Creeping Juniper
<i>Juglans sp.</i>	Walnut*
<i>Justicia brandegeana</i>	Shrimp Plant
<i>Lagerstromia indica</i>	Crape Myrtle
<i>Lagerstomia indica X Fauriei</i>	Crape Myrtle; Tuscarora
<i>Lantana montevidensis</i>	Weeping Lantana
<i>Lavender sp.</i>	Lavender; Munstead
<i>Leontopodium alpinum</i>	Edelweiss
<i>Ligustrum sinense</i>	Chinese Privet; Variegata
<i>Ligustrum amurense</i>	Amur Privet
<i>L. japonicum</i>	Japanese Privet
<i>L. lucidum</i>	Glossy Privet (Waxleaf)
<i>Lillium sp.</i>	Lily; Jazz
<i>Liriope Muscari</i>	Big Blue Lily; Turf; Silver Mound; Evergree Giant

<i>Liriope Muscari var. variegata</i>	Liriope, Variegated
<i>Liriope spicata</i>	Liriope, Creeping
<i>Lobelia Cardinalis</i>	Cardinal Flower, Indian Pink
<i>Lonicera japonica</i>	Japanese Honeysuckle
<i>L. tatarica</i>	Tatarian Honeysuckle
<i>Loropetalum chinense</i>	Burgundy
<i>Lythrum sp.</i>	Loosestrife; Modern Pink
<i>Magnolia spp.</i>	Magnolia species**
<i>Maleophora luteola</i>	Ice Plant
<i>Malus sp.</i>	Crabapple*
<i>Miscanthus sinensis</i>	Yaku Jima, Silberfeder
<i>Nandina domestica</i>	Heavenly Bamboo
<i>Narcissus spp.</i>	Narcissus species**
<i>Nerium oleander</i>	Oleander
<i>Olea europaea</i>	Olive*
<i>Ophiopogon japonicus</i>	Mondo Grass
<i>Osmanthus heterophyllus</i>	Osmanthus (False Holly): Gulf Tide
<i>Osteospermum fruticosum</i>	Trailing African Daisy
<i>Oxydendrum arboreum</i>	Sourwood
<i>Paeonia suffruticosa</i>	Tree Peony
<i>Pennisetum setaceum</i>	Fountain Grass (Dwarf)
<i>Perovskia atriplicifolia</i>	
<i>Persea americana</i>	Avocado*
<i>Photinia Fraseri</i>	Fraser's Photinia (Redtip)
<i>Physotegia Virginiana</i>	Dragonhead, False; Vivid
<i>Picea spp.</i>	Spruce species** (Colorado Blue, Norway, etc.)
<i>Pieris japonica</i>	Lily-of-the-Valley Bush
<i>Pinus brutia</i>	Calabrian Pine
<i>P. canariensis</i>	Canary Island Pine
<i>P. elliotii</i>	Slash Pine
<i>P. halepensis</i>	Aleppo Pine
<i>P. nigra</i>	Austrian Pine
<i>P. palustris</i>	Longleaf Pine
<i>P. radiata</i>	Monterey Pine
<i>P. Thunbergiana</i>	Japanese Black Pine
<i>P. strobus</i>	Eastern White Pine
<i>P. syvestris</i>	Scotch Pine
<i>P. taeda</i>	Loblolly Pne
<i>P. virginiana</i>	Virginia Pine
<i>Pistachio sp.</i>	Pistachio*
<i>Pittosporum rhombifolium</i>	Queensland Pittosporum
<i>P. tobira</i>	Japanese Pittosporum
<i>Podocarpus macrophyllus</i>	Japanese Yew
<i>Prunus Laurocerasus</i>	English Laurel
<i>Prunus sp.</i>	Almond, Apricot, Nectarine, Peach, Plum and Prune*
<i>Pseudotsuga Menziesii</i>	Douglas Fir**
<i>Pyracantha coccinea</i>	Firethorn (Scarlet)

<i>P. Fortuneana</i>	Firethorn
<i>P. Koidzumii</i>	Firethorn
<i>Pyrus sp.</i>	Bradford Pear sp.
<i>Quercus Shumardii</i>	Oak, Shumard's Red
<i>Quercus spp.</i>	Oak species
<i>Raphiolepis indica</i>	Indian Hawthorne
<i>Raphiolepis umbellata</i>	Yedda Hawthorne
<i>Rhododendron (including Azalea)</i>	'Coral Bells', Delaware Valley White', 'Flame Creeper', 'Formosa', 'Girard Crimson', 'George L. Tabor', 'Hino-crimson', 'PJM', 'Roseum Elegans', 'Wakeiebisu', 'White Gumbo'
<i>Rosa Banksiae</i>	Lady Bank's Rose
<i>Rosmarinus officinalis</i>	Rosemary*
<i>Rudbeckia sp.</i>	Black-eyed Susan; Goldstrum
<i>Santolina virens</i>	Santolina
<i>Saxifraga sp.</i>	Saxufragel Oyroke Dine
<i>Scabiosa sp.</i>	Pincushion Flower
<i>Sedum album</i>	Stonecrop
<i>Sedum cauticola</i>	Stonecrop; Lidakense
<i>Sedum dasyphyllum</i>	Stonecrop
<i>Sedum spurium</i>	Stonecrop; Dragon's Blood
<i>Spiraea Bumalda</i>	Spirea: Anthony Waterer
<i>Syzygium paniculatum</i>	Australian Brushcherry
<i>Taxus cuspidata</i>	Japanese Yew
<i>T. media</i>	Yew
<i>Teucrium sp.</i>	Germander
<i>Thalictrum dipterocarpum</i>	Meadow Rue
<i>Thuja occidentalis</i>	American Arborvitae
<i>Trachelospermum asiaticum</i>	Star Jasmine
<i>Tsuga canadensis</i>	Canada Hemlock
<i>Tulipa spp.</i>	Tulip species
<i>Veronic sp.</i>	Veronica, Speedwell; Sunny Border
<i>Viburnum japonicum</i>	Japanese Viburnum
<i>V. odoratissimum</i>	Sweet Viburnum
<i>V. plicatum</i>	Japanese Snowball
<i>V. rigidum</i>	Canary Island Viburnum
<i>V. suspensum</i>	Arrowood Viburnum
<i>V. tinus</i>	Laurustinus
<i>V. trilobium</i>	Cranberry Bush
<i>V. wrightii</i>	Leatherleaf Viburnum
<i>Vinca major</i>	Greater Periwinkle, Vinca
<i>Vinca minor</i>	Common Periwinkle Vinca
<i>Vitis sp.</i>	Grape*
<i>Weigela florida</i>	Old Fashioned Weigela
<i>Yucca aloifolia</i>	Spanish Bayonet, Yucca
<i>Y. filamentosa</i>	Adam's Needle, Yucca

* Do not use on food producing trees, vines or plants.

** Not for use on container grown plants.

STORAGE AND DISPOSAL

Do not contaminate water, food or feed by storage and disposal.

Pesticide Storage: Store product in its original container in a cool, dry, locked place out of the reach of children and animals.

Pesticide Disposal and Container Handling: Nonrefillable container. Do not reuse or refill this container. **If empty:** Place in trash or offer for recycling if available. **If partly filled:** Call your local solid waste agency for disposal instructions. Never place unused product down any indoor or outdoor drain.

WARRANTY

IMPORTANT: READ BEFORE USE

Read the entire Directions for Use, Conditions, Disclaimer of Warranties and Limitations of Liability before using this product. If terms are not acceptable, return the unopened product container at once.

By using this product, user or buyer accepts the following Conditions, Disclaimer of Warranties and Limitations of Liability.

CONDITIONS: The directions for use of this product are believed to be adequate and must be followed carefully. However, it is impossible to eliminate all risks associated with the use of this product. Crop injury, ineffectiveness or other unintended consequences may result because of such factors as weather conditions, presence of other materials, or the manner of use or application, all of which are beyond the control of [Lebanon Seaboard Corporation] [Company name]. All such risks shall be assumed by the user or buyer.

DISCLAIMER OF WARRANTIES: To the extent consistent with applicable law, [LEBANON SEABOARD CORPORATION] [Company name] MAKES NO OTHER WARRANTIES, EXPRESS OR IMPLIED, OF MERCHANTABILITY OR OF FITNESS FOR A PARTICULAR PURPOSE OR OTHERWISE, THAT EXTEND BEYOND THE STATEMENTS MADE ON THIS LABEL. No agent of [Lebanon Seaboard Corporation] [Company name] is authorized to make any warranties beyond those contained herein or to modify the warranties contained herein. To the extent consistent with applicable law, [Lebanon Seaboard Corporation] [Company name] DISCLAIMS ANY LIABILITY WHATSOEVER FOR SPECIAL, INCIDENTAL OR CONSEQUENTIAL DAMAGES RESULTING FROM THE USE OR HANDLING OF THIS PRODUCT.

LIMITATIONS OF LIABILITY: To the extent consistent with applicable law, THE EXCLUSIVE REMEDY OF THE USER OR BUYER FOR ANY AND ALL LOSSES, INJURIES OR DAMAGES RESULTING FROM THE USE OR HANDLING OF THIS PRODUCT, WHETHER IN CONTRACT, WARRANTY, TORT, NEGLIGENCE, STRICT LIABILITY OR OTHERWISE, SHALL NOT EXCEED THE PURCHASE PRICE PAID, OR AT [LEBANON SEABOARD CORPORATION'S] [Company's name] ELECTION, THE REPLACEMENT OF PRODUCT.

[Optional Label Claims]

Claims – General

- [Bar code] [product number]
- [Item number]
- [Not] Proof of Purchase
- If the fertilizer guarantee contains iron, the following statement must appear:
 [Note:] [Notice:] This product contains the secondary nutrient iron. Iron may stain concrete surfaces and should not be applied on dry or water dampened concrete and should be removed from these areas promptly after application by sweeping or blowing. Do not wash off with water.
- The following statement must appear (relevant to the fertilizer guarantee):
 [Note:] Information regarding the contents and levels of metals in this product is available on the internet at <http://www.regulatory-info-lebsea.com>.
- The following statement may appear when the application rate applies less than 1 pound of nitrogen per 1,000 sq.ft.:
 [Note:] Supplemental applications of lawn fertilizer are needed to achieve a minimum of 1 pound nitrogen per 1,000 sq.ft.
- The following statement may appear if application rate instructions specify different rates based on different regions in Florida:
 [Optional fertilizer text for state of Florida when applicable:] Florida Applications: [X] annual feedings [with the exception of [listed turfgrass species (X feedings in the north and X feedings in the central and south).] This package applies X.X lbs of product per 1,000 sq.ft.]
- For products sold in the state of Florida, the following statement may appear:
 [Optional text for state of Florida] Do not apply near water, storm drains or drainage ditches. Do not apply if heavy rain is expected. Apply this product only to your lawn/garden, and sweep any product that lands on the driveway, sidewalk, or street, back onto your lawn/garden.
- Apply once for the whole season
- For use on cool and warm season turfgrass
- Questions or Comments? Call 1-xxx-xxx-xxxx. (insert phone graphic)
- This Bag Treats Up to _____ Square Feet

Claims regarding Weed Control Properties

- [12] [16] [20] Week weed control
- [12] [16] [20] week weed grass control
- [3] [4] [5] Month weed control
- [3] [4] [5] month weed grass control
- 3 – 5 month Weed Grass Control

- Contains Barricade®
- Controls new weeds for [12] [16] [20] weeks
- Controls new weeds for [3] [4] [5] months
- Prevents crabgrass all season
- Prevents crabgrass and [many] other weed grasses.
- Prevents crabgrass and other grassy weeds
- Stops [crabgrass] [annual bluegrass] [chickweed] [henbit] (select any listed weed)
- Stops crabgrass before it starts!
- Weed Images [Crabgrass] (select any listed weed)

Claims regarding Combination Weed Control and Fertilizer Properties

- Prevents weeds and feeds your lawn [turf] for [up to] [12] [16] [20] weeks
- Prevents weeds and feeds your lawn [turf] for [up to] [3] [4] [5] months
- Stops weeds and feeds your lawn [turf] for [up to] [12] [16] [20] weeks
- Stops weeds and feeds your lawn [turf] for [up to] [3] [4] [5] months

Claims regarding Fertilizer Properties

- [TURF Fertilizer with Barricade 0.29%] – All the fertilizer nutrients your lawn [turf] needs for spring
- [TURF Fertilizer with Barricade 0.29%] – Providing the Nutrients Needed for Beautiful Lawn [and Ornamentals.]
- Builds strong, deep roots, for a thick, green lawn [turf]
- Fertilizes to provide rich color [and vigorous growth]
- Improves soil fertility
- Larger Roots / Greener Lawn
- No phosphate [helps protect our waterways] (for use when fertilizer analysis has “0” phosphate)
- Promotes rapid root growth
- Promotes root growth for a thicker, greener lawn [turf]
- Protects & [and] strengthens for a better spring lawn [turf]
- Provides your soil with nutrients
- Restores nutrients to your soil
- Restores nutrients to your soil for a quick spring green up [green-up]
- Zero phosphate [helps protect our waterways] (for use when fertilizer analysis has “0” phosphate)

Claims regarding Slow Release Fertilizer Properties

- [TURF Fertilizer with Barricade 0.29% or This product] feeds and greens with [slow release] fertilizer [for up to 3 months] [for up to 12 weeks].
- Feeds [greens] [strengthens] [thickens] your lawn for up to 3 months [12 weeks]

- Feeds your lawn [turf] up to 12 weeks
- Greens up to 3 months [12 weeks]
- MESA® is a registered trademark of Lebanon Seaboard Corporation.
- Patented, controlled release nitrogen for continuous feeding
- Quick and continuous greening for up to 3 months [12 weeks]

XX	XX	XX
Nitrogen (N)	Phosphorous (P)	Potassium (K)
Contains Timed-Release Nitrogen for growing a thick green lawn [Stimulates growth and encourages a thick green lawn]	Improves Root [Improves root growth and Plant Storage Capacity]	Improves Plant Hardiness & Drought Resistance

Claims regarding GreenSmart™ Fertilizer Properties

- GreenSmart™ Enhanced Efficiency Fertilizer for a Green Lawn
- [contains] [with] GreenSmart™
- GreenSmart™
- GreenSmart™ logos

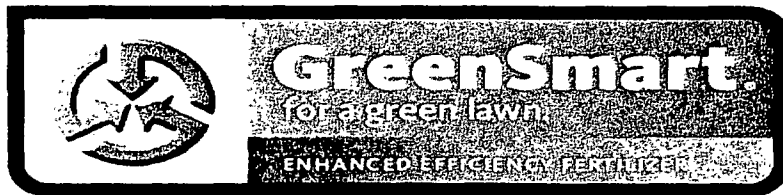

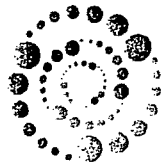

GreenSmart

FOR A GREEN LAWN

ENHANCED EFFICIENCY FERTILIZER



GREEN SMART

FOR A GREEN LAWN

ENHANCED EFFICIENCY FERTILIZER





- GreenSmart™ is a trademark of Lebanon Seaboard Corporation
- 20% less nutrients required for the same great lawn [turf] results [with GreenSmart™ Enhanced Efficiency Fertilizer]
- Enables lawns [turf] to use nutrients more efficiently
- Enhanced Efficiency Fertilizer
- Enhances nutrient absorption
- Enriches soil to promote a vibrant, hardy lawn [turf]
- GreenSmart™ enhances poor soil, creating an environment in which lawns [turf] can thrive. GreenSmart produces thick, green lawns [turf].
- GreenSmart™ nourished lawns [turf] are more robust because their root systems are larger, deeper and better developed. Vigorous roots mean[s] the lawn [turf] is hardier and better able to tolerate the stress that comes with heat and drought.
- GreenSmart™ produces thick, green lawns [turf]
- Helps lawns [turf] retain water to protect against heat & [and] drought
- Helps unlock nutrients already in the soil
- Improved Nitrogen Efficiency - Reduces Leaching
- [GreenSmart™ Enhanced Efficiency Fertilizer -] Improved nutrient release and absorption into the lawn [turf] allows 20% less nutrients to be applied while still providing [a] quality lawn [turf]
- Improves drought resistance
- Improves lawn's [turf's] ability to absorb water & [and] nutrients

- Increase nutrient up-take in grass [lawns] [turf] up to 20% [with GreenSmart™ Enhanced Efficiency Fertilizer]
- Lawn[s] [turf] [and plants] nourished with [company name's] GreenSmart™ are [is] able to tolerate the stress from heat and drought. GreenSmart produces large, deep, and well developed root systems that can retain water. This enables lawns [turf] [and plants] to withstand stressful conditions.
- Less watering needed
- Less watering needed, drought resistant [lawn] [turf]
- Makes it easier for lawns [turf] to absorb soil nutrients
- N-P-K with GreenSmart™ [Enhanced Efficiency Fertilizer for a Green Lawn]
- Plants [lawns] [turf] use[s] nitrogen more efficiently so you need less
- Poor soil may have fewer of the nutrients needed to promote a vigorous lawn [turf]. GreenSmart™ works by enriching your soil with nutrients. GreenSmart revitalizes the soil, which aids in the development of a larger, deeper and better root system. The enhanced habitat is proven to produce a green, thick, vigorous lawn [turf], and reduces the need for watering.
- Promotes rapid root growth [for a thick green] [lawn] [turf]
- Recharges your soil with nutrients!
- Reduces plant [lawn] [turf] stress related to drought
- Reduces stress on lawns [turf], protects from drought & heat
- Speeds root growth to improve nutrient absorption
- Unlocks the nutrients in soil, enhancing nutrient absorption, so you can grow a thicker, greener lawn [turf] with less water.
- Unlocks the nutrients in your soil

GreenView® Brand of Products Optional Marketing Claims

- [GreenView®] [Company name] guarantees you will be satisfied with the performance of this product when used as directed. If you are not satisfied, return to a[n] [Company name] store with proof of purchase for a replacement product or full refund of the purchase price. Or you can mail proof of purchase to the address listed below for a full refund. [Company name and address]
- [GreenView®] [Company name] guarantees you will be satisfied with the performance of this product when used as directed, or your money back. If not satisfied, describe the nature of your problem and simply send proof of purchase to [Lebanon Seaboard Corporation, 1600 East Cumberland Street, Lebanon, PA 17042] [Company name and address].
- For more information on our complete line of [GreenView®] [Company Name] [Brand Name] Lawn and Garden Products, visit our website at [www.lebsea.com] [www.greenviewfertilizer.com] [www.xyz.com] [Insert product images]
- GreenView® (logo) **GREENVIEW**
- GreenView® is a registered trademark of Lebanon Seaboard Corporation.
- GreenView® yard wide guarantee [green leaf graphic] [GreenView® logo]

Preen® Brand of Products Optional Marketing Claims

- [Company name] guarantees you will be satisfied with the performance of this product when used as directed, or your money back. If not satisfied, describe the nature of your problem, and send with proof of purchase to: [Company name and address]

Preen

- Preen® logo
- Preen® Guarantee
- Preen® is a registered trademark of Lebanon Seaboard Corporation.
- www.preen.com

ACE® Brand of Products Optional Marketing Claims

- ACE® is a registered trademark of ACE Hardware Corp.
- Green Turf® is a registered trademark of [Company Name]
- Made in the USA for ACE Hardware Corp., Oak Brook, Illinois, 60523, USA
- Questions or Comments Call 1-XXX-XXX-XXXX



- Satisfaction Guaranteed ACE® Promise [circle graphic]
- Telephone graphic
- The ACE® Promise. If this ACE product when used for its intended purpose, fails to give you complete satisfaction, return the item to the ACE Hardware store where purchased for free replacement of the same or similar item.

Sta-Green® Brand of Products Optional Marketing Claims

- Computer and phone graphics
- If you use [TURF Fertilizer with Barricade 0.29%] as directed and are not completely satisfied, send proof of purchase from this package and the original cash register receipt to the address below. We will refund the purchase price you paid.
- LOOK! For other quality Sta-Green® lawn & garden products. For more information, visit us on our website at www.sta-green.com [www.xyz.com] or call our Consumer Service [Customer Service] Hotline [Number] at 1-xxx-xxx-xxxx.
- Money Back Guarantee [optional graphic]
- Sta-Green® is a registered trademark of [Company name]



- Sta-Green® logo
- The Sta-Green® Promise
- Your satisfaction guaranteed or your money back!

Private Label Customer Brand of Products Optional Marketing Claims

- [Company name] guarantees you will be satisfied with the performance of this product when used as directed, or your money back. If not satisfied, describe the nature of your problem, and send with proof of purchase to: [Company name and address]
- [Private label] is a registered trademark of [Company name]
- [Private label] logo
- Computer and phone graphics
- If you use [TURF Fertilizer with Barricade 0.29%] as directed and are not completely satisfied, send proof of purchase from this package and the original cash register receipt to the address below. We will refund the purchase price you paid.
- LOOK! For other quality [Private label] lawn & garden products. For more information, visit us on our website at [www.xyz.com] or call our Consumer Service [Customer Service] Hotline [Number] at 1-xxx-xxx-xxxx.
- Money Back Guarantee [optional graphic]
- Your satisfaction guaranteed or your money back!

Spreader Models for Spreader Setting Table:

Drop Spreaders	Application Rate XX lbs./1,000 sq.ft.
Agri-Fab	XX
Agway	
Earthway	
Easy Green	
Ferti-Lome	
Glorion	

Greenview® Spred III	
Greenview® Spred® XP1	
Greenview® Show N Tell	
Jonathan Green	
K-Mart K-Grow	
Lawnrafter 45-0311-3	
Ortho	
Precision	
Red Devil Drop	
Republic Drop	
Scotts AccuGreen® 1000	
Scotts AccuGreen® 2000	
Scotts AccuGreen® 3000	
Scotts Easy Gro	
Scotts PF-1	
Scotts PF-3	
Scotts Precision	
Sears Lawn Crafter	
SpredDevil	
Sta-Green	
Statesman I	
Statesman II	
TrueServe Green Thumb 7300	
Vigoro	

Broadcast Spreaders	Application Rate XX lbs./1,000 sq.ft.
Ace Rotary	XX
Agri-Fab 45-0187	
Agway	
Ames 24-626 Commercial	
Cyclone Model B1-80	
Earthway EV-N-Spred 2600	
Ferti-Lome	
Franks	
Glorion	
Green Line	
Greenview® Jet-Spred II	
Greenview® Jet-Spred III	
Greenview® Jet-Spred SS1	
Jonathan Green	
Lawncrafter	
Ortho 545 EZGro	
Pennington 2050SU	
Precise Fit	
Precision Pro	
Precision	
Precision Pro	
Precision Products	
PrizeLAWN LiL' FOOT (LF-1)	

Red Devil
Republic 545 EZGro
Republic EZ Broadcast 75450
Republic EZ Grow
Republic
Roto-Jet
Scotts Basic
Scotts Deluxe™ EdgeGuard®
Scotts EasyGreen
Scotts EdgeGuard
Scotts SpeedyGreen® 1000™
Scotts SpeedyGreen® 2000™
Scotts SpeedyGreen® 3000™
Scotts Standard
Sears 671-19261
Sears Craftsman 24322 85lb
Sta-Green
Statesman Pull Behind
Stinger Rotary
TrueServe Green Thumb
2000A
Vigoro