



OFFICE OF CHEMICAL SAFETY AND POLLUTION PREVENTION

WASHINGTON, D.C. 20460

November 12, 2025

Lebanon Seaboard Corporation
c/o Fredric (Freddy) Shelley, Authorized Agent
Wagner Regulatory Associates, Inc.
P.O. Box 640
Hockessin, DE 19707

Subject: Label Amendment – State Restriction and Reformat Changes
Registration Review Label Amendment – Incorporating Mitigation Measures
from the Registration Review Interim Decision for Mecoprop-p
Product Name: TURF Fertilizer PLUS Trimec DMB Weed Control
EPA Registration Number: 961-413
Application Date(s): January 30, 2021, November 25, 2024
Case Number/Decision Number: 474724 (Decision 570167), 638838

Dear Freddy Shelley:

The amended label referred to above, submitted in connection with registration under the Federal Insecticide, Fungicide, and Rodenticide Act (FIFRA), as amended, is acceptable. This approval does not affect any conditions that were previously imposed on this registration. You continue to be subject to existing conditions on your registration and any deadlines connected with them.

The Agency, in accordance with FIFRA, as amended, has completed reviewing all the information submitted with your application to support the Registration Review of the above referenced product in connection with the Mecoprop-p Interim Decision. The Agency has concluded that your submission is acceptable.

A stamped copy of your labeling is enclosed for your records. This labeling supersedes all previously accepted labeling. *The next label printing of this product must use this labeling unless subsequent changes have been approved.* You must submit one copy of the final printed labeling before you release the product for shipment with the new labeling. In accordance with 40 CFR 152.130(c), you may distribute or sell this product under the previously approved labeling for 12 months from the date of this letter. After *12 months*, you may only distribute or sell this product if it bears this new revised labeling or subsequently approved labeling. “To distribute or sell” is defined under FIFRA section 2(gg) and its implementing regulation at 40 CFR 152.3.

Should you wish to add/retain a reference to the company's website on your label, then please be aware that the website becomes labeling under FIFRA and is subject to review by the Agency. If the website is false or misleading, the product would be misbranded and unlawful to sell or distribute under FIFRA section 12(a)(1)(E). 40 CFR 156.10(a)(5) lists examples of statements EPA may consider false or misleading. In addition, regardless of whether a website is referenced on your product's label, claims made on the website may not substantially differ from those claims approved through the registration process. Therefore, should the Agency find or if it is brought to our attention that a website contains false or misleading statements or claims substantially differing from the EPA approved registration, the website will be referred to the EPA's Office of Enforcement and Compliance.

Your release for shipment of the product constitutes acceptance of these conditions. If these conditions are not complied with, the registration will be subject to cancellation in accordance with FIFRA section 6.

If you have any questions, please contact Rebecca Lasko at 202-565-2469 or at lasko.rebecca@epa.gov.

Sincerely,

Kable Bo Davis

Kable Bo Davis, Senior Advisor
Office of Pesticide Programs
Registration Division, Immediate Office

Enclosure

{MASTER LABEL}

TURF Fertilizer Plus Trimec® DMB Weed Control

ACTIVE INGREDIENTS:

	WT. BY %
2,4-dichlorophenoxyacetic acid	0.69%
(+)-(R)-2-(4-chloro-2-methylphenoxy) propionic acid.....	0.15%
Dicamba: 3,6-dichlor-2-methoxybenzoic acid	0.06%

OTHER INGREDIENTS: 99.10%

TOTAL: 100.0%

THIS PRODUCT CONTAINS:

13.8 lbs. 2,4-dichlorophenoxyacetic acid equivalent per ton
 3.0 lbs. (+)-(R)-2-(2 methyl-4-chlorophenoxy) propionic acid equivalent per ton
 1.2 lbs. 3,6-dichloro-o-anisic acid equivalent per ton
 Isomer Specific by AOAC Methods.
 Contains the single isomer form of Mecoprop-p.
 TRIMEC is a registered trademark of PBI/GORDON CORPORATION.
 CAS Number 1982-69-0 (sodium salt of dicamba)

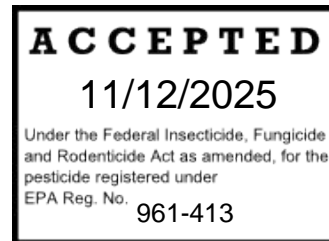

EPA Reg. No. 961-413

(L) (D)
EPA Est. No. 961-PA-01:961-IL-01
 Superscript used is first letter of lot number.

GUARANTEED ANALYSIS

Total Nitrogen (N)	XX%
X.X% Ammoniacal Nitrogen	
X.X% Water Insoluble Nitrogen	
X.X% Urea Nitrogen	
X.X% Other Water Soluble Nitrogen	
Available Phosphate (P2O5)	XX%
Soluble Potash (K2O)	XX%

Nutrient Sources: (Guaranteed Analysis and Nutrient Sources to be supplied based on fertilizer analysis used by manufacturer.)

{The following statement must appear (relevant to the fertilizer guarantee):}

{For products distributed in the State of Washington, the following statement must appear:}

[*Note: Information regarding the contents and levels of metals in this product is available on the internet at <http://www.regulatory-info-lebsea.com>.]

{If the fertilizer guarantee contains iron, the following statement must appear:}

[*Note:][*Notice:] This product contains the secondary nutrient iron. Iron may stain concrete surfaces and should not be applied on dry or water dampened concrete and should be removed from these areas promptly after application by sweeping or blowing. **DO NOT** wash off with water.]

KEEP OUT OF REACH OF CHILDREN CAUTION

Si usted no entiende la etiqueta, busque a alguien para que se la explique a usted en detalle.
 (If you do not understand this label, find someone to explain it to you in detail.)

FIRST AID**IF SWALLOWED:**

- Call a poison control center or doctor immediately for treatment advice.
- Have person sip a glass of water if able to swallow.

	<ul style="list-style-type: none"> • DO NOT induce vomiting unless told to do so by a poison control center or doctor. • DO NOT give anything by mouth to an unconscious person.
IF ON SKIN OR CLOTHING:	<ul style="list-style-type: none"> • Take off contaminated clothing. • Rinse skin immediately with plenty of water for 15 - 20 minutes. • Call a poison control center or doctor for treatment advice.
IF INHALED:	<ul style="list-style-type: none"> • Move person to fresh air. • If person is not breathing, call 911 or and ambulance, then give artificial respiration, preferably mouth-to-mouth if possible. • Call a poison control center or doctor for further treatment advice.
IF IN EYES:	<ul style="list-style-type: none"> • Hold eye open and rinse slowly and gently with water for 15 - 20 minutes. • Remove contact lenses, if present, after the first 5 minutes, then continue rinsing. • Call a poison control center or doctor for treatment advice.
HOTLINE NUMBERS	
Have the product container or label with you when calling a poison control center or doctor or going for treatment. For Emergency Medical Treatment Information call (888)208-1368.	

{Optional referral statements when booklets and container labels are used:}

[See back panel for First Aid and additional Precautionary Statements.]

[See label booklet for [complete] [additional] [First Aid,] [Precautionary Statements], [Directions For Use][,] [and] [Storage and Disposal].]

[MANUFACTURED [FOR] [BY]: [Distributed [For:] [By:] [Produced [By:] [For:]

LEBANON SEABOARD CORPORATION

1600 EAST [E.] CUMBERLAND STREET [St.]

LEBANON, PA 17042

[1-800-233-1067][717-272-1685]

[Made in the USA.]

[Covers] [X,XXX] Square Feet [SQUARE FEET] [SQ. FT.] [Sq. Ft.]

[Net Weight:] [Net Wt.:] [xx] [lbs.] [LBS.] [POUNDS] (xx.xx kg) [(XX.XX KG)]

[Treats: XX,XXX] [Sq. Ft.] [SQ.FT.] [Square Feet] [SQUARE FEET]

[Net Contents:]

PRECAUTIONARY STATEMENTS

HAZARDS TO HUMANS AND DOMESTIC ANIMALS

CAUTION

Harmful if absorbed through skin. Harmful if inhaled. Causes moderate eye irritation. Avoid contact with skin, eyes, or clothing. Avoid breathing dust. Wear long-sleeved shirt, long pants, shoes, socks, chemical resistant gloves made of any waterproof material. Wash thoroughly with soap and water after handling and before eating, drinking, chewing gum, using tobacco or using the toilet.

ENVIRONMENTAL HAZARDS

Drift or runoff may adversely affect nontarget plants. To protect the environment, do not allow pesticide to enter or run off into storm drains, drainage ditches, gutters, or surface waters. Applying this product in calm weather when rain is not predicted for the next 24 hours will help to ensure that wind or rain does not blow or wash pesticide off the treatment area. Sweeping any product that lands on a driveway, sidewalk, or street, back onto the treated area of the lawn or garden will help to prevent run off to water bodies or drainage systems.

This chemical has properties and characteristics associated with chemicals detected in groundwater. The use of this chemical in areas where soils are permeable, particularly where the water table is shallow, may result in groundwater contamination. Application around a cistern or well may result in contamination of drinking water or groundwater.

NON-TARGET ORGANISM ADVISORY: This product is toxic to plants and may adversely impact the forage and habitat of non-target organisms, including pollinators, in area adjacent to the treated site. Protect the forage and habitat of non-target organisms by following label directions intended to minimize spray drift.

DIRECTIONS FOR USE

It is a violation of Federal law to use this product in a manner inconsistent with its labeling.

For Outdoor Residential Use.

Do not allow people or pets to enter the treated area until dusts have settled.

[Optional Heading: **INSTRUCTIONS**] [Use Instructions] [Application Instructions] [Application Directions]

[TURF Fertilizer Plus Trimec DMB Weed Control or this product] contains Trimec® herbicide. Trimec® controls a wide range of lawn weeds, including dandelion, chickweed, plantain, henbit, spurge and many others commonly found in home lawns. In addition, a (X-

X-X analysis of fertilizer grade) fertilizer provides a supply of lawn food. Possible retreatment may be necessary if (a) lawn is heavily overrun by weeds or, (b) if adverse low moisture conditions prevail and weeds are in a state of poor growth. A second application may be made in approximately 30 days. Treated areas may be seeded 3 to 4 weeks after application.

USE RESTRICTIONS

- Do not use on dichondra, carpetgrass, closely mowed bentgrass putting greens or St. Augustinegrass.
- Do not use this product where desirable clovers are present or allow the material to drift onto flowers, vegetables or ornamental shrubbery.
- Do not spread over exposed roots of trees and ornamentals.
- Do not exceed specified dosages for any area; be particularly careful within dripline of tree and other ornamental species.
- Do not contaminate domestic or irrigation waters.
- Do not apply this product in a way that will contact any person or pet, either directly or through drift. Keep people and pets out of the area during application.
- Do not apply directly to or near water, storm drains, gutters, sewers, or drainage ditches.
- Do not apply within 25 feet of rivers, fish ponds, lakes, streams, reservoirs, marshes, estuaries, bays, and oceans.
- Do not apply when windy.
- To prevent product run-off, do not over water the treated area(s) to the point of runoff or apply a when raining or when rain is expected that day.

USE PRECAUTIONS

Apply when the air is calm. Application of this product to newly seeded areas should be delayed until the third mowing.

Apply this product directly to your lawn or garden, and sweep any product landing on the driveway, sidewalk, gutter, or street back onto the treated area.

[Labeling Requirements: Optional headers: [Application Instructions]:

The maximum broadcast application rate is 4.0 pounds of product per 1,000 sq. ft. per application (1.2 lbs. 2,4-D acid equivalent, 0.27 lb. MCPP-p acid equivalent, and 0.11 lb. dicamba acid equivalent per acre per application). The maximum number of broadcast applications is limited to 2 per year with a minimum of 30 days between applications. The maximum seasonal rate is 8.0 pound of product per 1,000 sq. ft. (2.4 lbs. 2,4-D acid equivalent, 0.54 lb. MCPP-p acid equivalent, and 0.22 lb. dicamba acid equivalent per acre.

1. Mow lawn to normal height 1 to 2 days before application.
2. Water lawn thoroughly at least 1 day before application to sustain moisture until the next watering (see step 4).
3. Apply when weeds are young and actively growing, preferably in the morning when the dew is on the grass. If grass is not moist at time of application, sprinkle lightly with water to hold the material and prevent dust drift onto nontarget plants.
4. Do not wash from weed leaves for 1 to 2 days after application. At this time a thorough watering should be made.

[Spreader Chart] [Note to reviewer, rates of application allowed 3.4 lbs., 4.0 lbs., 5.3 lbs. and 8.0 lbs.; not to exceed 8.0 lbs.]

[SPREADER SETTINGS]

SPREADER	[SPEED]		[WIDTH OF COVERAGE (FEET)]	[SETTINGS] [3.4] [4.0] [5.3] [8.0] [LBS./1,000 SQ. FT.]
	[GROUND MPG]	[PTO RPM]		
[Brand name(s) of Spreader]	[X]	[X]	[X]	[X]
These settings were calibrated and field tested. However, age and condition of spreader, speed of operation, and evenness of terrain may require slightly different settings for desired coverage.				
If your spreader is not listed, or if you need a spreader setting, please call customer service at 1-800-233-0628 , Monday through Friday, 8 am. To 5 pm.				

[The following statement may appear when the application rate applies less than 1 pound of nitrogen per 1,000 sq.ft.:

[*Note:] Supplemental applications of lawn fertilizer are needed to achieve a minimum of 1 pound nitrogen per 1,000 sq.ft.]

Apply only to actively growing turf. **DO NOT** exceed [3.2] [XX] lbs. of total nitrogen per 1,000 sq. ft. annually.

[*In Pennsylvania: DO NOT exceed 0.9 lbs. of total nitrogen per 1,000 sq. ft. per application.]

[In **Maryland, New Jersey, New York and Virginia:** This fertilizer contains phosphorus and may not be used for lawn maintenance on turf in the states of Maryland, New Jersey, New York or Virginia except when:

1. Providing nutrients to specific soils and target vegetation as determined to be necessary in accordance with a soil test that was conducted by a laboratory* performed no more than 3 years before the application.
2. Establishing vegetation for the first time, such as after land disturbance, provided the application is conducted in accordance with the recommended application rates established by the State.
3. Re-establishing or repairing a turf area.]

[*In Maryland, the soil testing laboratory must be identified under Section 8-803.7 of the Agriculture Article, Annotated Code of

Maryland.]

[In **New Hampshire**: This fertilizer contains phosphate. In New Hampshire, phosphate fertilizers may only be used for turf maintenance in golf courses, parks, athletic fields, and sod farms.]

[In the state[s] of [list the state or states] apply this product at no more than [xx] lb(s). of product per 1,000 sq. ft.]

{Note to reviewer: Justification for the above statement is that several states have restrictions on the maximum amount of nitrogen that can be applied per application. The fertilizer blend is adjusted to accomplish this.}

[The following statement may appear if application rate instructions specify different rates based on different regions in **Florida**:
[Optional fertilizer text for state of **Florida** when applicable] **Florida** Applications: [X] annual feedings [with the exception of [listed turfgrass species (X feedings in the north and X feedings in the central and south).] This package applies X.X lb(s). of product per 1,000 sq.ft.]

[For products sold in the state of **Florida**, the following statement may appear: [Optional text for state of Florida] We suggest that you follow the Golf Course BMP's at:

<http://www.dep.state.fl.us/water/nonpoint/docs/nonpoint/glfbmp07.pdf6.>]

<https://flgolfbmp.com/>

[For products sold in the state of Florida, the following statement may appear: [Optional text for state of Florida] **DO NOT** apply near water, storm drains or drainage ditches. **DO NOT** apply if heavy rain is expected. Apply this product only to your lawn/garden, and sweep any product that lands on the driveway, sidewalk, or street, back onto your lawn/garden.]

[Optional Heading:] [Spreader Settings]

[Note: Registrant/Subregistrant may insert appropriate spreader setting information based on desired spreaders and specified use rates as listed in this label.]

[See the back of the label for a list of spreaders settings]

Drop Spreaders	Application Rate
	[TURF Fertilizer Plus Trimec DMB Weed Control]
	3.0 lbs./1,000 sq. ft.
Broadcast Spreaders	Application Rate
	[TURF Fertilizer Plus Trimec DMB Weed Control]
	3.0 lbs./1,000 sq. ft.

These settings were calibrated and field tested. However, age and condition of spreader, speed of operation, and evenness of terrain may require slightly different settings for desired coverage.

Optional [Application Equipment and Instructions] [Spreader Directions]:

Determining Your Lawn's Square Footage

To determine how much of this product to apply, you must determine the square footage of your lawn. An easy way to do this is to walk the length of your lawn, figuring that one pace equals about 3 feet. Do the same with the width of the lawn. Then multiply the length by the width to arrive at the total. Make sure you subtract the square footage of your home and driveway when calculating the total square footage of your lawn. If your lawn has an irregular shape, try dividing it up into a number of square areas. Calculate the square footage for each area, then add the figures together to reach your total lawn size.

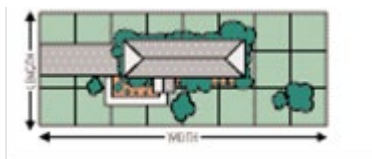

Spreader Tips

The two main types of spreaders are the Drop Spreader, which drops the material straight down the width of the spreader as you push, and the Broadcast Spreader (also known as a rotary), which throws the material from the spreader.

Drop Spreader: First make two passes along the top of the area you'll be covering. Then make two passes along the bottom area. Then move back and forth along the long part of the lawn. On each pass, as you reach the strips at the top and bottom of the area to be covered, shut off the spreader. It's also important to shut off the spreader when you are stopped.

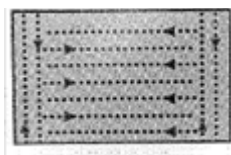

Broadcast Spreader: Apply in a single pass by starting on the outside border and apply in a circular path working toward the center.

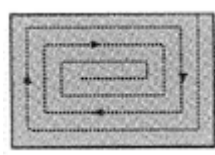

[Optional Spreader Language:]

The above spreader settings are approximate. To check your spreader: XX lb. of material should cover approximately XXX sq. ft. (X lbs. of material per XXXX sq. ft.)

Note: if spreader model does not appear above please call [toll free] XXX-XXX-XXXX, X am - Xpm [ET] [CT] [MT] [PT], [Monday – Friday] [Monday – Sunday] [Anytime] [24/7] for additional model settings.

WEEDS		
Bedstraw	Knotweed	Ragweed
Black medic	Lambsquarters	Sheep sorrel
Buckhorn	Lespedeza	Shepherdspurse
Burdock	Mallow	Speedwell
Chickweed	Morningglory	Spurge
Chicory	Oxalis	Thistle
Clover	Peppergrass	Wild carrot
Dandelion	Pigweed	Wild garlic
Dock	Plantain	Wild lettuce
Ground ivy	Poison ivy	Wild onion
Healall	Poison oak	Yarrow
Henbit	Purslane	

STORAGE AND DISPOSAL

Do not contaminate water, food or feed by storage and disposal.

Pesticide Storage: Store product in its original container in a cool, dry place out of the reach of children and animals.

Pesticide Disposal and Container Handling: Nonrefillable container. Do not reuse or refill this container.

If empty: Place in trash or offer for recycling if available.

If partly filled: Call your local solid waste agency for disposal instructions. Never place unused product down any indoor or outdoor drain.

WARRANTY

IMPORTANT: READ BEFORE USE

Read the entire Directions for Use, Conditions, Disclaimer of Warranties and Limitations of Liability before using this product. If terms are not acceptable, return the unopened product container at once.

By using this product, user or buyer accepts the following Conditions, Disclaimer of Warranties and Limitations of Liability.

CONDITIONS: The directions for use of this product are believed to be adequate and must be followed carefully. However, it is impossible to eliminate all risks associated with the use of this product. Crop injury, ineffectiveness or other unintended consequences may result because of such factors as weather conditions, presence of other materials, or the manner of use or application, all of which are beyond the control of [Lebanon Seaboard Corporation] [Company name]. All such risks shall be assumed by the user or buyer.

DISCLAIMER OF WARRANTIES: To the extent consistent with applicable law, [LEBANON SEABOARD CORPORATION] [COMPANY NAME]

MAKES NO OTHER WARRANTIES, EXPRESS OR IMPLIED, OF MERCHANTABILITY OR OF FITNESS FOR A PARTICULAR PURPOSE OR OTHERWISE, THAT EXTEND BEYOND THE STATEMENTS MADE ON THIS LABEL. No agent of [Lebanon Seaboard Corporation] [Company name] is authorized to make any warranties beyond those contained herein or to modify the warranties contained herein. To the extent consistent with applicable law, [Lebanon Seaboard Corporation] [Company name] DISCLAIMS ANY LIABILITY WHATSOEVER FOR SPECIAL, INCIDENTAL OR CONSEQUENTIAL DAMAGES RESULTING FROM THE USE OR HANDLING OF THIS PRODUCT.

LIMITATIONS OF LIABILITY: To the extent consistent with applicable law, THE EXCLUSIVE REMEDY OF THE USER OR BUYER FOR ANY AND ALL LOSSES, INJURIES OR DAMAGES RESULTING FROM THE USE OR HANDLING OF THIS PRODUCT, WHETHER IN CONTRACT, WARRANTY, TORT, NEGLIGENCE, STRICT LIABILITY OR OTHERWISE, SHALL NOT EXCEED THE PURCHASE PRICE PAID, OR AT [LEBANON SEABOARD CORPORATION'S] [Company's name] ELECTION, THE REPLACEMENT OF PRODUCT.

APPENDIX

Previously Approved Fertilizer Grades:

Fertilizer grades with nutrient contents expressed as the percentages of N,P₂O₅, and K₂O include the following:

10-0-10	18-0-9	20-4-4	22-3-16	24-3-7	26-4-4	30-2-4
10-6-4	18-0-12	20-4-6	22-3-17	24-4-8	26-4-6	30-3-3
10-16-20	18-2-9	20-4-8	22-4-4	24-5-14	26-4-13	30-3-4
10-18-10	18-3-5	20-4-10	22-4-11	25-0-3	26-5-3	30-3-5
12-4-8	18-3-10	20-5-5	22-6-6	25-0-4	26-6-4	30-3-10
12-5-5	18-3-12	20-10-0	22-7-7	25-0-8	27-0-8	30-4-4
12-5-10	18-4-6	20-10-1	22-10-10	25-3-3	27-3-6	30-4-8
13-2-3	18-4-8	20-10-4	23-0-3	25-3-5	27-4-6	31-3-8
13-3-9	18-5-9	20-10-5	23-0-7	25-3-8	28-0-3	31-4-4
15-0-7	18-5-10	21-0-18	23-0-10	25-3-9	28-0-4	32-0-4
15-0-15	18-6-12	21-1-18	23-2-10	25-4-8	28-0-8	32-3-3
15-5-7	18-7-6	21-5-7	23-3-3	25-5-5	28-2-3	32-4-8
15-5-8	18-8-0	21-7-14	23-3-7	26-0-3	28-2-4	
15-5-10	18-8-12	19-0-4	23-4-5	26-0-4	28-2-8	
16-0-5	19-0-2	22-0-4	23-7-7	26-0-11	28-2-12	
16-0-6	19-0-6	22-0-5	24-0-4	26-2-8	28-3-3	
16-0-8	19-3-5	22-0-7	24-0-6	26-2-12	28-3-7	
16-0-9	19-3-6	22-0-8	24-0-12	26-3-3	28-3-8	
16-1-5	19-4-8	22-0-10	24-2-8	26-3-4	29-3-3	
16-2-3	19-6-8	22-0-11	24-2-12	26-3-5	29-3-4	
16-3-5	20-0-0	22-3-3	24-3-3	26-3-6	30-0-3	
16-4-8	20-0-5	22-3-6				
16-6-8	20-0-6	22-3-14				
16-6-9	20-0-7					
17-0-6	20-0-8					
18-0-3	20-0-10					
	20-1-5					
	20-3-3					
	20-3-5					
	20-3-10					
	20-3-12					

The fertilizer grade guaranteed analyses may contain macronutrients and micronutrients. The nutrient contents expressed will vary among states, and the analyses will differ between supplemental registrations. The following is an example of guaranteed analyses presentations.

19-0-4 Guaranteed Analysis	
Total Nitrogen (N)	19%
19% Urea Nitrogen*	

Available Phosphate (P205)	0%
Soluble Potash (K2O)	4%
Derived from: Sulfur Coated Urea, Urea and Muriate of Potash. *3.8% Slowly available nitrogen from sulfur coated urea.	
19-0-4 Guaranteed Analysis	
Total Nitrogen (N)	19%
1.7% Ammoniacal Nitrogen	
1.2% Water Insoluble Nitrogen*	
14.3% Urea Nitrogen	
1.8% Other Water Soluble Nitrogen*	
Available Phosphate (P205)	0%
Soluble Potash (K2O)	4%
Derived from: Methylene ureas, urea and muriate of potash. *3.0% Slowly available nitrogen from methylene ureas.	
22-0-4 Guaranteed Analysis	
Total Nitrogen (N)	22%
22% Urea Nitrogen*	
Available Phosphate (P205)	0%
Soluble Potash (K2O)	4%
Derived from: Sulfur Coated Urea, Urea and Muriate of Potash. *4.4% Slowly available nitrogen from sulfur coated urea.	
22-0-4 Guaranteed Analysis	
Total Nitrogen (N)	22%
2.0% Ammoniacal Nitrogen	
1.2% Water Insoluble Nitrogen*	
16.7% Urea Nitrogen	
2.1% Other Water Soluble Nitrogen*	
Available Phosphate (P205)	0%
Soluble Potash (K2O)	4%
Derived from: Methylene ureas, urea and muriate of potash. *4.1% Slowly available nitrogen from methylene ureas.	
22-0-10 Guaranteed Analysis	
Total Nitrogen (N)	22%
22% Urea Nitrogen*	
Available Phosphate (P205)	0%
Soluble Potash (K2O)	10%
Derived from: Sulfur Coated Urea, Urea and Muriate of Potash. *6.6% Slowly available nitrogen from sulfur coated urea.	

24-4-8 GUARANTEED ANALYSIS	
Total Nitrogen (N).....	24%
Water Insoluble Nitrogen	5%
Available Phosphate (P ₂ O ₅).....	4%
Soluble Potash (K ₂ O).....	8%

Note to Supplemental Registrants: Fertilizer sources may vary in micronutrient composition, and iron may discolor or stain concrete. For fertilizers containing iron: Sweep all fertilizer from concrete surfaces immediately after application. **DO NOT** wash this product from concrete surfaces because fertilizers which contain iron may cause discoloration upon oxidation.

Note to Supplemental Registrants: Guarantees for plant nutrients other than nitrogen, phosphorous, and potassium may be permitted or required by regulation by the [insert state]. The guarantees for such other nutrients shall be expressed in the form of the element. The source (oxides, salts, chelates, etc.) of such other nutrients may be required to be stated and may be included on the label.

{Optional Label Claims}

{Claims}

1. [[Bar code] [product number]]
2. [Item number]
3. [[Not] Proof of Purchase]
4. [If the fertilizer guarantee contains iron, the following statement must appear:]
5. [[Note:] [Notice:] This product contains the secondary nutrient iron. Iron may stain concrete surfaces and should not be applied on dry or water dampened concrete and should be removed from these areas promptly after application by sweeping or blowing. Do not wash off with water.]
6. [The following statement must appear (relevant to the fertilizer guarantee):]
7. [[Note:] Information regarding the contents and levels of metals in this product is available on the internet at <http://www.regulatory-info-lebsea.com>.]
8. [The following statement may appear when the application rate applies less than 1 pound of nitrogen per 1,000 sq. ft.:]
9. [[Note:] Supplemental applications of lawn fertilizer are needed to achieve a minimum of 1 pound nitrogen per 1,000 sq. ft.]
10. [The following statement may appear if application rate instructions specify different rates based on different regions in Florida:]
11. [[Optional fertilizer text for state of Florida when applicable:] Florida Applications: [X] annual feedings [with the exception of [listed turfgrass species (X feedings in the north and X feedings in the central and south).] This package applies X.X lbs of product per 1,000 sq. ft.]]
12. [For products sold in the state of Florida, the following statement may appear:]
13. [[Optional text for state of Florida] Do not apply near water, storm drains or drainage ditches. Do not apply if heavy rain is expected. Apply this product only to your lawn/garden, and sweep any product that lands on the driveway, sidewalk, or street, back onto your lawn/garden.]
14. [Apply once for the whole season]
15. [For use on cool and warm season turfgrass]
16. [Questions or Comments? Call 1-xxx-xxx-xxxx. (insert phone graphic)]
17. [This Bag Treats Up to _____ Square Feet]

[Claims regarding Weed Control Properties]

1. [3 month [12 week] weed grass control]
2. [Controls (Number) weeds! (Listing of weeds may include the following.) (Note: 201 listed weeds)]
3. [Controls [Kills] dandelion, chickweed, knotweed, plantain, henbit, spurge and many other broadleaf weeds[:] [some of which are listed on the back panel]]
4. [Controls [Kills] dandelion, plantain, and other weeds.]
5. [Controls most annual broadleaf weeds]
6. [Controls new weeds for 3 months [12 weeks]]
7. [Kills [Controls] XXX [Plus] [Listed] [Broadleaf] Weeds [As Listed]]
8. [Kills [xxx] [200] weeds including dandelion, clover and other common lawn weeds]
9. [Kills clover, chickweed, spurge and many other broadleaf weeds]

10. [Kills dandelion, chickweed, clover and most common lawn [turf] weeds.]
11. [Kills even the toughest weeds]
12. [Kills over [xxx] [200] of the toughest weeds]
13. [Kills over [xxx] [200] weed types]
14. [Kills weeds now for few weeds in spring]
15. [Kills weeds on contact]
16. [Kills weeds to the root]
17. [Trimec Logo]



18. [Weed images (select any listed weed)]

[Claims regarding Combination Weed Control and Fertilizer]

1. [[TURF Fertilizer Plus Trimec DMB Weed Control] kills unsightly weeds such as dandelion, chickweed and clover while it nourishes your lawn [turf].]
2. [Controls [Kills] over 30 varieties of weeds while feeding your lawn [turf].]
3. [Greens lawns [turf] and develops deep roots while controlling weeds.]
4. [Kills weeds and builds a thick, green [Fall] lawn [turf].]
5. [Kills weeds and feeds your lawn for up to 3 months [12 weeks]]

[Claims regarding Fertilizer Properties]

1. [[TURF Fertilizer Plus Trimec DMB Weed Control] – All the fertilizer nutrients your lawn [turf] needs for spring]
2. [[TURF Fertilizer Plus Trimec DMB Weed Control] –Providing the Nutrients Needed for a Beautiful Lawn.]
3. [Builds strong, deep roots, for a thick, green lawn [turf]]
4. [Fertilizes to provide rich color [and vigorous growth]]
5. [Improves soil fertility]
6. [Larger Roots / Greener Lawn]
7. [No phosphate [helps protect our waterways] (for use when fertilizer analysis has “0” phosphate)]
8. [Promotes rapid root growth]
9. [Promotes root growth for a thicker, greener lawn [turf]]
10. [Protects & [and] strengthens for a better spring lawn [turf]]
11. [Provides your soil with nutrients]
12. [Restores nutrients to your soil]
13. [Restores nutrients to your soil for a quick spring green up [green-up]]
14. [Zero phosphate [helps protect our waterways] (for use when fertilizer analysis has “0” phosphate)]

[Claims regarding Slow Release Fertilizer Properties]

1. [[TURF Fertilizer Plus Trimec DMB Weed Control or This product] feeds and greens with [slow release] fertilizer [for up to 3 months] [for up to 12 weeks].]
2. [Feeds [greens] [strengthens] [thickens] your lawn for up to 3 months [12 weeks]]
3. [Feeds your lawn [turf] up to 12 weeks]
4. [Greens up to 3 months [12 weeks]]
5. [MESA® is a registered trademark of Lebanon Seaboard Corporation.]
6. [Patented, controlled release nitrogen for continuous feeding]
7. [Quick and continuous greening for up to 3 months [12 weeks]]

[XX]	[XX]	[XX]
[Nitrogen (N)]	[Phosphorous (P)]	[Potassium (K)]
[Contains Timed-Release Nitrogen for growing a thick green lawn [Stimulates growth and encourages a thick. green lawn]]	[Improves Root [Improves root growth and Plant Storage Capacity]]	[Improves Plant Hardiness & Drought Resistance]

[Claims regarding GreenSmart™ Fertilizer Properties]

1. [GreenSmart™ Enhanced Efficiency Fertilizer for a Green Lawn]
2. [[contains] [with] GreenSmart™]
3. [GreenSmart™]
4. [GreenSmart™ (logos)]



[]



[]



[]



[]



[]



[]

5. [GreenSmart™ is a trademark of Lebanon Seaboard Corporation]
6. [20% less nutrients required for the same great lawn [turf] results [with GreenSmart™ Enhanced Efficiency Fertilizer]]
7. [Enables lawns [turf] to use nutrients more efficiently]

8. [Enhanced Efficiency Fertilizer]
9. [Enhances nutrient absorption]
10. [Enriches soil to promote a vibrant, hardy lawn [turf]]
11. [GreenSmart™ enhances poor soil, creating an environment in which lawns [turf] can thrive. GreenSmart produces thick, green lawns [turf].]
12. [GreenSmart™ nourished lawns [turf] are more robust because their root systems are larger, deeper and better developed. Vigorous roots mean[s] the lawn [turf] is hardier and better able to tolerate the stress that comes with heat and drought.]
13. [GreenSmart™ produces thick, green lawns [turf]]
14. [Helps lawns [turf] retain water to protect against heat & [and] drought]
15. [Helps unlock nutrients already in the soil]
16. [Improved Nitrogen Efficiency - Reduces Leaching]
17. [[GreenSmart™ Enhanced Efficiency Fertilizer -] Improved nutrient release and absorption into the lawn [turf] allows 20% less nutrients to be applied while still providing [a] quality lawn [turf]]
18. [Improves drought resistance]
19. [Improves lawn's [turf's] ability to absorb water & [and] nutrients]
20. [Increase nutrient up-take in grass [lawns] [turf] up to 20% [with GreenSmart™ Enhanced Efficiency Fertilizer]]
21. [Lawn[s] [turf] [and plants] nourished with [company name's] GreenSmart™ are [is] able to tolerate the stress from heat and drought. GreenSmart produces large, deep, and well developed root systems that can retain water. This enables lawns [turf] [and plants] to withstand stressful conditions.]
22. [Less watering needed]
23. [Less watering needed, drought resistant [lawn] [turf]]
24. [Makes it easier for lawns [turf] to absorb soil nutrients]
25. [N-P-K with GreenSmart™ [Enhanced Efficiency Fertilizer for a Green Lawn]]
26. [Plants [lawns] [turf] use[s] nitrogen more efficiently so you need less]
27. [Poor soil may have fewer of the nutrients needed to promote a vigorous lawn [turf]. GreenSmart™ works by enriching your soil with nutrients. GreenSmart revitalizes the soil, which aids in the development of a larger, deeper and better root system. The enhanced habitat is proven to produce a green, thick, vigorous lawn [turf], and reduces the need for watering.]
28. [Promotes rapid root growth [for a thick green] [lawn] [turf]]
29. [Recharges your soil with nutrients!]
30. [Reduces plant [lawn] [turf] stress related to drought]
31. [Reduces stress on lawns [turf], protects from drought & heat]
32. [Speeds root growth to improve nutrient absorption]
33. [Unlocks the nutrients in soil, enhancing nutrient absorption, so you can grow a thicker, greener lawn [turf] with less water]
34. [Unlocks the nutrients in your soil]

[GreenView® Brand of Products Optional Marketing Claims]

1. [[GreenView®] [Company name] guarantees you will be satisfied with the performance of this product when used as directed. If you are not satisfied, return to a[n] [Company name] store with proof of purchase for a replacement product or full refund of the purchase price. Or you can mail proof of purchase to the address listed below for a full refund. [Company name and address]]
2. [[GreenView®] [Company name] guarantees you will be satisfied with the performance of this product when used as directed, or your money back. If not satisfied, describe the nature of your problem and simply send proof of purchase to [Lebanon Seaboard Corporation, 1600 East Cumberland Street, Lebanon, PA 17042] [Company name and address].]
3. [For more information on our complete line of [GreenView®] [Company Name] [Brand Name] Lawn and Garden Products, visit our website at [www.lebsea.com] [www.greenviewfertilizer.com] [www.xyz.com] [Insert product images]]
4. [GreenView® (logo)]



5. [GreenView® is a registered trademark of Lebanon Seaboard Corporation.]
6. [GreenView® yard wide guarantee [green leaf graphic] [GreenView® logo]]

Preen® Brand of Products Optional Marketing Claims]

1. [[Company name] guarantees you will be satisfied with the performance of this product when used as directed, or your money back. If not satisfied, describe the nature of your problem, and send with proof of purchase to: [Company name and address]]
2. [Preen® logo]



3. [Preen® Guarantee]
4. [Preen® is a registered trademark of Lebanon Seaboard Corporation.]
5. [www.preen.com]

[ACE® Brand of Products Optional Marketing Claims]

1. [ACE® is a registered trademark of ACE Hardware Corp.]
2. [Green Turf® is a registered trademark of [Company Name]]
3. [Made in the USA for ACE Hardware Corp., Oak Brook, Illinois, 60523, USA]
4. [Questions or Comments Call 1-XXX-XXX-XXXX]
5. [Satisfaction Guaranteed ACE® Promise [circle graphic]]



6. [Telephone graphic]
7. [The ACE® Promise. If this ACE product when used for its intended purpose, fails to give you complete satisfaction, return the item to the ACE Hardware store where purchased for free replacement of the same or similar item.]

[Sta-Green® Brand of Products Optional Marketing Claims]

1. [Computer and phone graphics]
2. [If you use [TURF Fertilizer Plus Trimec DMB Weed Control] as directed and are not completely satisfied, send proof of purchase from this package and the original cash register receipt to the address below. We will refund the purchase price you paid.]
3. [LOOK! For other quality Sta-Green® lawn & garden products. For more information, visit us on our website at www.sta-green.com [www.xyz.com] or call our Consumer Service [Customer Service] Hotline [Number] at 1-xxx-xxx-xxxx.]
4. [Money Back Guarantee [optional graphic]]
5. [Sta-Green® is a registered trademark of [Company name]]
6. [Sta-Green® logo]



7. [The Sta-Green® Promise]
8. [Your satisfaction guaranteed or your money back!]

[Private Label Customer Brand of Products Optional Marketing Claims]

1. [[Company name] guarantees you will be satisfied with the performance of this product when used as directed, or your money back. If not satisfied, describe the nature of your problem, and send with proof of purchase to: [Company name and address]
2. [[Private label] is a registered trademark of [Company name]]
3. [[Private label] logo]
4. [Computer and phone graphics]
5. [If you use [TURF Fertilizer Plus Trimec DMB Weed Control] as directed and are not completely satisfied, send proof of purchase from this package and the original cash register receipt to the address below. We will refund the purchase price you paid.]

6. [LOOK! For other quality [Private label] lawn & garden products. For more information, visit us on our website at [www.xyz.com] or call our Consumer Service [Customer Service] Hotline [Number] at 1-xxx-xxx-xxxx.]
7. [Money Back Guarantee [optional graphic]]
8. [Your satisfaction guaranteed or your money back!]

APPENDIX II

List of Weeds controlled by [TURF Fertilizer Plus Trimec DMB Weed Control]

Controls (Number) weeds! (Listing of weeds may include the following.)

[TURF Fertilizer Plus Trimec DMB Weed Control][Kills][200][more than 200] weeds! (List of weeds may include the following): - WEEDS -			
Annual yellow sweetclover	Cockle	Mustard	Spiny cocklebur
Aster	Cocklebur	Narrowleaf plantain	Spiny sowthistle
Austrian fieldcress	Common mullein	Narrowleaf vetch	Spotted catsear
Bedstraw	Creeping Charlie	Nettle	Spotted spurge
Beggarticks	Creeping jenny	Orange hawkweed	Spurweed
Betony, Florida	Cudweed	Oriental cocklebur	Stinging nettle
Bindweed, field	Curly dock	Oxalis	Strawberry, India mock
Bird vetch	Daisy, English	Parsley-piert	Tall nettle
Bitter wintercress	Daisy fleabane	Parsnip	Tall vervain
Bittercress, hairy	Daisy, oxeye	Pearlwort	Tansy ragwort
Bitterweed	Dandelion	Pennycress	Tansy mustard
Black-eyed Susan	Dichondra	Pepperweed	Tanweed
Black medic	Dogfennel	Pigweed	Thistle
Black mustard	Dollarweed	Pineywoods bedstraw	Trailing crownvetch
Blackseed plantain	False dandelion	Plains coreopsis	Tumble mustard
Blessed thistle	Falseflax	Plantain	Tumble pigweed
Bloodflower milkweed	False sunflower	Poison ivy	Velvetleaf
Blue lettuce	Fiddleneck	Poison oak	Venice mallow
Blue vervain	Florida pusley	Pokeweed	Virginia buttonweed
Bracted plantain	Frenchweed	Poorjoe	Virginia creeper
Bristly oxtongue	Galinsoga	Prairie sunflower	Virginia pepperweed
Broadleaf dock	Goldenrod	Prickly lettuce	Wavyleaf bullthistle
Broadleaf plantain	Ground ivy	Prickly sida	Western clematis
Broomweed	Gumweed	Prostrate knotweed	Western salsify
Buckhorn	Hairy fleabane	Prostrate pigweed	White mustard
Buckhorn plantain	Hawkweed	Prostrate spurge	Wild aster
Bulbous buttercup	Healall	Prostrate vervain	Wild buckwheat
Bull thistle	Heartleaf drymary	Puncturevine	Wild carrot
Bullnettle	Heath aster	Purslane, common	Wild four-o'clock
Burclover	Hedge bindweed	Ragweed	Wild garlic
Burdock	Hedge mustard	Red sorrel	Wild geranium
Burning nettle	Henbit	Redroot pigweed	Wild lettuce
Burweed	Hoary cress	Redstem filaree	Wild marigold
Buttercup	Hoary plantain	Rough cinquefoil	Wild mustard
Buttonweed	Hoary vervain	Rough fleabane	Wild onion
Canada thistle	Horsenettle	Russian pigweed	Wild parsnip
Carolina geranium	Jimsonweed	Russian thistle	Wild radish
Carpetweed	Knawel	Scarlet pimpernel	Wild rape
Catchweed bedstraw	Knotweed	Scotch thistle	Wild strawberry
Catnip	Kochia	Sheep sorrel	Wild sweet potato
Catsear	Lambsquarters	Shepherdspurse	Wild vetch
Chickweed, common	Lespedeza	Slender plantain	Woodsorrel
Chickweed, mouseear	Mallow	Smallflower galinsoga	Woolly croton
Chicory	Matchweed	Smooth dock	Woolly morningglory
Cinquefoil	Mexicanweed	Smooth pigweed	Woolly plantain

Clover, crimson	Milk vetch	Sorrel	Wormseed
Clover, hop	Morningglory	Sowthistle	Yarrow
Clover, red	Mouseear hawkweed	Spanishneedles	Yellow rocket
Clover, strawberry	Mugwort	Speedwell	Yellowflower pepperweed
Clover, sweet	Musk thistle	Spiny amaranth	and other broadleaf weeds
Clover, white			

Spreader Models for Spreader Setting Table:

Drop Spreaders	Application Rate [TURF Fertilizer Plus Trimec DMB Weed Control] 3.0 lbs./1,000 sq. ft.
Agri-Fab Agway Earthway Easy Green Ferti-Lome Glorion Greenview® Spred III Greenview® Spred® XP1 Greenview® Show N Tell Jonathan Green K-Mart K-Grow Lawncrafter 45-0311-3 Ortho Precision Red Devil Drop Republic Drop Scotts AccuGreen® 1000 Scotts AccuGreen® 2000 Scotts AccuGreen® 3000 Scotts Easy Gro Scotts PF-1 Scotts PF-3 Scotts Precision Sears Lawn Crafter SpredDevil Sta-Green Statesman I Statesman II TrueServe Green Thumb 7300 Vigoro	XXX
Broadcast Spreaders	Application Rate [TURF Fertilizer Plus Trimec DMB Weed Control] 3.0 lbs./1,000 sq. ft.
Ace Rotary	XXX
Agri-Fab 45-0187	
Agway	
Ames 24-626 Commercial	
Cyclone Model B1-80	
Earthway EV-N-Spred 2600	
Ferti-Lome	

Franks	
Glorion	
Green Line	
Greenview® Jet-Spred II	
Greenview® Jet-Spred III	
Greenview® Jet-Spred SS1	
Jonathan Green	
Lawnrafter	
Ortho 545 EZGro	
Pennington 2050SU	
Precise Fit	
Precision Pro	
Precision	
Precision Pro	
Precision Products	
PrizeLAWN Lil' FOOT (LF-1)	
Red Devil	
Republic 545 EZGro	
Republic EZ Broadcast 75450	
Republic EZ Grow	
Republic	
Roto-Jet	
Scotts Basic	
Scotts Deluxe™ EdgeGuard®	
Scotts EasyGreen	
Scotts EdgeGuard	
Scotts SpeedyGreen® 1000™	
Scotts SpeedyGreen® 2000™	
Scotts SpeedyGreen® 3000™	
Scotts Standard	
Sears 671-19261	
Sears Craftsman 24322 85lb	
Sta-Green	
Statesman Pull Behind	
Stinger Rotary	
TrueServe Green Thumb 2000A	
Vigoro	