



OFFICE OF CHEMICAL SAFETY AND POLLUTION PREVENTION

WASHINGTON, D.C. 20460

May 08, 2025

Freddy Shelley
freddy.shelley@syntechresearch.com
LEBANON SEABOARD CORPORATION

Subject: Non-PRIA (Pesticide Registration Improvement Act) Partial Labeling Amendment - Add state use rate restrictions and revise formatting
Product Name: LEBANON LAWN FERTILIZER WITH TEAM
Admin Number: 961-348
EPA Receipt Date: 11/25/2024
Action Case Number: 00638365

Dear Freddy Shelley:

The amended labeling referred to above, submitted in connection with registration under the Federal Insecticide, Fungicide, and Rodenticide Act, as amended, is acceptable.

This approval does not affect any terms or conditions that were previously imposed on this registration. You continue to be subject to existing terms or conditions on your registration and any deadlines connected with them.

A stamped copy of your labeling is enclosed for your records. This labeling supersedes all previously accepted labeling. You must submit one (1) copy of the final printed labeling before you release this product for shipment with the new labeling. In accordance with 40 CFR § 152.130(c), you may distribute or sell this product under the previously approved labeling for 18 months from the date of this letter. After 18 months, you may only distribute or sell this product if it bears this new revised labeling or subsequently approved labeling. "To distribute or sell" is defined under FIFRA section 2(gg) and its implementing regulation at 40 CFR § 152.3.

The label submitted with the application has been stamped "Accepted Only Indicated Revisions Reviewed" and is enclosed for your records.

Should you wish to add/retain a reference to your company's website on your label, then please be aware that the website becomes labeling under FIFRA and is subject to review by EPA. If the website is false or misleading, the product will be considered to be misbranded and sale or distribution of the product is unlawful under FIFRA section 12(a)(1)(E). 40 CFR § 156.10(a)(5) lists examples of statements the EPA may consider false or misleading. In addition, regardless of whether a website is referenced on your product's label, claims made on the website may not substantially differ from those claims approved through the registration process. Therefore, should the EPA find or if it is brought to our attention that a website contains statements or claims substantially differing from statements or claims made in connection with obtaining a FIFRA section 3 registration, the website will be referred to the EPA's Office of Enforcement and Compliance Assurance.

Your release for shipment of this product constitutes acceptance of these terms. If these terms are not complied with, this registration will be subject to cancellation in accordance with FIFRA section 6.

If you have questions, please contact Elizabeth Andrews via email at andrews.elizabeth@epa.gov.

Sincerely,

Kable Bo Davis

Kable Bo Davis, Senior Advisor
HB, RD
Office of Pesticide Programs

{MASTER LABEL}
{Sub-Label A: Commercial Use Label}
{Sub-Label B: Homeowner Use Label}

BENFLURALIN	GROUP	3	HERBICIDE
TRIFLURALIN	GROUP	3	HERBICIDE

LEBANON LAWN FERTILIZER WITH TEAM®
CRABGRASS CONTROL

ACCEPTED
ONLY INDICATED
REVISIONS REVIEWED

{Alternate Brand Names}
{GREEN GOLD CRABGRASS CONTROL PLUS LAWN FOOD (CONTAINS TEAM HERBICIDE)}
{GREENPRO CRABGRASS PREVENTER PLUS GRASS FOOD}
{GREENVIEW CRABICIDE GREEN}
{GREENVIEW GREEN GOLD CRABGRASS CONTROL PLUS LAWN FOOD}
{LEBANON PRO FERTILIZER WITH TEAM CRABGRASS CONTROL}
{WONDER GRO DUAL-ACTION TURF FOOD WITH CRABGRASS CONTROL TEAM}

05/08/2025

Under the Federal Insecticide, Fungicide and
Rodenticide Act as amended, for the pesticide
registered under EPA Reg. No.

961-348

No label revisions other than those indicated were
reported to the Agency.

ACTIVE INGREDIENTS:	WT. BY %
Benfluralin	1.030%
Trifluralin	0.515%
OTHER INGREDIENTS:	94.455%
TOTAL:	100.0%

EPA Reg. No. 961-348
Benfluralin CAS. No. 1861-40-1. Trifluralin CAS. No. 1582-09-8.

(L) (D)
EPA Est. No. 961-PA-01:961-IL-01
Superscript used is first letter of lot number.

KEEP OUT OF REACH OF CHILDREN
CAUTION

Si usted no entiende la etiqueta, busque a alguien para que se la explique a usted en detalle.
(If you do not understand this label, find someone to explain it to you in detail.)

See back-panel for additional Precautionary Statements.

{Optional referral statements when booklets and container labels are used:}
{See back panel for First Aid and additional Precautionary Statements.}
{See label booklet for [complete] [additional] [First Aid,] [Precautionary Statements], [Directions For Use],[,] [and] [Storage and Disposal].}

NOTICE: Read the entire label. Use only according to label directions.
Before buying this product, read the Warranty Section elsewhere on this label.
If terms are not acceptable, return the unopened container at once.

Optional Headings [Fertilizer]

GUARANTEED ANALYSIS	
Total Nitrogen (N)	XX%
X.X% Ammoniacal Nitrogen	
X.X% Water Insoluble Nitrogen	
X.X% Urea Nitrogen	
X.X% Other Water Soluble Nitrogen	
Available Phosphate (P2O5)	XX%
Soluble Potash (K2O)	XX%
Nutrient Sources: (Guaranteed Analysis and Nutrient Sources to be supplied based on fertilizer analysis used by manufacturer.)	

GUARANTEED ANALYSIS

~~Total Nitrogen (N).....XX%~~
~~X.X%-~~
~~Ammoniacal-~~
~~Nitrogen-~~
~~X.X%-Water-~~
~~Insoluble-~~
~~Nitrogen-~~
~~X.X%-Urea-~~
~~Nitrogen~~
~~X.X%-Other Water Soluble Nitrogen~~
~~Available Phosphate (P₂O₅).....XX%~~
~~Soluble Potash (K₂O).....XX%~~
~~Nutrient Sources: (Guaranteed Analysis and Nutrient Sources to be supplied based on fertilizer analysis used by manufacturer.)~~

{The following statement must appear (relevant to the fertilizer guarantee):}

{For products distributed in the State of Washington, the following statement must appear:}

{*Note: Information regarding the contents and levels of metals in this product is available on the internet at <http://www.regulatory-info-lebsea.com>.}

{If the fertilizer guarantee contains iron, the following statement must appear:}

{*Note:}[*Notice:]This product contains the secondary nutrient iron. Iron may stain concrete surfaces and should not be applied on dry or water dampened concrete and should be removed from these areas promptly after application by sweeping or blowing. DO NOT wash off with water.}

[MANUFACTURED] [FOR] [BY:] [Distributed [For:] [By:] [Produced] [By:] [For:]]
 LEBANON SEABOARD CORPORATION
 1600 EAST CUMBERLAND STREET
 LEBANON, PA 17042
 [Made in the U.S.A.]
 [www.lebsea.com]

[Covers] [X,XXX] Square Feet [SQUARE FEET] [SQ. FT.] [Sq. Ft.]
 [Net Weight:] [Net Wt.:] [xx] [lbs.] [LBS.] [POUNDS] (xx.xx kg) [(XX.XX KG)]
 [Treats: XX,XXX] [Sq. Ft.] [SQ.FT.] [Square Feet] [SQUARE FEET]
 [Net Contents:]

[Sub-Label A: Commercial Use Label]

BENFLURALIN	GROUP	3	HERBICIDE
TRIFLURALIN	GROUP	3	HERBICIDE

LEBANON LAWN FERTILIZER WITH TEAM® CRABGRASS CONTROL

- {Alternate Brand Names}
- [GREEN GOLD CRABGRASS CONTROL PLUS LAWN FOOD (CONTAINS TEAM HERBICIDE)]
- [GREENPRO CRABGRASS PREVENTER PLUS GRASS FOOD]
- [GREENVIEW CRABICIDE GREEN]
- [GREENVIEW GREEN GOLD CRABGRASS CONTROL PLUS LAWN FOOD]
- [LEBANON PRO FERTILIZER WITH TEAM CRABGRASS CONTROL]
- [WONDER GRO DUAL-ACTION TURF FOOD WITH CRABGRASS CONTROL TEAM]

ACTIVE INGREDIENTS:	WT. BY %
Benfluralin	1.030%
Trifluralin	0.515%
OTHER INGREDIENTS:	94.455%
TOTAL:	100.0%

EPA Reg. No. 961-348
Benfluralin CAS. No. 1861-40-1. Trifluralin CAS. No. 1582-09-8.

(L) (D)
EPA Est. No. 961-PA-01:961-IL-01
Superscript used is first letter of lot number.

KEEP OUT OF REACH OF CHILDREN CAUTION

Si usted no entiende la etiqueta, busque a alguien para que se la explique a usted en detalle.
(If you do not understand this label, find someone to explain it to you in detail.)

See back panel for additional Precautionary Statements.

{Optional referral statements when booklets and container labels are used:}

[See back panel for First Aid and additional Precautionary Statements.]

[See label booklet for [complete] [additional] [First Aid,] [Precautionary Statements], [Directions For Use][,] [and] [Storage and Disposal].]

NOTICE: Read the entire label. Use only according to label directions.
Before buying this product, read the Warranty Section elsewhere on this label.
If terms are not acceptable, return the unopened container at once.

Optional Headings [Fertilizer]

GUARANTEED ANALYSIS	
Total Nitrogen (N)	XX%
X.X% Ammoniacal Nitrogen	
X.X% Water Insoluble Nitrogen	
X.X% Urea Nitrogen	
X.X% Other Water Soluble Nitrogen	
Available Phosphate (P2O5)	XX%
Soluble Potash (K2O)	XX%
Nutrient Sources: (Guaranteed Analysis and Nutrient Sources to be supplied based on fertilizer analysis used by manufacturer.)	

GUARANTEED ANALYSIS

Total Nitrogen (N) XX%

~~X.X%-~~~~Ammoniacal~~~~Nitrogen~~~~X.X% Water~~~~Insoluble~~~~Nitrogen~~~~X.X% Urea~~~~Nitrogen~~~~X.X% Other Water Soluble Nitrogen~~~~Available Phosphate (P_2O_5).....XX%~~~~Soluble Potash (K_2O).....XX%~~~~Nutrient Sources: (Guaranteed Analysis and Nutrient Sources to be supplied based on fertilizer analysis used by manufacturer.)~~{The following statement must appear (relevant to the fertilizer guarantee):}{For products distributed in the State of Washington, the following statement must appear:}{*Note: Information regarding the contents and levels of metals in this product is available on the internet at <http://www.regulatory-info-lebsea.com>.}{If the fertilizer guarantee contains iron, the following statement must appear:}{*Note:}[*Notice:]This product contains the secondary nutrient iron. Iron may stain concrete surfaces and should not be applied on dry or water dampened concrete and should be removed from these areas promptly after application by sweeping or blowing. **DO NOT** wash off with water.}**[MANUFACTURED] [FOR] [BY]:** [Distributed **[For:]** [By:] [Produced] [By:] **[For:]**

LEBANON SEABOARD CORPORATION

1600 EAST CUMBERLAND STREET

LEBANON, PA 17042

[Made in the U.S.A.]**[www.lebsea.com]****[Covers] [X,XXX] Square Feet [SQUARE FEET] [SQ. FT.] [Sq. Ft.]****[Net Weight:] [Net Wt.:] [xx] [lbs.] [LBS.] [POUNDS] (xx.xx kg) [(XX.XX KG)]****[Treats: XX,XXX] [Sq. Ft.] [SQ.FT.] [Square Feet] [SQUARE FEET]****[Net Contents:]**

Optional Headings [Care & Handling]

PRECAUTIONARY STATEMENTS
HAZARDS TO HUMANS AND DOMESTIC ANIMALS
CAUTION

Harmful if absorbed through skin. Avoid contact with skin, eyes or clothing. Prolonged or frequently repeated skin contact may cause allergic reaction in some individuals.

Personal Protective Equipment (PPE)

All loaders, applicators and other handlers must wear:

- Long-sleeved shirt and long pants,
- Socks plus shoes, and
- Chemical-resistant gloves made of any waterproof material.

Follow manufacturer's instructions for cleaning/maintaining PPE. If no such instructions for washables exist, use detergent and hot water. Keep and wash PPE separately from other laundry.

User Safety Recommendations

- Wash hands before eating, drinking, chewing gum, using tobacco, or using the toilet.
- Remove clothing/PPE immediately if pesticide gets inside. Then wash thoroughly and put on clean clothing.
- Remove PPE immediately after handling this product. Wash the outside of gloves before removing. As soon as possible, wash thoroughly and change into clean clothing.

FIRST AID	
IF ON SKIN OR CLOTHING:	<ul style="list-style-type: none">• Take off contaminated clothing.• Rinse skin immediately with plenty of water for 15 - 20 minutes.• Call a poison control center or doctor for treatment advice.
IF SWALLOWED:	<ul style="list-style-type: none">• Call a poison control center or doctor immediately for treatment advice.• Have person sip a glass of water if able to swallow.• DO NOT induce vomiting unless told to do so by a poison control center or doctor.• DO NOT give anything by mouth to an unconscious person.
IF IN EYES:	<ul style="list-style-type: none">• Hold eye open and rinse slowly and gently with water for 15 - 20 minutes.• Remove contact lenses, if present, after the first 5 minutes, then continue rinsing eye.• Call a poison control center or doctor for treatment advice.
IF INHALED:	<ul style="list-style-type: none">• Move person to fresh air.• If person is not breathing, call 911 or an ambulance, then give artificial respiration, preferably mouth-to-mouth if possible.• Call a poison control center or doctor for further treatment advice.
HOTLINE NUMBERS	
Have the product container or label with you when calling a poison control center or doctor, or going for treatment. For Emergency Medical Information call (888) 208-1368.	

ENVIRONMENTAL HAZARDS

This pesticide is extremely toxic to freshwater, marine, and estuarine fish and aquatic invertebrates including shrimp and oyster. **DO NOT** apply in a manner that will directly expose canals, lakes, streams, ponds, marshes or estuaries to aerial drift. **DO NOT** apply directly to water, or to areas where surface water is present or to intertidal areas below the mean high water mark. **DO NOT** contaminate water when disposing of equipment washwater or rinsate. Drift and runoff may be hazardous to aquatic organisms in water adjacent to treated areas.

NON-TARGET ORGANISM ADVISORY STATEMENT: This product is toxic to plants and may adversely impact the forage and habitat of non-target organisms, including pollinators, in areas adjacent to the treated site. Protect the forage and habitat of non-target organisms by following label directions intended to minimize drift.

Optional Headings [Quality Results]

DIRECTIONS FOR USE

It is a violation of Federal law to use this product in a manner inconsistent with its labeling.

Read all directions carefully before applying this product.

[SPREADER SETTINGS]			
SPREADER	[SPEED]	[WIDTH OF COVERAGE]	[SETTINGS]

	<u>[GROUND MPG]</u>	<u>[PTO RPM]</u>	<u>[FEET]</u>	<u>[3.4] [4.0] [5.3] [8.0] [LBS./1,000 SQ. FT.]</u>
<u>[Brand name(s) of Spreader]</u>	<u>[X]</u>	<u>[X]</u>	<u>[X]</u>	<u>[X]</u>
<u>These settings were calibrated and field tested. However, age and condition of spreader, speed of operation, and evenness of terrain may require slightly different settings for desired coverage.</u>				
<u>If your spreader is not listed, or if you need a spreader setting, please call customer service at 1-800-233-0628, Monday through Friday, 8 am. To 5 pm.</u>				

[The following statement may appear when the application rate applies less than 1 pound of nitrogen per 1,000 sq.ft.:

[*Note:] Supplemental applications of lawn fertilizer are needed to achieve a minimum of 1 pound nitrogen per 1,000 sq.ft.]

Apply only to actively growing turf. **DO NOT** exceed [3.2] [XX] lbs. of total nitrogen per 1,000 sq. ft. annually.

[*In **Pennsylvania**: **DO NOT** exceed 0.9 lbs. of total nitrogen per 1,000 sq. ft. per application.]

[In **Maryland, New Jersey, New York and Virginia**: This fertilizer contains phosphorus and may not be used for lawn maintenance on turf in the states of Maryland, New Jersey, New York or Virginia except when:

1. Providing nutrients to specific soils and target vegetation as determined to be necessary in accordance with a soil test that was conducted by a laboratory* performed no more than 3 years before the application.
2. Establishing vegetation for the first time, such as after land disturbance, provided the application is conducted in accordance with the recommended application rates established by the State.
3. Re-establishing or repairing a turf area.]

[*In **Maryland**, the soil testing laboratory must be identified under Section 8-803.7 of the Agriculture Article, Annotated Code of Maryland.]

[In **New Hampshire**: This fertilizer contains phosphate. In New Hampshire, phosphate fertilizers may only be used for turf maintenance in golf courses, parks, athletic fields, and sod farms.]

[In the state[s] of [list the state or states] apply this product at no more than [xx] lb(s). of product per 1,000 sq. ft.]

{Note to reviewer: Justification for the above statement is that several states have restrictions on the maximum amount of nitrogen that can be applied per application. The fertilizer blend is adjusted to accomplish this.}

[The following statement may appear if application rate instructions specify different rates based on different regions in **Florida**: [Optional fertilizer text for state of **Florida** when applicable] **Florida** Applications: [X] annual feedings [with the exception of [listed turfgrass species (X feedings in the north and X feedings in the central and south).] This package applies X.X lb(s). of product per 1,000 sq.ft.]

[For products sold in the state of **Florida**, the following statement may appear: [Optional text for state of Florida] We suggest that you follow the Golf Course BMP's at:

<http://www.dep.state.fl.us/water/nonpoint/docs/nonpoint/glfbmp07.pdf6.>

<https://flgolfbmp.com/>

[For products sold in the state of Florida, the following statement may appear: [Optional text for state of Florida] **DO NOT** apply near water, storm drains or drainage ditches. **DO NOT** apply if heavy rain is expected. Apply this product only to your lawn/garden, and sweep any product that lands on the driveway, sidewalk, or street, back onto your lawn/garden.]

WEED RESISTANCE MANAGEMENT

For resistance management, Lebanon Lawn Fertilizer with TEAM Crabgrass Control contains both a Group 3 / Benfluralin and a Group 3/ Trifluralin herbicide. Any weed population may contain certain or develop plants naturally resistant to Lebanon Lawn Fertilizer with TEAM Crabgrass Control and other Group 3 herbicides. The resistant biotypes may dominate the weed population if these herbicides are used repeatedly in the same area. Appropriate resistance management strategies should be followed.

To delay herbicide resistance, take one or more of the following steps:

- Rotate the use Turf Fertilizer with Lockup plus Dimension Weed Control or other Group 3 herbicides within a growing season with different herbicide groups that control the same weeds.
- Scout after herbicide application to monitor weed populations for early signs of resistance development. Indicators of possible herbicide resistance include: (1) failure to control a weed species normally controlled by the herbicide at the dose applied, especially if control is achieved on adjacent weeds; (2) a spreading patch of non-controlled plants of a particular weed species; (3) surviving plants mixed with controlled individuals of the same species. If resistance is suspected, prevent

weed seed production in the affected area by an alternative herbicide from a different group or by a mechanical method. Prevent movement of resistant weed seeds to other areas by cleaning equipment.

- If weed population continues to progress after treatment with this product, discontinue use of this product, and switch to another management strategy or herbicide with a different mode of action, if available.
- Contact your sales representative, pest control advisors, or local extension specialist for additional pesticide resistance management and/or integrated weed management recommendations for specific types of plants and weed biotypes.

PRODUCT INFORMATION

This turf fertilizer product contains TEAM, a preemergence herbicide which is applied to established turfgrasses for the control of the winter annual grass: Annual Bluegrass (*Poa annua*); and summer annual grasses: Smooth and Hairy Crabgrass, Goosegrass (silver crabgrass or crowfootgrass), Barnyardgrass (watergrass) and Green and Yellow Foxtail. This product also provides partial control of Prostrate Spurge (*Euphorbia humistrata*), Spotted Spurge (*Euphorbia maculata*), Creeping Spurge (*Euphorbia serpens*), Creeping Woodsorrel (*Oxalis corniculata*) and Yellow Woodsorrel (*Oxalis stricta*).

This Product Is Suggested For Use On The Following Established Warm and Cool Season Perennial Turfgrass Species:

Established Cool Season Turfgrasses - Bentgrass Fairways, Kentucky Bluegrass, Perennial Ryegrass, Fescues

Established Warm Season Turfgrasses - Bahiagrass, Bermudagrass, Centipedegrass, St. Augustinegrass, Zoysiagrass.

This product should be applied one to two weeks prior to the anticipated germination of the target annual weeds. Apply using a properly calibrated granular fertilizer spreader which will uniformly distribute the product over the target area. Avoid skips and excessive overlaps as poor weed control or turfgrass injury may occur. Optimum weed control performance will be obtained if treated areas are irrigated soon after application. This product will not harm most nearby ornamentals.

In areas with extended growing seasons or where desired, a second application at the specified rate can be made 8 to 10 weeks following the initial application on cool season turfgrasses and 10 to 12 weeks following the initial application on warm season turfgrasses.

Cool Season Turf: Maximum of 1.5 lbs. a.i. per acre per application. Maximum of 2 applications per year. Maximum of 3 lbs. a.i. per acre per year.

Warm Season Turf: Maximum of 3 lbs. a.i. per acre per application. Maximum of 2 applications per year. Maximum of 6 lbs. a.i. per acre per year.

PRODUCT PRECAUTIONS AND RESTRICTIONS

NOT FOR USE ON PLANTS GROWN FOR SALE OR OTHER COMMERCIAL USE, OR FOR COMMERCIAL SEED PRODUCTION, OR FOR RESEARCH PURPOSES. FOR USE ON PLANTS INTENDED FOR AESTHETIC PURPOSES OR CLIMATIC MODIFICATION AND BEING GROWN IN ORNAMENTAL GARDENS OR PARKS, OR ON GOLF COURSES OR LAWNS AND GROUNDS.

DO NOT Ship or Store with Food, Feeds, Drugs or Clothing.

DO NOT aerially apply this product.

Application Restrictions: **DO NOT** apply this product in a way that will contact workers or other persons, either directly or through drift. Only protected handlers may be in the area during applications.

Entry Restrictions: This product must be watered in as soon as possible after application. **DO NOT** enter or allow people (or pets) to enter the treated area until dusts have settled. Except for those people involved in the watering-in - do not enter or allow other people (or pets) to enter the treated areas until the watering-in is complete and the surface is dry.

Reseeding: Chemicals that effectively control annual weed seeds may also affect new desirable turfgrass seedlings. Reseeding should be delayed for a least 8 weeks after application. When using at the highest specified rate, reseeding should be delayed 12 to 16 weeks after application.

Use caution to confine product to intended application area, as the active ingredients may stain concrete, plastic or other materials.

DO NOT apply this product to golf course putting greens, dichondra, or newly sprigged areas of Bermudagrass, St. Augustinegrass, Centipedegrass or Zoysiagrass.

All of the Summer annual grasses do not germinate at the same time. If application timing does not coincide with the normal germination period of any of the annual grass weeds listed on this label, weed control results may be erratic or poor.

Any cultural practices that disturb the soil, such as aerification or verticutting, should be done prior to application.

APPLICATION INSTRUCTIONS

For most effective annual weedgrass control, make application uniformly over your lawn area with no skips or misses; annual weedgrass will be uninhibited in untreated areas. Do not over-apply or under-apply. Early morning applications when the wind is calm and dew is on the ground are ideal. Wheel tracks are easy to follow and granules can be spread uniformly.

This product must be soil-incorporated within 24 hours of application either by at least 0.5 acre inch of water (rainfall, irrigation) or mechanical incorporation. If a second incorporation is needed it should be delayed 3 to 5 days after the first incorporation and be

completed prior to planting.

Broadcast Application Rates:

For Preemergence Weed Control of:	Product Application Rate	Specific Use Directions
Spring Germinating Annual Grasses - including Crabgrass, Foxtail, Barnyardgrass	Northern (Cool Season) Turfgrass 3 lbs. per 1,000 sq. ft.	Apply in Spring, 1 to 2 weeks prior to the onset of conditions favorable for annual weed grass seed germination.
	Southern (Warm Season) Turfgrass 3 to 4.5 lbs. per 1,000 sq. ft.	Apply in late Winter or early Spring 1 to 2 weeks prior to the onset of conditions favorable for annual weed grass seed germination.
Late Spring, Early Summer Germinating Annual Grasses - including Goosegrass	Northern (Cool Season) Turfgrass 3 lbs. per 1,000 sq. ft.	Goosegrass normally germinates 4 to 6 weeks later than crabgrass, foxtails, etc. Time applications accordingly, in late Spring or early Summer, 1 to 2 weeks prior to the expected germination of goosegrass.
	Southern (Warm Season) Turfgrass 3 to 4.5 lbs. per 1,000 sq. ft.	
Poa Annua (Annual Bluegrass)	Northern (Cool Season) Turfgrass 3 lbs. per 1,000 sq. ft.	Apply in late Summer or early Fall and again in late Winter or Spring, 1 to 2 weeks prior to the expected germination of annual bluegrass.
	Southern (Warm Season) Turfgrass 4.5 lbs. per 1,000 sq. ft.	Apply in late Summer or early Fall 1 to 2 weeks prior to the expected germination of annual bluegrass. A second application of 6 lbs. per 1,000 sq. ft. can be made 10 to 12 weeks after initial treatment for extended control.

SUGGESTED SPREADER SETTINGS

[Note: Registrant/Subregistrant may insert appropriate spreader setting information based on desired spreaders and specified use rates as listed above.]

These settings were calibrated and field tested. However, age and condition of spreader, speed of operation, and evenness of terrain may require slightly different settings for desired coverage.

STORAGE AND DISPOSAL

DO NOT contaminate water, food or feed by storage or disposal.

Pesticide Storage: Store product in its original container in a cool, dry, ~~locked~~ place out of the reach of children and animals.

Pesticide Disposal: Wastes resulting from the use of this product must be disposed of on site or at an approved waste disposal facility.

Container Handling: Nonrefillable container. **DO NOT** reuse or refill this container. Completely empty container into application equipment, then offer for recycling if available or dispose of empty bag in a sanitary landfill or by incineration or, if allowed by State and local authorities, by burning. If burned stay out of smoke.

[WARRANTY:

[NOTE] To the extent consistent with applicable law, Buyer assumes all responsibility for safety and performance if this product is not used according to the directions.]

[Sub-Label B: Homeowner Use Label]

BENFLURALIN	GROUP	3	HERBICIDE
TRIFLURALIN	GROUP	3	HERBICIDE

LEBANON LAWN FERTILIZER WITH TEAM® CRABGRASS CONTROL

{Alternate Brand Names}
[GREEN GOLD CRABGRASS CONTROL PLUS LAWN FOOD (CONTAINS TEAM HERBICIDE)]
[GREENPRO CRABGRASS PREVENTER PLUS GRASS FOOD]
[GREENVIEW CRABICIDE GREEN]
[GREENVIEW GREEN GOLD CRABGRASS CONTROL PLUS LAWN FOOD]
[LEBANON PRO FERTILIZER WITH TEAM CRABGRASS CONTROL]
[WONDER GRO DUAL-ACTION TURF FOOD WITH CRABGRASS CONTROL TEAM]

ACTIVE INGREDIENTS:	WT. BY %
Benfluralin	1.030%
Trifluralin	0.515%
OTHER INGREDIENTS:	94.455%
TOTAL:	100.0%

EPA Reg. No. 961-348

Benfluralin CAS. No. 1861-40-1. Trifluralin CAS. No. 1582-09-8.

(L) (D)

EPA Est. No. 961-PA-01:961-IL-01

Superscript used is first letter of lot number.

KEEP OUT OF REACH OF CHILDREN CAUTION

Si usted no entiende la etiqueta, busque a alguien para que se la explique a usted en detalle.
(If you do not understand this label, find someone to explain it to you in detail.)

See back panel for additional Precautionary Statements.

{Optional referral statements when booklets and container labels are used:}
[See back panel for First Aid and additional Precautionary Statements.]
[See label booklet for [complete] [additional] [First Aid,] [Precautionary Statements], [Directions For Use][,] [and] [Storage and Disposal].]

NOTICE: Read the entire label. Use only according to label directions.
Before buying this product, read the Warranty Section elsewhere on this label.
If terms are not acceptable, return the unopened container at once.

Optional Headings [Fertilizer]

GUARANTEED ANALYSIS	
Total Nitrogen (N)	XX%
X.X% Ammoniacal Nitrogen	
X.X% Water Insoluble Nitrogen	
X.X% Urea Nitrogen	
X.X% Other Water Soluble Nitrogen	
Available Phosphate (P2O5)	XX%
Soluble Potash (K2O)	XX%
Nutrient Sources: (Guaranteed Analysis and Nutrient Sources to be supplied based on fertilizer analysis used by manufacturer.)	

GUARANTEED ANALYSIS
Total Nitrogen (N).....XX%

~~X.X%-~~~~Ammoniacal~~~~Nitrogen~~~~X.X% Water~~~~Insoluble~~~~Nitrogen~~~~X.X% Urea~~~~Nitrogen~~~~X.X% Other Water Soluble Nitrogen~~~~Available Phosphate (P_2O_5).....XX%~~~~Soluble Potash (K_2O).....XX%~~~~Nutrient Sources: (Guaranteed Analysis and Nutrient Sources to be supplied based on fertilizer analysis used by manufacturer.)~~{The following statement must appear (relevant to the fertilizer guarantee):}{For products distributed in the State of Washington, the following statement must appear:}{*Note: Information regarding the contents and levels of metals in this product is available on the internet at <http://www.regulatory-info-lebsea.com>.}{If the fertilizer guarantee contains iron, the following statement must appear:}{*Note:}[*Notice:]This product contains the secondary nutrient iron. Iron may stain concrete surfaces and should not be applied on dry or water dampened concrete and should be removed from these areas promptly after application by sweeping or blowing. **DO NOT** wash off with water.}**[MANUFACTURED] [FOR] [BY]:** [Distributed **[For:]** [By:] [Produced] [By:] **[For:]**

LEBANON SEABOARD CORPORATION

1600 EAST CUMBERLAND STREET

LEBANON, PA 17042

[Made in the U.S.A.]**[www.lebsea.com]****[Covers] [X,XXX] Square Feet [SQUARE FEET] [SQ. FT.] [Sq. Ft.]****[Net Weight:] [Net Wt.:] [xx] [lbs.] [LBS.] [POUNDS] (xx.xx kg) [(XX.XX KG)]****[Treats: XX,XXX] [Sq. Ft.] [SQ.FT.] [Square Feet] [SQUARE FEET]****[Net Contents:]**

Optional Headings [Care & Handling]

PRECAUTIONARY STATEMENTS
HAZARDS TO HUMANS AND DOMESTIC ANIMALS
CAUTION

Harmful if absorbed through skin. Avoid contact with skin, eyes or clothing. Prolonged or frequently repeated skin contact may cause allergic reaction in some individuals. Wear long-sleeved shirt, long pants, socks, shoes, and Chemical-resistant gloves made of any waterproof material.

User Safety Recommendations

- Wash hands before eating, drinking, chewing gum, using tobacco, or using the toilet.
- Remove clothing/PPE immediately if pesticide gets inside. Then wash thoroughly and put on clean clothing.
- Remove PPE immediately after handling this product. Wash the outside of gloves before removing. As soon as possible, wash thoroughly and change into clean clothing.

FIRST AID

IF ON SKIN OR CLOTHING:	<ul style="list-style-type: none"> • Take off contaminated clothing. • Rinse skin immediately with plenty of water for 15 - 20 minutes. • Call a poison control center or doctor for treatment advice.
IF SWALLOWED:	<ul style="list-style-type: none"> • Call a poison control center or doctor immediately for treatment advice. • Have person sip a glass of water if able to swallow. • DO NOT induce vomiting unless told to do so by a poison control center or doctor. • DO NOT give anything by mouth to an unconscious person.
IF IN EYES:	<ul style="list-style-type: none"> • Hold eye open and rinse slowly and gently with water for 15 - 20 minutes. • Remove contact lenses, if present, after the first 5 minutes, then continue rinsing eye. • Call a poison control center or doctor for treatment advice.
IF INHALED:	<ul style="list-style-type: none"> • Move person to fresh air. • If person is not breathing, call 911 or an ambulance, then give artificial respiration, preferably mouth-to-mouth if possible. • Call a poison control center or doctor for further treatment advice.

HOTLINE NUMBERS

Have the product container or label with you when calling a poison control center or doctor, or going for treatment. For Emergency Medical Information call (888) 208-1368.

ENVIRONMENTAL HAZARDS

This pesticide is extremely toxic to freshwater, marine, and estuarine fish and aquatic invertebrates including shrimp and oyster. **DO NOT** apply directly to water. **DO NOT** apply in a manner that will directly expose canals, lakes, streams, ponds, marshes or estuaries to drift or runoff. **DO NOT** contaminate water when disposing of equipment washwaters.

To protect the environment, do not allow pesticide to enter or run off into storm drains, drainage ditches, gutters or surface waters. Applying this product in calm weather will help to ensure that wind does not blow pesticide off the treatment area. Sweeping any product that lands on a driveway, sidewalk, or street, back onto the treated area of the lawn will help to prevent run off to water bodies and drainage systems.

NON-TARGET ORGANISM ADVISORY STATEMENT: This product is toxic to plants and may adversely impact the forage and habitat of non-target organisms, including pollinators, in areas adjacent to the treated site. Protect the forage and habitat of non-target organisms by following label directions intended to minimize drift.

Optional Headings [Quality Results]

DIRECTIONS FOR USE

It is a violation of Federal law to use this product in a manner inconsistent with its labeling.

Read all directions carefully before applying this product.

PRODUCT INFORMATION

This turf fertilizer product contains TEAM, a preemergence herbicide which is applied to established turfgrasses for the control of the winter annual grass: Annual Bluegrass (*Poa annua*); and summer annual grasses: Smooth and Hairy Crabgrass, Goosegrass (silver crabgrass or crowfootgrass), Barnyardgrass (watergrass) and Green and Yellow Foxtail. This product also provides partial control of Prostrate Spurge (*Euphorbia humistrata*), Spotted Spurge (*Euphorbia maculata*), Creeping Spurge (*Euphorbia serpens*), Creeping Woodsorrel (*Oxalis corniculata*) and Yellow Woodsorrel (*Oxalis stricta*).

This Product Is Suggested For Use On The Following Established Warm and Cool Season Perennial Turfgrass Species:

Established Cool Season Turfgrasses - Bentgrass Fairways, Kentucky Bluegrass, Perennial Ryegrass, Fescues

Established Warm Season Turfgrasses - Bahiagrass, Bermudagrass, Centipedegrass, St. Augustinegrass, Zoysiagrass.

This product should be applied one to two weeks prior to the anticipated germination of the target annual weeds. Apply using a properly calibrated granular fertilizer spreader which will uniformly distribute the product over the target area. Avoid skips and excessive overlaps as poor weed control or turfgrass injury may occur. Optimum weed control performance will be obtained if treated areas are irrigated soon after application. This product will not harm most nearby ornamentals.

In areas with extended growing seasons or where desired, a second application at the specified rate can be made 8 to 10 weeks following the initial application on cool season turfgrasses and 10 to 12 weeks following the initial application on warm season turfgrasses.

Cool Season Turf: Maximum of 1.5 lbs. a.i. per acre per application. Maximum of 2 applications per year. Maximum of 3 lbs. a.i. per acre per year.

Warm Season Turf: Maximum of 3 lbs. a.i. per acre per application. Maximum of 2 applications per year. Maximum of 6 lbs. a.i. per acre per year.

PRODUCT PRECAUTIONS AND RESTRICTIONS

NOT FOR USE ON PLANTS GROWN FOR SALE OR OTHER COMMERCIAL USE, OR FOR COMMERCIAL SEED PRODUCTION, OR FOR RESEARCH PURPOSES. FOR USE ON PLANTS INTENDED FOR AESTHETIC PURPOSES OR CLIMATIC MODIFICATION AND BEING GROWN IN ORNAMENTAL GARDENS OR PARKS, OR ON GOLF COURSES OR LAWNS AND GROUNDS.

DO NOT Ship or Store with Food, Feeds, Drugs or Clothing.

Application Restrictions: **DO NOT** apply this product in a way that will contact any person, or pet, either directly or through drift. Keep people and pets out of the area during application.

Entry Restrictions: This product must be watered in as soon as possible after application. **DO NOT** enter or allow people (or pets) to enter the treated area until dusts have settled. Except for those people involved in the watering-in - **DO NOT** enter or allow other people (or pets) to enter the treated areas until the watering-in is complete and the surface is dry.

Reseeding: Chemicals that effectively control annual weed seeds may also affect new desirable turfgrass seedlings. Reseeding should be delayed for a least 8 weeks after application. When using at the highest specified rate, reseeding should be delayed 12 to 16 weeks after application.

Use caution to confine product to intended application area, as the active ingredients may stain concrete, plastic or other materials.

DO NOT apply this product to dichondra, or newly sprigged areas of Bermudagrass, St. Augustinegrass, Centipedegrass or Zoysiagrass.

All of the Summer annual grasses do not germinate at the same time. If application timing does not coincide with the normal germination period of any of the annual grass weeds listed on this label, weed control results may be erratic or poor.

Any cultural practices that disturb the soil, such as aerification or verticutting, should be done prior to application.

APPLICATION INSTRUCTIONS

For most effective annual weedgrass control, make application uniformly over your lawn area with no skips or misses; annual weedgrass will be uninhibited in untreated areas. **DO NOT** over-apply or under-apply. Early morning applications when the wind is calm and dew is on the ground are ideal. Wheel tracks are easy to follow and granules can be spread uniformly.

This product must be soil-incorporated within 24 hours of application either by at least 0.5 acre inch of water (rainfall, irrigation) or mechanical incorporation. If a second incorporation is needed it should be delayed 3 to 5 days after the first incorporation and be completed prior to planting.

Broadcast Application Rates:

For Preemergence Weed Control of:	Product Application Rate	Specific Use Directions
Spring Germinating Annual Grasses - including Crabgrass, Foxtail, Barnyardgrass	Northern (Cool Season) Turfgrass 3 lbs. per 1,000 sq. ft.	Apply in Spring, 1 to 2 weeks prior to the onset of conditions favorable for annual weed grass seed germination.
	Southern (Warm Season) Turfgrass 3 to 4.5 lbs. per 1,000 sq. ft.	Apply in late Winter or early Spring 1 to 2 weeks prior to the onset of conditions favorable for annual weed grass seed germination.
Late Spring, Early Summer Germinating Annual Grasses - including Goosegrass	Northern (Cool Season) Turfgrass 3 lbs. per 1,000 sq. ft.	Goosegrass normally germinates 4 to 6 weeks later than crabgrass, foxtails, etc. Time applications accordingly, in late Spring or early Summer, 1 to 2 weeks prior to the expected germination of goosegrass.
	Southern (Warm Season) Turfgrass 3 to 4.5 lbs. per 1,000 sq. ft.	
Poa Annua (Annual Bluegrass)	Northern (Cool Season) Turfgrass	Apply in late Summer or early Fall and again in

	3 lbs. per 1,000 sq. ft.	late Winter or Spring, 1 to 2 weeks prior to the expected germination of annual bluegrass.
	Southern (Warm Season) Turfgrass 4.5 lbs. per 1,000 sq. ft.	Apply in late Summer or early Fall 1 to 2 weeks prior to the expected germination of annual bluegrass. A second application of 6 lbs. per 1,000 sq. ft. can be made 10 to 12 weeks after initial treatment for extended control.

SUGGESTED SPREADER SETTINGS

[Note: Registrant/Subregistrant may insert appropriate spreader setting information based on desired spreaders and specified use rates as listed above.]

These settings were calibrated and field tested. However, age and condition of spreader, speed of operation, and evenness of terrain may require slightly different settings for desired coverage.

STORAGE AND DISPOSAL

DO NOT contaminate water, food or feed by storage or disposal.
Pesticide Storage: Store product in its original container in a cool, dry, locked place out of the reach of children and animals.
Pesticide Disposal and Container Handling: Nonrefillable container. **DO NOT** reuse or refill this container.
If empty: Place in trash or offer for recycling if available.
If partly filled: Call your local solid waste agency for disposal instructions. Never place unused product down any indoor or outdoor drain.

[WARRANTY:
[NOTE] To the extent consistent with applicable law, Buyer assumes all responsibility for safety and performance if this product is not used according to the directions.]

[Advertising claims that may be presented on the labels]

- [Team and Team logo are registered trademarks of Dow AgroSciences LLC.]
- [Contains TEAM® herbicide [placeholder for pictogram of TEAM Logo]]
- [GreenGold is a registered trademark of Lebanon Seaboard Corporation.]
- [A Granular Fertilizer Containing TEAM* for the Preemergence Control of Crabgrass, Foxtail, Goosegrass, Poa Annua and Other Annual Weed Grasses in Established Turfgrass.]

[GREENVIEW Optional Marketing Claims]

1. [Greenview® - Keeps Your Piece of America Beautiful]
2. [YARD WIDE GUARANTEE with logo - Results guaranteed or your money back]
3. [Greenview guarantees you will be satisfied with the performance of this product, when used as directed, or your money back. Simply send proof of purchase to Greenview, 1600 East Cumberland Street, Lebanon, PA 17042.]
4. [For more information on our complete line of Greenview Lawn and Garden Products, visit our website at www.greenviewfertilizer.com]
5. [For additional information on our complete line of Greenview and Garden products visit our website at www.lebsea.com]
6. [Greenview is a registered trademark of Lebanon Seaboard Corporation.]
7. [GreenView (logo)]

GREENVIEW®

[Agway® Brand of Products Optional Marketing Claims]

1. [Agway (logo)]



2. [Guaranteed Satisfaction (logo)]



3. [AGWAY GUARANTEED SATISFACTION]
4. [GUARANTEED SATISFACTION]
5. [[Brand] is a [registered] trademark of [Company]]
6. [4 Stage Lawn Care Program]
7. [Agway Guarantees Satisfaction]
8. [(Subregistrant) Guarantees Satisfaction]
9. [4 Stage Lawn Care Program.[Pictogram numbers 1-4] [pictogram for 4 Step Program]]
 - [March 1 – April 30]
 - [April 15 – June 15]
 - [August 1- September 30]
10. [Pictogram crabgrass circle with slash through it]
11. [Stage 1 [Pictogram crabgrass with slash through it]]
12. [[AGWAY(Subregistrant)] 4 Stage Lawn Program makes it easier to have a lush, green lawn. Our 4 simple applications eliminate the guesswork and give you professional lawn care results. Each stage combines just the right amount of fertilizer with the right amount of control and prevention. Just match each stage to the correct season and you'll prevent crabgrass, control weeds and insects, and prepare your lawn for winter. It's what your lawn needs for strong growth.]
13. [AGWAY'S Greenlawn products are the quality choice in complete lawn care. You determine your lawn needs, and you'll find a Greenlawn product to help you. Fertilizers, lawn starters, crabgrass prevention, weed and insect control, winterizers - everything your lawn needs for a lush, green lawn and year-round protection. Each one is easy to apply and guaranteed to produce quick, long-lasting results.]
14. [Notice: Read the entire label. Use only according to label directions. Before buying this product, read the Warranty Section ~~elsewhere~~ elsewhere on this label. If terms are not acceptable, return the unopened container at once.]
15. [Notice: Read the entire label. Use only according to label directions. Before buying this product, read Warranty Disclaimer, Inherent Risks of Use, and Limitations of Remedies at end of label. If terms are not acceptable, return the unopened container at once.]
16. [If for any reason you are not fully satisfied with the performance of this product, we want to know. Just bring the item back to the store and we will exchange it or issue a refund.]
17. [Greenlawn (logo)]



18. [AGWAY® and Stage® are registered trademarks of Southern States Cooperative, Inc. Manufactured for and distributed by Southern States Cooperative, Inc., 6606 West Broad Street, Richmond, VA 23230]
19. [To find a store near you visit www.agway.com]
20. [To find an Agway store near you visit www.agway.com]
21. [For best results, use an Agway spreader.]
22. [For more information on spreader settings, go to www.agway.com]

[XX% Nitrogen - Provides leaf growth and makes the grass green; [For dense green lawn]]

[XX% Phosphate - Promotes root development; [Improves root growth]]

[XX% Potassium - Vital for Growth & Drought Resistance]

[XX% Potash - Helps plant resist drought and disease]

[(Percentages dependent on fertilizer analysis used by manufacturer.)]

[Optional Spreader Directions: [Note to the reviewer that the pictograms and text is all options in this section]]

[Determining Your Lawn's Square Footage]

[To determine how much of this product to apply, you must determine the square footage of your lawn. An easy way to do this is to walk the length of your lawn, figuring that one pace equals about 3 feet. Do the same with the width of the lawn. Then multiply the length by the width to arrive at the total. Make sure you subtract the square footage of your home and driveway when calculating the total square footage of your lawn. If your lawn has an irregular shape, try dividing it up into a number of square areas. Calculate the square footage for each area, then add the figures together to reach your total lawn size.]

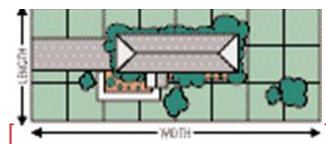

[Spreader Tips]

[For the best application results, use an AGWAY spreader. The two main types of spreaders are the Drop Spreader, which drops the material straight down the width of the spreader as you push, and the Broadcast Spreader (also known as a rotary), which throws the material from the spreader.]

[Drop Spreader: (See Fig. A) First make two passes along the top of the area you'll be covering. Then make two passes along the bottom area. Then move back and forth along the long part of the lawn. For uniform coverage, it's a good idea to overlap wheel marks. On each pass, as you reach the strips at the top and bottom of the area to be covered, shut off the spreader. It's also important to shut off the spreader when you are stopped.]

[Broadcast Spreader: (See Fig. B) Apply in a single pass by starting on the outside border and apply in a circular path working toward the center.]

[Fig. A]

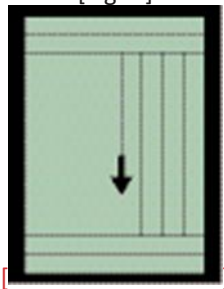

[Fig. B]

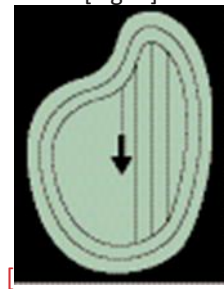

[Optional Spreader Language:]

[The above spreader settings are approximate.]

[To check your spreader: 1 lb. of material should cover approximately 333 sq. ft. (3 lbs. of material per 1,000 sq. ft.)]

[Note: if your spreader model does not appear above please call 800-233-1067, 8am - 5pm EDT, Monday - Friday for additional model settings.]

[Additional Labeling Requirements:]

1. [If the fertilizer guarantee contains iron, the following statement must appear:]

[This product contains the secondary nutrient iron. Iron may stain concrete and should not be applied on dry or water dampened concrete and should be removed from these areas promptly after application by sweeping or blowing. Do not wash off with water.]

2. [If the recommended use rate applies less than 1 pound nitrogen per 1,000 sq. ft. per application, the following statement must appear:]

[Note: Supplemental applications of lawn fertilizer are needed to achieve a minimum 1 pound nitrogen per 1,000 sq. ft.]

3. [For products distributed in the State of Washington, the following statement must appear:]

[Information regarding the contents and levels of metals in this product is available on the Internet at <http://www.regulatory-info-lebsea.com>]

[Optional Marketing Claims]

1. [Grow healthier plants faster]
2. [Promotes root growth for a thicker, greener lawn]
3. [Promotes root growth and increases root mass for a thicker, greener lawn]
4. [Zero phosphate helps protect our waterways]
5. [Zero Phosphate formulation]
6. [No phosphate helps protect our waterways]
7. [Easier on the gardener & increases the likelihood of success]
8. [Gets more nutrients into the plant, not just the soil]
9. [Promotes root growth & stronger, deeper roots – enhancing nutrient absorption by grass roots]
10. [Improved Nitrogen Efficiency – Reduces Leaching]
11. [Provides your soil with nutrients]
12. [Restores nutrients to your soil]
13. [The fertilizer that improves efficiency and lowers application rates providing high quality turf at a reduced cost]
14. [Enhances seedling establishment]
15. [Increases root mass]
16. [Enhances nutrient absorption]
17. [Enhances nutrient absorption for stronger, deeper roots]
18. [Easier on the gardener for a greener, thicker lawn]
19. [Easier way to a greener, thicker lawn]
20. [Easy way to a greener, thicker lawn]
21. [Easy way to a thick, green lawn]
22. [The Easy Way To A Greener, Thicker Lawn]
23. [Feeds, greens and thickens lawns while preventing crabgrass and other grassy weeds.]
24. [Feeds up to 8 weeks]
25. [Feeds your Lawn for 8 weeks]
26. [Feeds lawn with a slow release fertilizer]
27. [Feeds, Greens and Thickens Lawns]
28. [Increases nutrient uptake thereby increasing root mass]
29. [Larger and stronger root system results in a more robust plant [lawn] and reduces the negative effects of stress such as drought on the turf [lawn]]
30. [Formulated to release nutrients [fertilizer] to the plants for easy absorption [uptake]]
31. [Allows the use of less Nitrogen]
32. [Increase nutrient uptake in grass up to 20%]
33. [Enhances nutrient absorption by grass roots, promoting root growth & stronger, deeper roots]
34. [Puts more nutrients into the plant, with less leaching from the soil]
35. [20% less nutrients required for the same great lawn results]
36. [Improved nutrient release and absorption into the lawn allows 20% less nutrients to be applied while still providing quality lawn]
37. [Lowers your cost of fertilizing for the same great lawn results]
38. [20% lower rates of applied nutrients results in lower costs while still getting more of the applied nutrients absorbed into the plant so less can be applied at a lower cost]
39. [Reduces stress on lawns, protecting them from drought & heat]
40. [Requires less watering by growing deeper, stronger roots]
41. [Requires less watering]
42. [Less water needed]
43. [Less watering needed]
44. [Less watering needed, drought resistant]
45. [Reduces plant [lawn] stress related to drought]
46. [Reduces plant [lawn] stress related to drought, more nutrient absorption]
47. [Reduces Stress On Lawns, Protects From Drought & Heat]
48. [Reduces plant stress related to drought, poor nutrient response]
49. [Utilizes less fertilizer]
50. [Faster establishment]
51. [Enhances nutrient absorption by grass roots, promoting root growth & stronger, deeper roots]
52. [More robust plants [lawn] with more nutrients and deeper roots are more colorful and grow to a thicker lawn]
53. [Allows for easier nutrient uptake into the plant [lawn] thus promoting stronger and deeper rooting]
54. [Improved nutrient release and absorption results in more nutrients in the plant [lawn] [turf] for healthy strong roots]
55. [Improved nutrient release makes it easy on plants [lawns] [turf] to absorb nutrients, making it easy for plants [lawns] [turf] to grow more colorful]
56. [Gets more nutrients into the plant by restoring nutrients in the soil]

57. [Gets more nutrients into the plant by revitalizing the soil]
58. [Gets more nutrients into the lawn by making it easier for lawns to absorb]
59. [Gets more nutrients into the lawn by making it easier for lawns to absorb nutrients]
60. [Gets More Nutrients Into Lawns, Easier For Lawns To Absorb]
61. [Gets More Nutrients Into Lawns]
62. [Gets More Nutrients Into The Lawn, Not Just The Soil]
63. [Easier For Lawns To Absorb]
64. [Enhances soil/nutrient availability & balance]
65. [Greater gardener satisfaction by increasing the likelihood of lawn success]
66. [Greater satisfaction by increasing the likelihood of lawn success]
67. [More nutrient absorption leads to stronger and deeper root systems that can take in water deeper from the soil resulting in a more robust lawn that is more drought resistant and requires less additional watering]
68. [Unlocks the nutrients in soil, enhancing nutrient absorption, reducing stress on lawns, protecting them from drought & heat]
69. [Unlocks the nutrients in soil, enhancing nutrient absorption, so you can grow a thicker, greener lawn with less water]
70. [Unlocks the nutrients in your soil]
71. [Prevents crabgrass before it grows]
72. [Controls crabgrass before it germinates.]
73. [Prevents Crabgrass and other Grassy Weeds]
74. [Controls Crabgrass before it grows [pictogram of crabgrass]]
75. [Lowers your cost of fertilizing]
76. [Spring Crabgrass Control]
77. [For Use in Spring]
78. [A Selective Preemergence Herbicide for the Control of Crabgrass and Most Other Annual Weed Grasses on Lawns and Golf Courses.]
79. [In case of emergency endangering health or the environment involving this product, call 1-800-992-5994.]
80. [Agricultural Chemical: Do not ship or store with food, feeds, drugs or clothing.]
81. [Refer to back panel for additional Precautionary Information and Directions for Use including Storage and Disposal.]
82. [Homogeneous Fertilizer]
83. [Telephone and computer mouse graphic with phone # and website address]
84. [Pictogram Placeholder for Bar Code]
85. [Crabgrass Control & Fertilizer]

[Advertising claims that may be presented on the label continued]

1. [The distributor warrants that this product conforms to its chemical description and is reasonably fit for the purpose stated on the label when used in accordance with directions under normal conditions of use, but neither this warranty nor any other warranty of merchantability or fitness for a particular purpose express or implied, extends to the use of this product contrary to label instructions, or abnormal conditions, or under conditions not reasonably foreseeable to Distributor and Buyer. Manufactured by LEBANON SEABOARD CORPORATION, 1600 EAST CUMBERLAND STREET, LEBANON, PA 17042 Exclusively for COMMERCE CORPORATION, 7603 ENERGY PARKWAY, BALTIMORE, MD 21226.]
2. [GUARANTEE: If this quality lawn fertilizer does not perform to your satisfaction, send proof of purchase and empty container with an explanation of the problem to Commerce Corporation within 60 days.]
3. [Distributed and guaranteed by: Lebanon Seaboard Corporation 1600 East Cumberland Street Lebanon, PA 17042 www.lebsea.com]

[ACE Hardware Marketing Claims]

1. [Ace Green Turf Crabgrass Preventer with Fertilizer]
2. [Why does your lawn need Ace Green Turf Crabgrass Preventer with Fertilizer?]
3. [The ACE® Promise
If this ACE product, when used for its intended purpose, fails to give you complete satisfaction, return the item to the ACE Hardware store where purchased for free replacement of the same or similar item.]
4. [(Spanish translation of the above)]
5. [Made in the USA for ACE Hardware Corp., Oak Brook, Illinois, 60523, USA ©2009]
6. [Questions or Comments? Call 1-800-233-1067]
7. [Ace Promise- Satisfaction Guaranteed [pictogram medallion]]
8. [Emerald Park Premium Lawn Care]

[Claims regarding GreenSmart Fertilizer Properties]

1. [GreenSmart (logo)]



2. [GREENSMART ENHANCED EFFICIENCY FERTILIZER FOR A GREEN LAWN and Design is a registered trademark of Lebanon

Seaboard Corporation.]



[Sta-Green is a [registered] trademark of [will insert name of company].]

[Optional Warranty]

[WARRANTY IMPORTANT: READ BEFORE USE]

[Read the entire Directions for Use, Conditions, Disclaimer of Warranties and Limitations of Liability before using this product. If terms are not acceptable, return the unopened product container at once.]

[By using this product, user or buyer accepts the following Conditions, Disclaimer of Warranties and Limitations of Liability.]

[CONDITIONS: The directions for use of this product are believed to be adequate and must be followed carefully. However, it is impossible to eliminate all risks associated with the use of this product. Crop injury, ineffectiveness or other unintended consequences may result because of such factors as weather conditions, presence of other materials, or the manner of use or application, all of which are beyond the control of Lebanon Seaboard Corporation. All such risks shall be assumed by the user or buyer.]

[DISCLAIMER OF WARRANTIES: To the extent consistent with applicable law, LEBANON SEABOARD CORPORATION MAKES NO OTHER WARRANTIES, EXPRESS OR IMPLIED, OF MERCHANTABILITY OR OF FITNESS FOR A PARTICULAR PURPOSE OR OTHERWISE, THAT EXTEND BEYOND THE STATEMENTS MADE ON THIS LABEL. No agent of Lebanon Seaboard Corporation is authorized to make any warranties beyond those contained herein or to modify the warranties contained herein. To the extent consistent with applicable law, Lebanon Seaboard Corporation DISCLAIMS ANY LIABILITY WHATSOEVER FOR SPECIAL, INCIDENTAL OR CONSEQUENTIAL DAMAGES RESULTING FROM THE USE OR HANDLING OF THIS PRODUCT.]

[LIMITATIONS OF LIABILITY: To the extent consistent with applicable law, THE EXCLUSIVE REMEDY OF THE USER OR BUYER FOR ANY AND ALL LOSSES, INJURIES OR DAMAGES RESULTING FROM THE USE OR HANDLING OF THIS PRODUCT, WHETHER IN CONTRACT, WARRANTY, TORT, NEGLIGENCE, STRICT LIABILITY OR OTHERWISE, SHALL NOT EXCEED THE PURCHASE PRICE PAID, OR AT LEBANON SEABOARD CORPORATION'S ELECTION, THE REPLACEMENT OF PRODUCT.]

[Wal-Mart Expert Gardener Brand of Products Optional Marketing Claims]

1. [Expert Gardener logo.]



2. [Expert Gardener Guarantee]



[When you choose Expert Gardener® products, you can be assured of high quality and performance in your lawn and garden. If for any reason you are not completely satisfied with this product, we will refund your money. Please mail your name, address and proof of purchase (dated receipt and package UPC/barcode) to the address listed below. Also, to ensure quality control, please write us a brief note explaining your experience with our product and reason for seeking a refund.]

3. [Guaranteed and Distributed by: [company name]]
4. [Consumer Helpline: 1-866-369-2533]



5. [Information regarding the contents and levels of metals in this product is available on the internet at [website]]



6. [Expert Gardener® is Marketed Exclusively by Wal-Mart Stores Inc. Bentonville, AR 72716.]
7. [Shop @ www.walmart.com]

[True Value Brand of Products Optional Marketing Claims]

1. [GreenThumb logo.]



2. [Manufactured by: [Company Name and address]]
3. [[Brand] is a registered trademark of [Company]]
4. [[Brand] is a trademark of [Company]]

[Tractor Supply Brand of Products Optional Marketing Claims]

1. [Ground Work logo.]



2. [Manufactured by: [Company name]]
3. [Manufactured Exclusively for Tractor Supply Company®]
4. [GroundWork™ is a trademark of Tractor Supply Company®]

[Marketing Claims that can be used for the Commercial labeling]

1. [[Bar code] [product number]]
2. [[Item number]]
3. [[Not] Proof of Purchase]
4. [If the fertilizer guarantee contains iron, the following statement must appear: [Note:][Notice:]This product contains the secondary nutrient iron. Iron may stain concrete surfaces and should not be applied on dry or water dampened concrete and should be removed from these areas promptly after application by sweeping or blowing. Do not wash off with water.]
5. [The following statement must appear (relevant to the fertilizer guarantee): [Note:] Information regarding the contents and levels of metals in this product is available on the internet at <http://www.regulatory-info-lebsea.com>.]
6. [The following statement may appear when the application rate applies less than 1 pound of nitrogen per 1,000 sq. ft.: [Note:] Supplemental applications of lawn fertilizer are needed to achieve a minimum of 1 pound nitrogen per 1,000 sq. ft.]
7. [The following statement may appear if application rate instructions specify different rates based on different regions in Florida: [Optional fertilizer text for state of Florida] Florida Applications: [X] annual feedings [with the exception of [listed turfgrass species (X feedings in the north and X feedings in the central and south).] This package applies X.X lbs. of product per 1,000 sq. ft.]]
8. [For products sold in the state of Florida, the following statement may appear: [Optional text for state of Florida] We suggest that you follow the Golf Course BMP's at: <http://www.dep.state.fl.us/water/nonpoint/docs/nonpoint/glfbmp07.pdf>]
9. [For products sold in the state of Florida, the following statement may appear: [Optional text for state of Florida] Do not apply near water, storm drains or drainage ditches. Do not apply if heavy rain is expected. Apply this product only to your lawn/garden, and sweep any product that lands on the driveway, sidewalk, or street, back onto your lawn/garden.]
10. [Questions or Comments? Call 1-xxx-xxx-xxxx (insert phone graphic)]
11. [Made in U.S.A.]
12. [This Bag Treats Up to _____ Square Feet]
13. [www.lebanonturf.com]
14. [Logo based on granular size:]



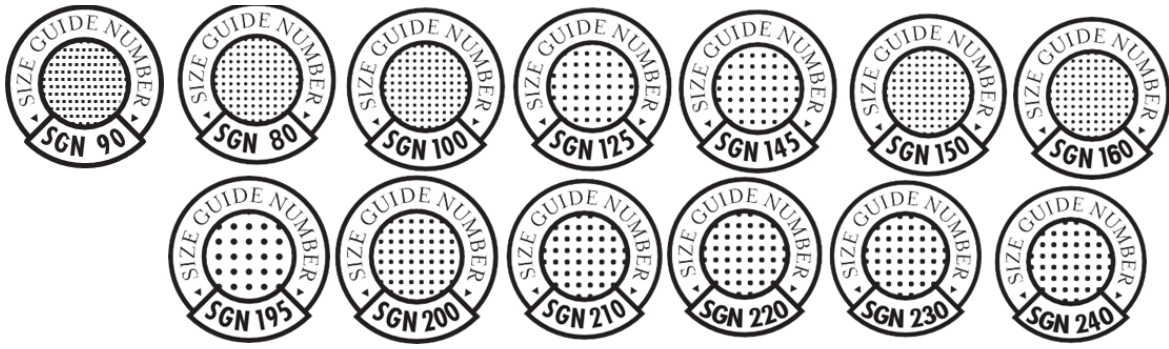

15. [Lebanonturf logo]



16. [Best of All Worlds™]



[Claims regarding Fertilizer Properties]

1. [Fertilizes to provide rich color]
2. [Improves soil fertility]
3. [Promotes root growth for thicker, greener turf]

[Claims regarding Slow Release Fertilizer Properties]

1. [Greens up to 8 weeks]
2. [MESA® is a registered trademark of Lebanon Seaboard Corporation.]
3. [MESA Logo]



4. [MESA Video QR Code, (optional when the product contains MESA)]



5. [Meth-EX® is a registered trademark of Lebanon Seaboard Corporation]
6. [Meth-EX Logo]



7. [EXPO® is a registered trademark of Lebanon Seaboard Corporation]
8. [EXPO Logo]



9. [Patented, controlled release nitrogen for continuous fertilizing]

[Claims regarding GreenSmart Fertilizer Properties]

1. [GreenSmart Enhanced Efficiency Fertilizer® for green turf]
2. [Contains GreenSmart Enhanced Efficiency Fertilizer® for green turf]
3. [GreenSmart Enhanced Efficiency Fertilizer is a registered trademark of Lebanon Seaboard Corporation]
4. [GreenSmart Enhanced Efficiency Fertilizer logo]



[LebanonTurf Brand of products optional marketing claims]

1. [[PennMulch®], [ProScape®], [LSN® LebanonTurf Stabilized Nitrogen], [MESA®], [Meth-EX®], [EXPO®] [GreenSmart Enhanced Efficiency Fertilizer® for Green Turf] are registered trademarks of Lebanon Seaboard Corporation.]
2. [PennMulch® is a registered trademark of Lebanon Seaboard Corporation.]
3. [ProScape® is a registered trademark of Lebanon Seaboard Corporation.]
4. [LSN® LebanonTurf Stabilized Nitrogen is a registered trademark of Lebanon Seaboard Corporation.]
5. [LSN LebanonTurf Stabilized Nitrogen Logo]

