



UNITED STATES ENVIRONMENTAL PROTECTION AGENCY
WASHINGTON, DC 20460

OFFICE OF CHEMICAL SAFETY
AND POLLUTION PREVENTION

March 27, 2023

Mandy Slack
Sr. Analyst, Regulatory Affairs
The Scotts Company d/b/a/ The Ortho Group
PO Box 190
Marysville, OH 43040

Subject: Registration Review Label Mitigation for MCPP
Product Name: WBG 555 RTU
EPA Registration Number: 239-2760
Application Date: December 14, 2020
Decision Number: 568782

Dear Mandy Slack:

The Agency, in accordance with the Federal Insecticide, Fungicide and Rodenticide Act (FIFRA), as amended, has completed reviewing all the information submitted with your application to support the Registration Review of the above referenced product in connection with the MCPP Interim Decision, and has concluded that your submission is acceptable. The label referred to above, submitted in connection with registration under FIFRA, as amended, is acceptable.

Should you wish to add/retain a reference to the company's website on your label, then please be aware that the website becomes labeling under the Federal Insecticide Fungicide and Rodenticide Act and is subject to review by the Agency. If the website is false or misleading, the product would be misbranded and unlawful to sell or distribute under FIFRA section 12(a)(1)(E). 40 CFR 156.10(a)(5) list examples of statements EPA may consider false or misleading. In addition, regardless of whether a website is referenced on your product's label, claims made on the website may not substantially differ from those claims approved through the registration process. Therefore, should the Agency find or if it is brought to our attention that a website contains false or misleading statements or claims substantially differing from the EPA approved registration, the website will be referred to the EPA's Office of Enforcement and Compliance.

A stamped copy of your labeling is enclosed for your records. This labeling supersedes all previously accepted labeling. You must submit one copy of the final printed labeling before you release the product for shipment with the new labeling. In accordance with 40 CFR 152.130(c), you may distribute or sell this product under the previously approved labeling for 12 months from the date of this letter. After 12 months, you may only distribute or sell this product if it bears this new revised labeling or subsequently approved labeling. "To distribute or sell" is defined under FIFRA section 2(gg) and its implementing regulation at 40 CFR 152.3.

Page 2 of 2
EPA Reg. No. 239-2760
Decision No. 568782

If you have any questions about this letter, please contact DeMariah Koger by phone at (202)-566-2288, or via email at koger.demariah@epa.gov.

Sincerely,

A handwritten signature in blue ink, appearing to read "Linda Arrington", with a long horizontal flourish extending to the right.

Linda Arrington, Branch Chief
Risk Management and Implementation Branch 4
Pesticide Re-Evaluation Division
Office of Pesticide Programs

Enclosure

WBG 555 RTU

Alternate Brand Name:

- Ortho® Weed B Gon® Weed Killer for Lawns Ready-To-Use³

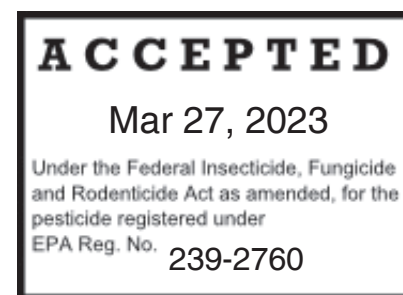

ACTIVE INGREDIENTS

| | |
|---|--------|
| Dimethylamine Salt of 2,4-D Acid* | 0.605% |
| Dimethylamine Salt of Mecoprop-p Acid** | 0.149% |
| Dicamba Acid*** | 0.026% |

| | |
|--------------------------------|----------------|
| OTHER INGREDIENTS | <u>99.220%</u> |
| TOTAL | 100.000% |

Isomer Specific Method, Equivalent to:

| | |
|-------------------------|-------------------------|
| *2,4-D Acid | 0.503%, 0.042 lbs./gal. |
| **Mecoprop-p Acid | 0.123%, 0.010 lbs./gal. |
| ***Dicamba Acid | 0.026%, 0.002 lbs./gal. |

KEEP OUT OF REACH OF CHILDREN

CAUTION

See [back] [side] [other] [panel] [booklet] for additional precautionary statements

NET CONTENTS XXGALS, XXQT, XX PT, XX fl oz

Bold, italicized text is information for the reader and is not part of the label.

[Bracketed information is optional text]. Text separated by / denotes and/or options.

**PRECAUTIONARY STATEMENTS
HAZARDS TO HUMANS AND DOMESTIC ANIMALS
CAUTION**

Harmful if swallowed. Causes moderate eye irritation. Avoid contact with eyes or clothing. Prolonged or repeated skin contact may cause allergic reactions in some individuals. Wash thoroughly with soap and water after handling and before eating, drinking, chewing gum, using tobacco or using the toilet.

| FIRST AID [icon] | |
|---|--|
| IF IN EYES | <ul style="list-style-type: none"> • Hold eye open and rinse slowly and gently with water for 15 to 20 minutes. • Remove contact lenses, if present, after the first 5 minutes, then continue rinsing eye. • Call a poison control center or doctor for treatment advice. |
| IF SWALLOWED | <ul style="list-style-type: none"> • Call poison control center or doctor immediately for treatment advice. • Have person sip a glass of water if able to swallow. • Do not induce vomiting unless told to do so by the poison control center or doctor. • Do not give anything by mouth to an unconscious person. |
| HOT LINE NUMBER | |
| Have the product container or label with you when calling a poison control center or doctor, or going for treatment. You may also contact 1-877-465-5161 for emergency medical treatment information. | |

ENVIRONMENTAL HAZARDS

This pesticide is toxic to fish and aquatic invertebrates and may be adversely affect non-target plants. To protect the environment, do not allow pesticide to enter or run off into storm drains, drainage ditches, gutters or surface waters. Applying this product in calm weather when rain is not predicted for the next 24 hours will help to ensure that wind or rain does not blow or wash pesticide off the treatment area. Drift and runoff may be hazardous to aquatic organisms in water adjacent to treated areas. This product has properties and characteristics associated with chemicals detected in groundwater. The use of this product in areas where soils are permeable, particularly where the water table is shallow, may result in groundwater contamination. Application around a cistern or well may result in contamination of drinking water or groundwater.

NON-TARGET ORGANISM ADVISORY: This product is toxic to plants and may adversely impact the forage and habitat of non-target organisms, including pollinators, in areas adjacent to the treated site. Protect the forage and habitat of non-target organisms by following label directions intended to minimize spray drift.

READY TO USE

DIRECTIONS FOR USE

It is a violation of Federal law to use this product in a manner inconsistent with its labeling. READ ENTIRE LABEL BEFORE USE.

PRECAUTIONS

- Aim at center of weed and spray to lightly cover weed leaves.
- To prevent product runoff, do not overwater the treated area to the point of runoff or apply when raining or when rain is expected that day.
- Allow 12 hours after application before watering lawn for maximum effectiveness on listed weeds.

USE RESTRICTIONS

- Do not apply this product in a way that will contact any person or pet, either directly or through drift. Keep people and pets out of the area during application.
- [Reentry Icon] Do not allow people or pets to enter the treated area until sprays have dried. 
- Do not exceed two applications per year with a minimum of 30 days between applications.
- Do not use this product for controlling weeds in flower or vegetable beds or around shrubs or ornamental plantings.
- Do not exceed directed rates because damage to turf may occur.
- Do not spray exposed roots of desirable plants.
- Do not exceed directed rates because damage to turf may occur.
- Do not apply directly to or near water, storm drains, gutters, sewers or drainage ditches.

NOTE:

EPA Reg. No. 239-2760

Bold, italicized text is information for the reader and is not part of the label.

[Bracketed information is optional text]. Text separated by / denotes and/or options.

- Do not apply within 25 feet of rivers, fish ponds, lakes, streams, reservoirs, marshes, estuaries, bays, and oceans.
- Do not apply when windy.
- Spray when air is calm to avoid spray drift that might injure desirable ornamental plants. Do not spray as a fine mist as injury to non-target plants may occur.
- Do not apply to newly seeded grasses until they have been mowed 3 times.
- Do not reseed for 4 weeks after use. If lawn needs watering, water thoroughly before application.
- Do not spray on Dichondra, Lippia, or on grasses where desirable Clovers are present.
- Do not apply when temperature exceeds 90°F.
- Do not apply if rain is expected within 24 hours of application.

[HOW IT WORKS/PRODUCT INFORMATION:

WBG 555 RTU /Product Name/ this/ the product contains three proven weed killers that target lawn weeds. This herbicide enters the lawn weeds through their leaves and moves throughout the plant to provide control. Lawns listed on this label will not be harmed when used as directed.]

WHERE TO USE /APPLY:

WBG 555 RTU /Product Name/This/the product is a ready-to-use product intended for the treatment of individual weeds, patches of weeds or sparse weeds scattered throughout home lawns. WBG 555 RTU /Product Name /This/the product can be applied to the following established turfgrass types:

| Lawns To Be Treated: | |
|---|--|
| Warm Season Turfgrass | Cool Season Turfgrass |
| St. Augustinegrass ¹ , (Do not use on Floratam) Bermudagrass , common and hybrid Centipedegrass Zoysiagrass Buffalograss ¹ Bahagrass | Kentucky bluegrass Ryegrass Tall fescue Fine fescue |
| ¹ Application to St. Augustinegrass or buffalograss may cause temporary yellowing or discoloration but full recovery can be expected. | |

| |
|---|
| DO NOT apply [WBG 555 RTU /Product Name/ this/the product] to the following: Floratam variety of St. Augustinegrass Bentgrass Carpetgrass Dichondra Lippia Gardens including vegetables, fruit trees, vines and berries Ornamental plants (flowers, trees, groundcovers, landscape beds and shrubs) Seashore paspalum Turfgrass species that are not listed on this label. |
|---|

WHEN TO USE /APPLY:

Apply this product when weeds are small and actively growing in the spring or fall. Aim at center of weed and spray to lightly cover weed leaves.

[Weeds begin to wilt and die within 24 hours. Weeds die completely within 14 – 28 days after application. Won't harm lawn grasses.]

NOTE:

EPA Reg. No. 239-2760

Bold, italicized text is information for the reader and is not part of the label.

[Bracketed information is optional text]. Text separated by / denotes and/or options.

BROADLEAF WEEDS CONTROLLED/ [KILLS WEEDS INCLUDING:]

Note to PM: Some or all of the following weeds will appear on the label.

| | | | |
|----------------------------|--------------------|-----------------------|---------------------------|
| Alder | Dead Nettle | Narrowleaf plantain | Spotted knapweed |
| Annual yellow sweet clover | Dock | Narrowleaf vetch | Spotted spurge |
| Artichoke | Dogbane | Nettle | Spurge |
| Aster | Dogfennel | Nutgrass | Spurweed |
| Austrian fieldcress | Elderberry | Orange hawkweed | Stinging nettle |
| Bedstraw | English daisy | Oxalis | Stinkweed |
| Beggartick | Fall dandelion | Oxeye daisy | Stichwort |
| Biden | False dandelion | Parsley-piert | Strawberry clover |
| Bindweed | False flax | Parsnip | Sumac |
| Bird vetch | False sunflower | Pearlwort | Sunflower |
| Bitterweed | Fiddleneck | Pennycress | Sweet clover |
| Bitter wintercress | Field bindweed | Pennywort | Tall nettle |
| Black-eyed Susan | Field pansy | Peppergrass | Tall vervain |
| Black medic | Flea bane (Daisy) | Pepperweed | Tansy mustard |
| Black mustard | Flixweed | Pigweed | Tansy ragwort |
| Blackseed plantain | Florida betony | Pineywoods bedstraw | Tanweed |
| Blessed thistle | Florida pusley | Plains coeopsis | Tarweed |
| Bloodflower | Frenchweed | Plantain | Thistle |
| Blue lettuce | Galinsoga | Poison hemlock | Tick trefoil |
| Blue vervain | Garlic mustard | Poison ivy | Toadflax |
| Box elder | Goathead | Poison oak | Trailing crown vetch |
| Bracted plantain | Goatsbeard | Pokeweed | Tumble mustard |
| Brassbuttons | Goldenrod | Poorjoe | Tumble pigweed |
| Bristly oxtongue | Ground ivy | Povertyweed | Tumbleweed |
| Broadleaf dock | Gumweed | Prickly lettuce | Velvetleaf |
| Broadleaf plantain | Hairy bittercress | Prickly sida | Venice mallow |
| Broomweed | Hairy fleabane | Primrose | Veronica |
| Buckhorn | Hawkweed | Prostrate knotweed | Vervain |
| Buckhorn plantain | Healall | Prostrate pigweed | Vetch |
| Bulbous buttercup | Heartleaf drymary | Prostrate spurge | Virginia buttonweed |
| Bull nettle | Hedge bindweed | Prostrate vervain | Virginia creeper |
| Bull thistle | Hedge mustard | Puncture vine | Virginia pepperweed |
| Burdock | Hemp | Purslane | Wavyleaf bullthistle |
| Burning nettle | Henbit | Ragweed | Western clematis |
| Bur ragweed | Hoary cress | Red clover | Western salsify |
| Burweed | Hoary plantain | Redroot pigweed | White clover |
| Buttercup | Hoary vervain | Red sorrel | White mustard |
| Canada thistle | Honeysuckle | Redstem filaree | Wild mustard |
| Carolina geranium | Hop clover | Rough cinquefoil | Wild aster |
| Carpetweed | Horsenettle | Rough fleabane | Wild buckwheat |
| Catchweed bedstraw | Horsetail | Roundleafed marigold | Wild carrot |
| Catsear | Indiana mallow | Rush | Wild four-o'clock, |
| Catnip | Ironweed | Russian pigweed | Wild geranium |
| Chickweed | Jewelweed | Russian thistle | Wild lettuce |
| Chicory | Jimsonweed | St. Johnswort | Wild marigold |
| Cinquefoil | Kochia | Scarlet pimpernel | Wild parsnip |
| Clover | Knawel | Scotch thistle | Wild radish |
| Cockle | Knotweed | Sheep sorrel | Wild rape |
| Cocklebur | Lambsquarter | Shepherdspurse | Wild strawberry |
| Coffeebean | Lespedeza | Slender plantain | Wild sweet potato |
| Coffeeweed | Locoweed | Smallflower galinsoga | Wild vetch |
| Common chickweed | Lupine | Smartweed | Willow |
| Common mullein | Mallow | Smooth dock | Witchweed |
| Common sowthistle | Marshelder | Smooth pigweed | Woolly morningglory |
| Corn chamomile | Matchweed | Sneezeweed | Woodsorrel |
| Creeping Jenny | Mexicanweed | Southern wild rose | Woolly croton |
| Creeping Woodsorrel | Milk vetch | Sowthistle | Woolly plantain |
| Crimson clover | Milkweed | Spanishneedle | Wormseed |
| Croton | Mugwort | Spatterdock | Yarrow |
| Cudweed | Morningglory | Speedwell | Yellow Rocket |
| Curly dock | Mouseear chickweed | Spiny amaranth | Yellow Woodsorrel |
| Curly indigo | Musk thistle | Spiny cocklebur | Yellow flower pepperweed |
| Dandelion | Mustard | Spotted catsear | and other broadleaf weeds |

Bold, italicized text is information for the reader and is not part of the label.

[Bracketed information is optional text]. Text separated by / denotes and/or options.

Directions For Use Options Based On Applicator

Note to PM: For all options below, the graphics illustrating a step or group of steps may appear on the final printed label.

Quotes around Directions are optional (i.e. "ON", "OFF")

Option 1 – Conventional Trigger Small RTU

[Applicator (Device) (Applicator Name) Directions/Instructions]

[HOW TO USE/APPLY:]

Spray

1. Turn sprayer nozzle to desired spray.
2. Squeeze trigger repeatedly to spray.
3. Spray only until the surface [of the weed] is wet. / Spray evenly.

Finish

1. Turn sprayer nozzle to "OFF" [X]

Option 2 – Conventional Trigger Large RTU

[Applicator (Device) (Applicator Name) Directions/Instructions]

HOW TO USE/APPLY: [] or []

Spray

1. Remove sprayer from bottle by [sliding/pulling] sprayer up.
2. Unwrap/Uncoil hose and insert [[color] hose connector] into [color] spout on [bottle] cap /knob /lid/ opening until it clicks.
3. [Flip up [color] spout until fully upright] / [Twist /turn spout/knob to "ON"]/[Pull spout up].
4. Turn sprayer nozzle to desired spray [pattern/setting].
4. Squeeze trigger repeatedly [to spray].
5. Spray only until the surface [of the weed] is wet. / Spray evenly.

Finish

1. Turn/twist sprayer nozzle to "OFF" [X].
2. [Push /turn / twist cap / knob / spout to "OFF" [X]]/ [Flip spout closed.]
3. [DO NOT DISCONNECT HOSE CONNECTOR FROM SPOUT/CAP/KNOB/OPENING.]
4. [Place sprayer back into the holster/holder/clip/lug side of bottle.]

[Optional illustrations may be used in conjunction with the above steps.]

STORAGE & DISPOSAL

PESTICIDE STORAGE: [Small][Large][Applicator Name] Keep from freezing. Store in original container and place in areas inaccessible to children.

PESTICIDE DISPOSAL AND/CONTAINER HANDLING: Nonrefillable container. Do not reuse or refill this container.

If empty: Place in trash or offer for recycling if available. **If partly filled:** Call your local solid waste agency for disposal instructions. Never place unused product down any indoor (including toilet) or outdoor (including sewer) drain.

Option 3 - Pull 'N Spray® II

[Applicator (Device) (Applicator Name) Directions/Instructions]

HOW TO USE/APPLY: [] [] [] [] []]

Spray

1. Remove sprayer/Applicator Name from holster / holder /clip /lug side of bottle.
2. Unwrap/Uncoil hose and insert [[color] hose connector] into [color] spout on bottle cap /knob/lid/ opening until it clicks.
3. [Flip up [color] spout until fully upright] / [Twist /turn spout/knob to "ON"] / [Pull spout up].

Bold, italicized text is information for the reader and is not part of the label.

[Bracketed information is optional text]. Text separated by / denotes and/or options.

4. Turn sprayer nozzle to desired spray [pattern/setting].
5. Point sprayer away from body. Slowly pull ring at bottom of sprayer until it stops, and hold for two [2] seconds to fill sprayer.
6. Press trigger to spray.
7. Spray only until the surface [of the weed] is wet. / Spray evenly.

Finish

1. Turn sprayer nozzle to "OFF" [X].
2. [Push /turn / twist cap / knob / spout to "OFF" [X]]/ [Flip spout closed.]
3. [DO NOT DISCONNECT HOSE CONNECTOR FROM SPOUT/CAP/KNOB/LID/OPENING.]
4. [Place sprayer back into the holster/holder/clip/lug side of bottle.]

[Optional illustrations may be used in conjunction with the above steps.]

Optional Refill/Reuse Directions

[The Pull 'N Spray II/Applicator Name [applicator/sprayer/wand] may be reused with the available WBG 555 RTU / Product Name refill bottle/container. Read and follow instructions [on the refill container/in Reuse Directions] to reuse the applicator.]

Refill/Reuse Directions

How to attach the [Pull 'N Spray II/Applicator Name] [applicator/sprayer/wand] to WBG 555 RTU / Product Name [refill bottle/container]:

Removing [color] hose/Comfort Wand/Applicator Name from original bottle/container:

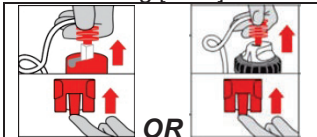
| | |
|---|--|
|  | <p>Remove the [color] hose connector from the original bottle/container by pulling the [color] plug from the [color] spout on cap.</p> <p>[To remove the side holster/holder from original bottle/container, pull/lift the bottom tab underneath and slide the holster/holder up.]</p> |
|---|--|

Adding [color] hose/Comfort Wand/Applicator Name to WBG 555 RTU/Product Name/refill/recharge/renew/fill-up/reload/bottle/container:

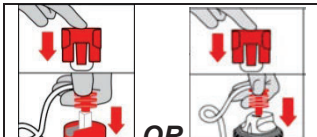
| | |
|---|--|
|  | <p>[Attach the sprayer holster/holder to WBG 555 RTU/Product Name/refill/recharge/renew/fill-up/reload/bottle/container by sliding the holster/holder down onto the knob.]</p> <p>Insert [color] hose connector into [color] spout on cap [until it clicks].</p> |
|---|--|

OR

REFILL: This container may be refilled with WBG 555 RTU/Product Name. To refill twist/snap WBG 555 RTU /Product Name into spray/applicator nozzle/top.

Refill by pouring in same RTU formula from Bottle

[HOW TO] REFILL

This container may be refilled with WBG 555 RTU/Product Name. To refill pour WBG 555 RTU/Product Name into container.

OR

To refill this empty container, pour product carefully and directly from the WBG 555 RTU/Product Name container designated as the ready-to-use refill container. DO NOT add water.

STORAGE & DISPOSAL

PESTICIDE STORAGE: [Pull 'N Spray II/Applicator Name] [Applicator]: Keep from freezing. Store in original container and place in areas inaccessible to children.

PESTICIDE DISPOSAL AND/ & CONTAINER HANDLING: Pull 'N Spray II/Applicator Name can be reused with WBG 555 RTU /Product Name refill bottle/container. Follow instructions in the Reuse Directions when reusing [applicator name]. Nonrefillable container. Do not reuse or refill this container. **If empty:** Place in trash or offer for recycling if available. **If partly filled:** Call your local solid waste agency for disposal instructions. Never place unused product down any indoor (including toilet) or outdoor (including sewer) drain.

NOTE:

EPA Reg. No. 239-2760

Bold, italicized text is information for the reader and is not part of the label.

[Bracketed information is optional text]. Text separated by / denotes and/or options.

Option 4 – Battery Powered Wand/Comfort Wand

[[Applicator Name] [Applicator/Wand] Directions]

HOW TO USE/APPLY:

Prep [Wand] [] or [] or [] or [] or []

1. Remove sprayer [Applicator Name] from the holster/holder/clip/lug side of bottle
2. [Remove [color] pull strip to activate batteries.]
3. Unfold [Flip Open] [Applicator Name] [wand] until it clicks [locks] into position.

Connect  or []

1. Unwrap [uncoil] hose and insert [color] hose connector into [color] spout knob/lid/ opening on [bottle] cap until it clicks.
2. [Flip up [color] spout /knob until fully upright.] [Twist/turn spout/knob to “ON”.] [Pull spout up.]

Spray [] or []

1. Turn sprayer nozzle to desired spray [pattern].
2. [Slide [color] switch on trigger to “Unlock” [illustration]].
3. Press trigger to spray.
4. Spray only until the surface [of the weed] is wet. / Spray evenly.

Finish []

1. Turn [sprayer] nozzle to “OFF” [X].
2. [Slide [color] switch on trigger to “Lock” [illustration]].
3. [Push /turn / twist cap / knob / spout to “OFF” [X]]/ [Flip spout closed.]
4. Fold [Applicator Name] wand closed and place sprayer back in the holster/holder/clip/lug side of bottle.

[Optional illustrations may be used in conjunction with the above steps.]

Important Use Information: Do not submerge in water. When storing sprayer for long periods, remove batteries.

[To replace batteries: See marked diagram inside battery compartment.]

Optional Refill/Reuse Directions

[The Comfort Wand/Applicator Name [applicator/sprayer/wand] may be reused with WBG 555 RTU / Product Name refill bottle/container. Read and follow instructions [on the refill container/in Reuse Directions] to reuse the applicator.]

Refill/Reuse Directions

How to attach the [Comfort Wand/Applicator Name] [applicator/sprayer/wand] to WBG 555 RTU / Product Name [refill bottle]:

How to attach the [Pull ‘N Spray II/Applicator Name] [applicator/sprayer/wand] to WBG 555 RTU / Product Name [refill bottle/container]:

Removing [color] hose/Comfort Wand/Applicator Name from original bottle/container:

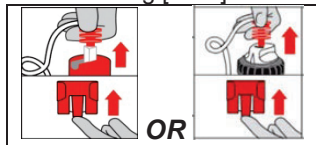

Remove the [color] hose connector from the original bottle/container by pulling the [color] plug from the [color] spout on cap.

[To remove the side holster/holder from original bottle/container, pull/lift the bottom tab underneath and slide the holster/holder up.]

Adding [color] hose/Comfort Wand/Applicator Name to WBG 555 RTU/Product Name/refill/recharge/renew/fill-up/reload/bottle/container:

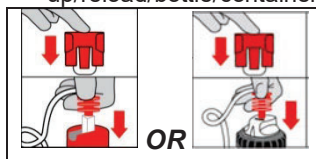

[Attach the sprayer holster/holder to WBG 555 RTU/Product Name/refill/recharge/renew/fill-up/reload/bottle/container by sliding the holster/holder down onto the knob.]

Insert [color] hose connector into [color] spout on cap [until it clicks].

NOTE:

EPA Reg. No. 239-2760

Bold, italicized text is information for the reader and is not part of the label.

[Bracketed information is optional text]. Text separated by / denotes and/or options.

OR

REFILL: This container may be refilled with WBG 555 RTU/Product Name. To refill twist/snap WBG 555 RTU /Product Name into spray/applicator nozzle/top.

Refill by pouring in same RTU formula from Bottle

[HOW TO] REFILL

This container may be refilled with WBG 555 RTU/Product Name. To refill pour WBG 555 RTU/Product Name into container.

OR

To refill this empty container, pour product carefully and directly from the WBG 555 RTU/Product Name container designated as the ready-to-use refill container. DO NOT add water.

STORAGE & DISPOSAL

PESTICIDE STORAGE: Keep from freezing. Store in original container and place in areas inaccessible to children.

PESTICIDE DISPOSAL AND/ & CONTAINER HANDLING: Comfort Wand /Applicator Name can be reused with WBG 555 RTU / Product Name refill bottle/container. Follow instructions in Reuse Directions when reusing [applicator name]. Nonrefillable container. Do not reuse or refill this container. **If empty:** Place in trash or offer for recycling if available. **If partly filled:** Call your local solid waste agency for disposal instructions. Never place unused product down any indoor (including toilet) or outdoor (including sewer) drain.

Option 5 – Squeeze Applicator

[[Applicator Name] [Applicator/Wand] Directions]

HOW TO USE/APPLY *Alternative Text:* [HOW TO ASSEMBLE AND USE INSTRUCTIONS]:

[Open:]

- [Twist off cap and remove foil liner.]
- [Replace cap.]
- Flip/Twist/Open Cap

[Spray:]

- To BEGIN spraying, invert the bottle and point/aim/direct [at the weed/or area of application]
- Squeeze the bottle [to initiate the flow of product.]
- Spray only until the surface [of the weed] is wet. / Spray evenly.

[Finish:]

- [To STOP spraying, [release pressure] [turn bottle upright]
- [Flip/twist/close the cap [until you hear an audible snap / until secure].

OR

HOW TO USE/APPLY *Alternative Text:* [HOW TO ASSEMBLE AND USE INSTRUCTIONS]:

Spray

1. Twist off cap from bottle and remove foil seal.
2. [Twist on cap to bottle.]
3. Open flip top on cap.
4. Point bottle toward target weed and squeeze bottle to spray product.
5. Spray only until the surface [of the weed] is wet. / Spray evenly.

Finish

1. Close flip top on cap.

[Optional illustrations may be used in conjunction with the above steps.]

Bold, italicized text is information for the reader and is not part of the label.

[Bracketed information is optional text]. Text separated by / denotes and/or options.

STORAGE & DISPOSAL

PESTICIDE STORAGE: [Small][Large][Applicator Name] Keep from freezing. Store in original container and place in areas inaccessible to children.

PESTICIDE DISPOSAL AND/CONTAINER HANDLING: Nonrefillable container. Do not reuse or refill this container. **If empty:** Place in trash or offer for recycling if available. **If partly filled:** Call your local solid waste agency for disposal instructions. Never place unused product down any indoor (including toilet) or outdoor (including sewer) drain.

OPTIONAL MARKETING CLAIMS

The following Product Facts format is optional and the information may appear inside or outside of a box.

PRODUCT FACTS:

[What It Does:] Kills major broadleaf weeds including dandelion, clover, chickweed and dollarweed. (See inside [booklet] for complete/weed list)

[Where to Use /Apply:] Lawns: Kills the weeds not the lawn when used as directed. [icon weeds]

[When to Use:] Apply when daytime temperatures are below 90°F.

Questions &/or Comments: [icon phone] [icon computer] Call 1-800-225-2883 or [Visit our Website] at www.ortho.com

USE TIPS:

| | | |
|--------------------------|---|---|
| When to Apply: | For established lawns | Apply when daytime temperatures are below 90°F. |
| | For newly seeded areas | Apply this product to newly seeded grasses when well-established (approximately 6 weeks after seedling emergence) or after the third mowing. |
| | For newly sodded, sprigged, or plugged areas | Apply this product 3 to 4 weeks after the sodding, sprigging, or plugging operations. |
| Seeding: | | The treated area can be seeded at 4 weeks after the application of this product. |
| Irrigation: | Non-stressed turfgrass | Adequate soil moisture and favorable growing conditions enhance the performance of this product. |
| | Stress from high temperatures, drought, insects or diseases. | Avoid applications of this product when turfgrasses are under stress since injury may result. If dry conditions exist, schedule irrigations (watering) before and after the application. For best results, delay the irrigation until approximately 24 hours after application of this product. |
| Mowing: | | Delay mowing 2 days before and until 2 days after the application of this product. Do not use clippings from the treated areas as mulch or compost around flowers, ornamentals, trees, or in vegetable gardens. |
| Nontarget plants: | | Do not apply this product to food crops (gardens, fruits and vegetables), forage crops, or ornamental plants including flowers, trees, shrubs, hedges, woody ornamentals, groundcovers established in landscape plantings and other nontarget plants. Do not spray exposed roots of ornamentals and trees. |

The following claims may or may not appear on any label panel or in advertising. Appropriate formula and company specific information will be inserted on Final Printed Label to replace "X"

Efficacy Claims

1. [Also] Kills [Dandelion,] [Clover,] plus [XXX] other listed weeds*
2. [Also] Kills [Dandelion,] [Clover,] plus [XXX] other weeds as listed*
3. [Even] kills [controls] poison ivy and poison oak.
4. [Only] targets the weeds, leaving your lawn [grass] unharmed*
5. [Visible] [See] results in X hours
6. Gets to the root [of your weed problem]
7. Kills by contact
8. Kill [control] the most common weeds in your lawn [grass]**

Bold, italicized text is information for the reader and is not part of the label.

[Bracketed information is optional text]. Text separated by / denotes and/or options.

9. Kills [controls] [Dandelion,] [Clover,] and other common [lawn weeds] [weeds found in your lawn]**
 10. Kills [controls] [hard-to-control] [tough] weeds **
 11. Kills [controls] all types of [lawn] weeds [in your grass]**
 12. Kills [controls] broadleaf weeds [in lawns] **
 13. Kills [controls] [listed] weeds] **
 14. Kills [lawn] weeds [down] to the roots
 15. Kills [lawn] weeds down [to the roots]
 16. Kills to the root [so weeds won't come back]
 17. Kills weeds down to the root
 18. Kills weeds, not lawns™
 19. Results [works] with 1 [one] application
 20. Gentle on lawns [grass] tough on weeds!
 21. Simple [and easy] steps to a weed free [lawn] [yard]
 22. Starts working on contact
 23. Targets weeds invading your lawn [grass]
 24. Tough weed killer
 25. Won't harm grass*
 26. One [1] easy application for dollarweed, dandelions, and clover
 27. Kills/clears out/eliminates Dandelion(s) [and/Clover(s)] [for up to [x months/ 3 months/ a season/ x weeks / x days], [guaranteed]
 28. Clear[s] out weeds+ [for up to [x months/ a season/x weeks/x days], [guaranteed] (+dandelion and clover)]
 29. Control[s] weeds+ [for up to [x months/ 3 months/ a season/12 weeks/90 days], [guaranteed] (+ dandelion and clover)]
 30. Kill[s] weeds+ [for up to [x months/ 3 months /a season/12 weeks/90 days], [guaranteed] (+dandelion and clover)]
 31. Take[s] out weeds+ [for up to [x months/3 months/ a season/12 weeks/90 days], [guaranteed] (+dandelion and clover)]
 32. Eliminate(s) weeds+ [for up to [x months/ 3 months /a season/12 weeks/90 days], [guaranteed] (+dandelion and clover)]
 33. Apply once and you are done [with dandelions and clover][for up to][x months/3 months/ a season/12 weeks/90 days], [guaranteed]
 34. One step weed control [for dandelion and clover] for up to [x months/x weeks/ x days]
 35. One [1] [easy] solution for [your] total weed control needs
 36. Kills weeds, not lawns [with Lawn Guard™/ Lawn Protect™ technology]
 37. Use it now and you won't see weeds+ for up to [x months/3 months/ a season/12 weeks/90 days], [guaranteed] (+dandelion and clover)
 38. Kill(s) [lawn] weeds dead [to the root]
 39. Kill(s) the root(s)
- *when used as directed
**see inside [booklet] for weed list

Formula Claims

40. 3-way control
 41. [With] Lawn Guard™ [Lawn Protect™]
 42. Colorless [formula]
 43. Fast-acting [formula]
 44. For use on [many Northern & Southern] grasses [lawns] including XXXX
 45. Kill over [up to] XXX [lawn] weeds**
 46. Kills [controls] [over] [XXX+] [types of] weeds**
 47. Lawn Friendly*
 48. Non-staining
 49. Stain-free [formula]
 50. Systemic [herbicide] Activity
 51. Treats many Northern & Southern grass types [lawns]
 52. Lawn Guard™ formula kills weeds [leaving grass unharmed]
 53. Special/Exclusive Lawn Guard™ formula
 54. Lawn Guard™ formula kills weeds
 55. Lawn Control™
- *when used as directed
**see inside [booklet] for weed list

NOTE:

EPA Reg. No. 239-2760

Bold, italicized text is information for the reader and is not part of the label.

[Bracketed information is optional text]. Text separated by / denotes and/or options.

Characteristics

56. A simple and effective way to kill breakthrough and pop up weeds in our yard/lawn/grass
57. Easily [quickly] spot treat weeds
58. [Great] [Ideal] for spot treatment[s]
59. [Great] for spot treating [treatment[s]]
60. Spot weed control for Southern lawns
61. Target weeds
62. Designed for use on Southern lawns [warm season grasses/list approved grass types here.]
63. Water based

Weather & Speed

64. [See] results in hours
65. Overnight results
66. Rainproof – [for control that] won't wash away
67. Rainproof [rainfast] in [1] [X] hour[s]
68. Starts working immediately

Applicator Claims

69. Hands stay dry
70. No messy clean-up
71. One-handed operation [use] [spraying]
72. [Requires] no measuring, [no mixing]
73. [The] Easy way to spray
74. [Applicator name]
75. [Applicator name] refill
76. [One touch] [continuous spray] [Comfort] Wand
77. AA [brand name] batteries included
78. Adjustable [spray] nozzle [for maximum control]
79. Adjustable [spray] nozzle [for your custom needs]
80. Battery powered [sprayer]
81. Easy Action pump spray
82. Extended reach [illustration]
83. Extended Wand [for hard-to-reach areas]
84. No assembly required
85. No [more] hand fatigue [tired hands]
86. No more [bending] [kneeling] [or straining]
87. Precise control [target] [-spray only what you want]
88. Quick Pump [Pump N Go II] [Applicator]
89. Ready-To-Use
90. Refill
91. Refill [bottle] for [Applicator name]
92. Targets weeds in tight [hard to spray] spaces
93. XX minutes of continuous spray
94. Convenient [simple] design
95. Easy [and simple] to use
96. Quick & Easy [to use]
97. Save[s] time [and energy]
98. [2x] [XX%] Faster Application (Coverage)
99. Performs like a tank sprayer with no (without) pumping
100. Performs like a tank sprayer
101. Equal performance to a tank sprayer with no (without) pumping
102. Tank sprayer power with no (without) pumping
103. Tank sprayer power
104. Same coverage in [half the] [XX% less] time
105. [New & Improved]/[More Versatile] (Applicator Name) Treat(s)/Cover(s) the same area (XX%) faster*
106. [New & Improved]/[More Versatile] (Applicator Name) Sprays out (XX%) quicker/faster* *vs. [the] original Comfort Wand
107. Multi-tip nozzle
108. [Applicator Name] has 3 spray patterns for precise/[efficient]/[targeted]/[adjustable]/[exact] application
109. [Applicator Name] [with] Dual Tip Nozzle with Foam and/& Stream settings
110. [Applicator Name] [with] Wide & Narrow fan patterns



NOTE:

EPA Reg. No. 239-2760

Bold, italicized text is information for the reader and is not part of the label.

[Bracketed information is optional text]. Text separated by / denotes and/or options.

POP Claims

111. Value [pack/ size/buy]
112. Bonus [value/ size/offer/package/pack/buy]
113. Exclusive item [size]
114. Special [buy/offer/size/item]
115. Limited time offer
116. X% more than X size
117. Save [money]
118. [easy] Refill system
119. Free sample
120. X% more [free]
121. Combo pack
122. Refill [Size]
123. Great value
124. Bottle in [a] box
125. Premeasured [refill] [bottle]
126. Use with/in [insert product name] 1.33gal [1, 1.1gal] trigger/wand/pull & spray

General Claims

127. Hated by weeds, loved by lawns [grass/yards]
128. Kills all common lawn weeds[±] *as listed
129. Loved by lawns/grass/yards, [&/and] hated by weeds
130. Weeds Die, Grass Lives [with Lawn Guard™/ Lawn protect] [formula]
131. Save the grass [lawn/yard] [and kill the weeds]
132. Apply in spring, summer or fall
133. Apply when/anytime weeds are growing
134. Apply when/anytime you see weeds [in your yard/lawn/grass]
135. Weeds will die [within x days] [and stay away for x months/x weeks/ x days]
136. Look to/for Ortho
137. For all your [outdoor] Weed needs [look for Ortho]
138. Ortho has the solution for [all] your Weed needs
139. Ortho can help solve your weed [Control] needs

Other

140. Be in control of weeds in your yard
141. Before [illustration] / After [illustration]
142. For a beautiful [weed free] lawn
143. [For] [Get] a weed free lawn
144. Live a weed free life
145. For Home Lawn Care
146. For Home Lawn Use [only]
147. From the lawn care experts at Scotts /Ortho
148. From the pest experts at Scotts /Ortho
149. Guaranteed [results]*
150. Guaranteed not to harm the lawn*
151. Help[s] [keep[s]] the lawn look[ing] beautiful
152. Helps keep lawns weed free
153. Keep from freezing
154. Lawn friendly weed control*
155. Local solutions for local problems
156. New/Now (*The following claim may appear on any label panel for 6 months following commercial introduction*)
157. Ortho Guarantee
158. Ortho's #1 Weed Killer for Lawns
159. Ortho's simple weed killer
160. Proven performance
161. Read Entire label before use
162. [Recyclable symbol]

NOTE:

EPA Reg. No. 239-2760

Bold, italicized text is information for the reader and is not part of the label.

[Bracketed information is optional text]. Text separated by / denotes and/or options.

- 163. Gentle on lawns [guaranteed*]
 - 164. Takes the guesswork out of weed control [in the lawn]
 - 165. Weed control for your lawn
 - 166. Weed control made easy
 - 167. Weed free [worry free]
 - 168. Won't harm [the] lawn, guaranteed*
 - 169. XX% more than X gallon size
 - 170. XX less plastic
- *when used as directed

End of the READY TO USE section

RTS (Floratam)

DIRECTIONS FOR USE

It is a violation of Federal law to use this product in a manner inconsistent with its labeling. READ ENTIRE LABEL BEFORE USE.

PRECAUTIONS

- Spray entire lawn, wetting weeds and lawn grasses.
- To prevent product runoff, do not overwater the treated area to the point of runoff or apply when raining or when rain is expected that day.
- Allow 12 hours after application before watering lawn for maximum effectiveness on listed weeds.

USE RESTRICTIONS

- Do not apply this product in a way that will contact any person or pet, either directly or through drift. Keep people and pets out of the area during application.
- [Reentry Icon] Do not allow people or pets to enter the treated area until sprays have dried. 
- Do not exceed two applications per year with a minimum of 30 days between applications.
- Do not use this product for controlling weeds in flower or vegetable beds or around shrubs or ornamental plantings.
- Do not exceed directed rates because damage to turf may occur.
- Do not spray exposed roots of desirable plants.
- Do not exceed directed rates because damage to turf may occur.
- Do not apply directly to or near water, storm drains, gutters, sewers or drainage ditches.
- Do not apply within 25 feet of rivers, fish ponds, lakes, streams, reservoirs, marshes, estuaries, bays, and oceans.
- Do not apply when windy.
- Spray when air is calm to avoid spray drift that might injure desirable ornamental plants. Do not spray as a fine mist as injury to non-target plants may occur.
- Do not apply to newly seeded grasses until they have been mowed 3 times.
- Do not reseed for 4 weeks after use. If lawn needs watering, water thoroughly before application.
- Do not spray on Dichondra, Lippia, or on grasses where desirable Clovers are present.
- Do not apply when temperature exceeds 90°F.
- Do not apply if rain is expected within 24 hours of application.
- Do not apply more than 12.8 fl. oz. per 1,000 sq. ft. (0.183 lb ae 2,4-D, 0.044 lb ae mecoprop-p, 0.009 lb ae dicamba/Acre) per broadcast application. Do not make more than 2 applications per year. Allow at least 30 days between applications. Do not apply more than a total of 25.6 fl. oz. of product per 1,000 sq. ft (0.366 lb ae 2,4-D, 0.088 lb ae mecoprop-p, 0.018 lb ae dicamba/Acre) per year.

[HOW IT WORKS/PRODUCT INFORMATION:

WBG 555 RTU /Product Name/ this/the product [broadcast herbicide] contains three proven weed killers that target lawn weeds. This herbicide enters the lawn weeds through their leaves and moves throughout the plant to provide control. Lawns listed on this label will not be harmed when used as directed.]

NOTE:

EPA Reg. No. 239-2760

Bold, italicized text is information for the reader and is not part of the label.

[Bracketed information is optional text]. Text separated by / denotes and/or options.

WHERE TO USE /APPLY:

WBG 555 RTU /Product Name/ this/the product can be applied to residential lawns with the following turfgrass types:

| Lawns To Be Treated: | |
|---|-----------------------|
| Warm Season Turfgrass | Cool Season Turfgrass |
| St. Augustinegrass ¹ , including Floratam | Kentucky bluegrass |
| Bermudagrass, common and hybrid | Ryegrass |
| Centipedegrass | Tall fescue |
| Zoysiagrass | Fine fescue |
| Buffalograss | Bentgrasses |
| Bahiagrass | |
| ¹ Application to St. Augustinegrass (including Floratam) may cause temporary yellowing or discoloration but full recovery can be expected. | |

| DO NOT apply [WBG 555 RTU /Product Name/ this/the product] to the following: |
|--|
| Carpetgrass |
| Dichondra |
| Lippia |
| Gardens including vegetables, fruit trees, vines and berries |
| Ornamental plants (flowers, trees, groundcovers, landscape beds and shrubs) |
| Seashore paspalum |
| Turfgrass types that are not listed on this label. |

HOW MUCH TO USE /APPLY:

32 fl. oz. covers 2500 sq. ft. /xx fl oz covers xxxx sq ft

WHEN TO USE /APPLY:

Apply this product when weeds are small and actively growing in the spring or fall.

BROADLEAF WEEDS CONTROLLED / [KILLS WEEDS INCLUDING:]

Note to PM: Some or all of the following weeds will appear on the label.

| | | | |
|----------------------------|-------------------|---------------------|----------------------|
| Alder | Dead Nettle | Narrowleaf plantain | Spotted knapweed |
| Annual yellow sweet clover | Dock | Narrowleaf vetch | Spotted spurge |
| Artichoke | Dogbane | Nettle | Spurge |
| Aster | Dogfennel | Nutgrass | Spurweed |
| Austrian fieldcress | Elderberry | Orange hawkweed | Stinging nettle |
| Bedstraw | English daisy | Oxalis | Stinkweed |
| Beggartick | Fall dandelion | Oxeye daisy | Stichwort |
| Biden | False dandelion | Parsley-piert | Strawberry clover |
| Bindweed | False flax | Parsnip | Sumac |
| Bird vetch | False sunflower | Pearlwort | Sunflower |
| Bitterweed | Fiddleneck | Pennycress | Sweet clover |
| Bitter wintercress | Field bindweed | Pennywort | Tall nettle |
| Black-eyed Susan | Field pansy | Peppergrass | Tall vervain |
| Black medic | Flea bane (Daisy) | Pepperweed | Tansy mustard |
| Black mustard | Flixweed | Pigweed | Tansy ragwort |
| Blackseed plantain | Florida betony | Pineywoods bedstraw | Tanweed |
| Blessed thistle | Florida pusley | Plains coeopsis | Tarweed |
| Bloodflower | Frenchweed | Plantain | Thistle |
| Blue lettuce | Galinsoga | Poison hemlock | Tick trefoil |
| Blue vervain | Garlic mustard | Poison ivy | Toadflax |
| Box elder | Goathead | Poison oak | Trailing crown vetch |
| Bracted plantain | Goatsbeard | Pokeweed | Tumble mustard |
| Brassbuttons | Goldenrod | Poorjoe | Tumble pigweed |
| Bristly oxtongue | Ground ivy | Povertyweed | Tumbleweed |
| Broadleaf dock | Gumweed | Prickly lettuce | Velvetleaf |
| Broadleaf plantain | Hairy bittercress | Prickly sida | Venice mallow |
| Broomweed | Hairy fleabane | Primrose | Veronica |
| Buckhorn | Hawkweed | Prostrate knotweed | Vervain |

Bold, italicized text is information for the reader and is not part of the label.

[Bracketed information is optional text]. Text separated by / denotes and/or options.

| | | | |
|---------------------|--------------------|-----------------------|---------------------------|
| Buckhorn plantain | Healall | Prostrate pigweed | Vetch |
| Bulbous buttercup | Heartleaf drymary | Prostrate spurge | Virginia buttonweed |
| Bull nettle | Hedge bindweed | Prostrate vervain | Virginia creeper |
| Bull thistle | Hedge mustard | Puncture vine | Virginia pepperweed |
| Burdock | Hemp | Purslane | Wavyleaf bullthistle |
| Burning nettle | Henbit | Ragweed | Western clematis |
| Bur ragweed | Hoary cress | Red clover | Western salsify |
| Burweed | Hoary plantain | Redroot pigweed | White clover |
| Buttercup | Hoary vervain | Red sorrel | White mustard |
| Canada thistle | Honeysuckle | Redstem filaree | Wild mustard |
| Carolina geranium | Hop clover | Rough cinquefoil | Wild aster |
| Carpetweed | Horsenettle | Rough fleabane | Wild buckwheat |
| Catchweed bedstraw | Horsetail | Roundleafed marigold | Wild carrot |
| Catsear | Indiana mallow | Rush | Wild four-o'clock, |
| Catnip | Ironweed | Russian pigweed | Wild geranium |
| Chickweed | Jewelweed | Russian thistle | Wild lettuce |
| Chicory | Jimsonweed | St. Johnswort | Wild marigold |
| Cinquefoil | Kochia | Scarlet pimpernel | Wild parsnip |
| Clover | Knawel | Scotch thistle | Wild radish |
| Cockle | Knotweed | Sheep sorrel | Wild rape |
| Cocklebur | Lambsquarter | Shepherdspurse | Wild strawberry |
| Coffeebean | Lespedeza | Slender plantain | Wild sweet potato |
| Coffeeweed | Locoweed | Smallflower galinsoga | Wild vetch |
| Common chickweed | Lupine | Smartweed | Willow |
| Common mullein | Mallow | Smooth dock | Witchweed |
| Common sowthistle | Marshelder | Smooth pigweed | Woolly morningglory |
| Corn chamomile | Matchweed | Sneezeweed | Woodsorrel |
| Creeping Jenny | Mexicanweed | Southern wild rose | Woolly croton |
| Creeping Woodsorrel | Milk vetch | Sowthistle | Woolly plantain |
| Crimson clover | Milkweed | Spanishneedle | Wormseed |
| Croton | Mugwort | Spatterdock | Yarrow |
| Cudweed | Morningglory | Speedwell | Yellow Rocket |
| Curly dock | Mouseear chickweed | Spiny amaranth | Yellow Woodsorrel |
| Curly indigo | Musk thistle | Spiny cocklebur | Yellow flower pepperweed |
| Dandelion | Mustard | Spotted catsear | and other broadleaf weeds |

Directions For Use Option Based On Applicator

Option 1 - Ready-Spray® II

[Applicator (Device) (Applicator Name) Directions/Instructions]

HOW TO USE/APPLY:

Connect:

1. Connect sprayer to [garden] hose.
 2. Turn on water.
- [User Tip: Start at the farthest point in your yard and work back.]

Spray:

1. To BEGIN spraying, [Bend small plastic tab back and] move/turn/rotate/slide [color] switch/knob/lever/slider to ON [position].
2. Spray only until the surface of the lawn is wet. / Spray evenly. Container covers 2500 sq. ft.
3. [Spray as directed in the [How Much to Use]/[Section Header] [instructions]

Finish:

1. To STOP spraying move/turn/rotate/slide [color] switch/knob/lever/slider to "OFF" [position].
2. Turn off water.
3. Relieve water pressure by pressure by moving/turning/rotating/sliding [color] switch/knob/lever/slider to ON/WATER [position].
4. After water slows to a drip, move / turn / rotate / slide [color] switch /knob /lever / slider [back] to OFF [position].
5. Disconnect sprayer from [garden] hose.

[Optional illustrations may be used in conjunction with the above steps]

Bold, italicized text is information for the reader and is not part of the label.

[Bracketed information is optional text]. Text separated by / denotes and/or options.

Option 2 - Ready-Spray®

[Applicator (Device) (Applicator Name) Directions/Instructions]

HOW TO USE/APPLY:

- [Measure the total [entire] [lawn] area to be sprayed. For rectangular areas, multiply the length by width to obtain total square feet.]
- **Connect:** [illustration]
- Connect/Attach/Sprayer/bottle to end of hose
- Turn on water
- Extend hose to farthest area of lawn to be treated
- **Spray:** [illustration]
- To begin spraying, [disengage safety lock and] point nozzle in the direction you want to spray.
- Slide thumb activation switch forward to ON position.
- Spray evenly over measured area
- **Finish:** [illustration]
- To STOP spraying, slide thumb activation switch backward to OFF position.
- Turn off water.
- Relieve water pressure by sliding thumb switch to ON [WATER] [WATER ONLY] position until water slows to a drip. Then, slide switch back to OFF position [and engage safety lock].
- Disconnect the sprayer from hose.

STORAGE & DISPOSAL

PESTICIDE STORAGE: Keep from freezing. To be stored in original container and placed in areas inaccessible to children.

PESTICIDE DISPOSAL AND/CONTAINER HANDLING: Nonrefillable container. Do not reuse or refill this container.

If empty: Place in trash or offer for recycling if available. **If partly filled:** Call your local solid waste agency for disposal instructions. Never place unused product down any indoor (including toilet) or outdoor (including sewer) drain.

OPTIONAL MARKETING CLAIMS

The following Product Facts format is optional and the information may appear inside or outside of a box.

PRODUCT FACTS:

[What It Does:] Kills major broadleaf weeds including dollarweed, dandelion, chickweed and clover. (See inside [booklet] for complete/weed list)

[Where to Use/Apply:] Lawns: Kills the weeds not the lawn when used as directed. [icon weeds]

[When to Use/Apply:] Apply when daytime temperatures are below 90°F.

Questions & Comments: [icon phone] [icon computer] Call 1-800-225-2883 or [Visit our Website] at www.ortho.com

USE TIPS:

| | | |
|-----------------------|--|--|
| When to Apply: | For established lawns | Apply when daytime temperatures are below 90°F. |
| | For newly seeded areas | Apply this product to newly seeded grasses when well-established (approximately 6 weeks after seedling emergence) or after the third mowing. |
| | For newly sodded, sprigged, or plugged areas | Apply this product 3 to 4 weeks after the sodding, sprigging, or plugging operations. |
| Seeding: | The treated area can be seeded at 4 weeks after the application of this product. | |
| Irrigation: | Non-stressed turfgrass | Adequate soil moisture and favorable growing conditions enhance the performance of this product. |

Bold, italicized text is information for the reader and is not part of the label.

[Bracketed information is optional text]. Text separated by / denotes and/or options.

| | | |
|--------------------------|---|---|
| | Stress from high temperatures, drought, insects or diseases. | Avoid applications of this product when turfgrasses are under stress since injury may result. If dry conditions exist, schedule irrigations (watering) before and after the application. For best results, delay the irrigation until approximately 24 hours after application of this product. |
| Mowing: | | Delay mowing 2 days before and until 2 days after the application of this product. Do not use clippings from the treated areas as mulch or compost around flowers, ornamentals, trees, or in vegetable gardens. |
| Nontarget plants: | | Do not apply this product to food crops (gardens, fruits and vegetables), forage crops, or ornamental plants including flowers, trees, shrubs, hedges, woody ornamentals, groundcovers established in landscape plantings and other nontarget plants. Do not spray exposed roots of ornamentals and trees. |

The following claims may or may not appear on any label panel or in advertising. Appropriate formula and company specific information will be inserted on Final Printed Label to replace "X"

Efficacy Claims

1. [Also] Kills [Dandelion,] [Clover,] plus [XXX] other listed weeds*
 2. [Also] Kills [Dandelion,] [Clover,] plus [XXX] other weeds as listed*
 3. [Even] kills [controls] poison ivy and poison oak.
 4. [Only] targets the weeds, leaving your lawn [grass] unharmed*
 5. [Visible] [See] results in X hours
 6. Gets to the root [of your weed problem]
 7. Kills by contact
 8. Kill [control] the most common weeds in your lawn [grass]**
 9. Kills [controls] [hard-to-control] [tough] weeds**
 10. Kills [controls] all types of [lawn] weeds [in your grass]**
 11. Kills [controls] broadleaf weeds [in lawns]**
 12. Kills [controls] [listed weeds]**
 13. Kills [lawn] weeds [down] to the roots
 14. Kills [lawn] weeds [to the roots]
 15. Kills to the root [so weeds won't come back]
 16. Kills weeds down to the root
 17. Kills weeds, not lawns™
 18. Results [works] with 1 [one] application
 19. Gentle on lawns [grass] tough on weeds!
 20. Simple [and easy] steps to a weed free [lawn] [yard]
 21. Starts working on contact
 22. Targets weeds invading your lawn [grass]
 23. Tough weed killer
 24. Won't harm grass*
 25. One [1] easy solution/application for dollarweed, dandelions, and clover
 26. For use on St. Augustine Grass [including Floratam]
 27. For use on most lawn [grass] [types/varieties] [as listed]
 28. Gentle on [For use on] Floratam
 29. Gentle on [For use on] Southern lawns
- *when used as directed
**see inside [booklet] for weed list

Formula Claims

30. 3-way control
31. [With] Lawn Guard™ [Lawn Protect™]
32. Colorless [formula]
33. Fast-acting [formula]
34. For use on [many Northern & Southern] grasses [lawns] including XXXX
35. Kill over [up to] XXX [lawn] weeds**
36. Kills [controls] [over] [XXX+] [types of] weeds**
37. Lawn Friendly*

NOTE:

EPA Reg. No. 239-2760

Bold, italicized text is information for the reader and is not part of the label.

[Bracketed information is optional text]. Text separated by / denotes and/or options.

38. Non-staining
39. Stain-free [formula]
40. Systemic [herbicide] Activity
41. Treats many Northern & Southern grass types [lawns]
**see inside [booklet] for weed list

Characteristics

42. [Easily] covers large areas
43. 1 bottle [quart] treats [up to] XXXX square feet
44. [Great] [Ideal] for broadcast treatment[s] [application[s]]
45. [Great] value [-use to cover small or large areas]
46. One [1] [bottle size] covers up to XXXX square feet
47. Covers [treats up to] XXXX square feet
48. Designed for use on Southern lawns [warm season grasses/list approved grass types here]
49. Water based

Weather & Speed

50. [See] results in hours
51. Overnight results
52. Rainproof – [for control that] won't wash away
53. Rainproof [rainfast] in [1] [X] hour[s]
54. Starts working immediately

Applicator Claims

55. Hands stay dry
56. No messy clean-up
57. One-handed operation [use] [spraying]
58. [Requires] no measuring, [no mixing]
59. [The] Easy way to spray
60. [Ergonomic] [Comfort] grip [handle]
61. [Simply] attach to [garden] hose and spray [go]
62. Easy [Simple] attach [to [garden] hose]
63. Includes water [only] setting
64. One step prep
65. Ready-Spray®/Ready To Spray/Applicator name
66. [Applicator name]
67. Convenient [simple] design
68. Easy [and simple] to use
69. Quick & Easy [to use]
70. Save[s] time [and energy]

POP Claims

71. Value [pack/ size/buy]
72. Bonus [value/ size/offer/package/pack/buy]
73. Exclusive item [size]
74. Special [buy/offer/size/item]
75. Limited time offer
76. X% more than X size
77. Save [money]
78. Free sample
79. X% more [free]
80. Combo pack
81. Great value
82. Bottle in [a] box

General Claims

83. Hated by weeds, loved by lawns [grass/yards]
84. Kills all common lawn weeds
85. Loved by lawns, [&/and] hated by weeds
86. Weeds Die, Grass Lives [with Lawn Guard™] [formula]

NOTE:

EPA Reg. No. 239-2760

Bold, italicized text is information for the reader and is not part of the label.

[Bracketed information is optional text]. Text separated by / denotes and/or options.

87. Save the grass [lawn/yard] [and kill the weeds]
88. Apply in spring, summer or fall
89. Apply when/anytime weeds are growing
90. Apply when/anytime you see weeds [in your yard/lawn/grass]
91. Apply early [for best results]
92. Weeds will die [within x days]
93. [For best results/ complete lawn control], use with [insert Ortho/Scotts product line]
94. Look to/for Ortho
95. For all your [outdoor] Weed needs [look for Ortho]
96. Ortho has the solution for [all] your Weed needs
97. Ortho can help solve your weed [Control] needs

Other

98. Be in control of weeds in your yard
 99. Before [illustration] / After [illustration]
 100. For a beautiful [weed free] lawn
 101. [For] [Get] a weed free lawn
 102. Live a weed free life
 103. For Home Lawn Care
 104. For Home Lawn Use [only]
 105. From the lawn care experts at Scotts /Ortho
 106. From the pest experts at Scotts /Ortho
 107. [Satisfaction] Guaranteed [results]†
 108. Guaranteed not to harm the lawn*
 109. Help[s] [keep[s]] the lawn look[ing] beautiful
 110. Helps keep lawns weed free
 111. Keep from freezing
 112. Lawn friendly weed control*
 113. Local solutions for local problems
 114. New/Now (*The following claim may appear on any label panel for 6 months following commercial introduction*)
 115. Ortho Guarantee
 116. Ortho's #1 Weed Killer for Lawns
 117. Ortho's [Our] weed killer for lawns
 118. Ortho's simple weed killer
 119. Proven performance
 120. Read Entire label before use
 121. [Recyclable symbol]
 122. Gentle on lawns [guaranteed*]
 123. Takes the guesswork out of weed control [in the lawn]
 124. Weed control for your lawn
 125. Weed control made easy
 126. Weed free [worry free]
 127. Won't harm [the] lawn, guaranteed*
 128. XX less plastic
- *when used as directed

End of the RTS (Floritam) section

Optional Instructions for Side Clip Tape

PULL / PEEL HERE [TO REMOVE TAPE]

Open Resealable Label For Directions and/ & Precautions

Press to Reseal

Questions & Comments: [icon phone] [icon computer]  

Call 1-800-225-2883 or [Visit our Website at www.ortho.com]

NOTICE: To the extent consistent with applicable law, the buyer assumes all risks of use, storage or handling of this product not in accordance with label directions.

†The ORTHO Guarantee



If for any reason you, the consumer, are not satisfied with this product, mail us your original proof of purchase to obtain a full refund of your purchase price.

NOTE:

EPA Reg. No. 239-2760

Bold, italicized text is information for the reader and is not part of the label.

[Bracketed information is optional text]. Text separated by / denotes and/or options.

Ortho and Your Environment – Your yard is a place for family and pets to enjoy. That’s why Ortho products are designed with care to provide effective solutions to weed problems. Please follow instructions for appropriate usage, storage and disposal.

Manufactured for / Distributed for/by / Sold by:
The Ortho Group
P.O. Box 190
Marysville, OH 43040

EPA Reg. No. 239-2760
EPA Est. No. XXXX-XXX
[Superscript is first letter of lot number]

[Product of / Made in U.S.A.]
© 20XX The Ortho Group, World rights reserved.

Example Graphics

The following are representative examples of graphics that may be used on the market label. If the graphic is used, minor changes to the exact color, shapes or orientation of items depicted, or the amount or size of graphic may occur based on marketing decisions and the available space on the label.

