

239-2516

6.10.2003

1/6

Please read instructions on reverse before completing form.

Form Approved. OMB No. 2070-0060, Approval expires 2-28-95



United States  
Environmental Protection Agency  
Washington, DC 20460

<input type="checkbox"/>	Registration
<input type="checkbox"/>	Amendment
<input checked="" type="checkbox"/>	Other

OPP Identifier Number

**Application for Pesticide - Section I**

1. Company/Product Number 239-2516	2. EPA Product Manager Jim Tompkins	3. Proposed Classification <input checked="" type="checkbox"/> None <input type="checkbox"/> Restricted
4. Company/Product (Name) ORTHO Fence & Grass Edger Formula II	PM# 25	
5. Name and Address of Applicant (Include ZIP Code) The Scotts Company d/b/a The ORTHO Group 14111 Scottslawn Rd Marysville, OH 43041 <input type="checkbox"/> Check if this is a new address		6. Expedited Review. In accordance with FIFRA Section 3(c)(3) (b)(i), my product is similar or identical in composition and labeling to: EPA Reg. No. _____ Product Name _____

**Section - II**

<input type="checkbox"/> Amendment - Explain below.	<input checked="" type="checkbox"/> Final printed labels in response to Agency letter dated _____
<input type="checkbox"/> Resubmission in response to Agency letter dated _____	<input type="checkbox"/> "Me Too" Application.
<input checked="" type="checkbox"/> Notification - Explain below.	<input type="checkbox"/> Other - Explain below.

**NOTIFICATION**  
JUN 10 2003

**Explanation:** Use additional page(s) if necessary. (For section I and Section II.)

The ORTHO Group is submitting a notification of "Alternate Brand Name" and "Other Revisions" per PR Notice 98-10. This notification is consistent with the provisions of PR Notice 98-10 and EPA regulations at 40 CFR 152.46, and no other changes have been made to the labeling or the confidential statement of formula of this product. I understand that it is a violation of 18 U.S.C. Sec. 1001 to willfully make any false statement to EPA. I further understand that if this notification is not consistent with the terms of PR Notice 98-10 and 40 CFR 152.46, this product may be in violation of FIFRA and I may be subject to enforcement action and penalties under sections 12 and 14 of FIFRA.

**Section - III**

1. Material This Product Will Be Packaged In:				2. Type of Container	
Child-Resistant Packaging <input type="checkbox"/> Yes <input checked="" type="checkbox"/> No	Unit Packaging <input checked="" type="checkbox"/> Yes <input type="checkbox"/> No	Water Soluble Packaging <input type="checkbox"/> Yes <input checked="" type="checkbox"/> No		<input type="checkbox"/> Metal	<input checked="" type="checkbox"/> Plastic
* Certification must be submitted		If "Yes" Unit Packaging wgt. No. per container	If "Yes" Package wgt No. per container	<input type="checkbox"/> Glass	<input type="checkbox"/> Paper
3. Location of Net Contents Information <input checked="" type="checkbox"/> Label <input type="checkbox"/> Container		4. Size(s) Retail Container		5. Location of Label Directions	
6. Manner in Which Label is Affixed to Product <input type="checkbox"/> Lithograph <input type="checkbox"/> Paper glued <input type="checkbox"/> Stenciled				<input type="checkbox"/> Other _____	

**Section - IV**

1. Contact Point (Complete items directly below for identification of individual to be contacted, if necessary, to process this application.)					
Name Charles T. Levey		Title Manager, Federal Registrations		Telephone No. (Include Area Code) 937-644-7693	
<b>Certification</b> I certify that the statements I have made on this form and all attachments thereto are true, accurate and complete. I acknowledge that any knowingly false or misleading statement may be punishable by fine or imprisonment or both under applicable law.					6. Date Application Received (Stamped)
2. Signature 		3. Title Manager, Federal Registrations			
4. Typed Name Charles T. Levey		5. Date June 3, 2002			

**The Scotts Company**

and Subsidiaries



June 3, 2003

Mr. Jim Tompkins  
U.S. Environmental Protection Agency  
Office of Pesticide Programs  
Registration Division, H7505C  
Ariel Rios Building  
1200 Pennsylvania Ave., N.W.  
Washington, DC 20460

Subject: Label notification for ORTHO Fence & Grass Edger Formula II, EPA Reg. No. 239-2516

Dear Mr. Tompkins:

- 1) Please find enclosed one (1) copy of a final printed label for the subject product. We are forwarding via notification claim revisions and an alternate brand name. The alternate brand name is 'ORTHO Season-Long Grass & Weed Killer RTU. These changes/revisions are in compliance with PR Notice 98-10 and a certification has been documented on the 8570-1 form (enclosed).

I have enclosed the following documents:

- 1) Application Form 8570-1 for EPA Reg. No. 239-2516.
- 2) One copy of the final printed label.

I have highlighted the changes on the enclosed label to expedite your review. Please call me at 937-644-7696, if you have any questions regarding this submission. Thank you in advance for your cooperation.

Sincerely,



The Scotts Company  
Charles T. Levey  
Manager, Federal Registrations

**NEW!**

**ORTHO<sup>®</sup>**

NOTIFICATION  
JUN 16 2003

# SEASON-LONG GRASS & WEED KILLER

READY-TO-USE

**ONE APPLICATION KILLS &  
PREVENTS ALL SEASON**

*For Driveways,  
Sidewalks, Patios &  
Mulched Areas*

*On Driveways,  
Sidewalks & Patios*



*In Mulched  
Areas*



Active Ingredients  
Glyphosate, isopropylamine salt . . . . . 0.25%  
Oxyfluorfen . . . . . 0.25%  
Other Ingredients . . . . . 99.50%

**KEEP OUT OF REACH OF CHILDREN**

**CAUTION** See back panel for additional  
precautionary statements.

**NET 1.33 GAL / 5 L**



0400-000-1

4/6

# ORTHO SEASON-LONG GRASS & WEED KILLER

ORTHO Season-Long Grass & Weed Killer is specially formulated to kill and prevent weeds and grasses all season. For weeds in the lawn use Ortho Weed-B-Gon.

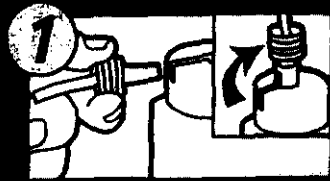

- Reverse sprayer from side to front and turn nozzle up.
- Turn nozzle up as end of nozzle moves.
- Flip up spout, spray nozzle remain up while spraying.

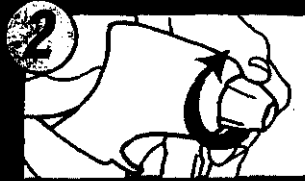

- Twist nozzle at end of sprayer to desired spray pattern (narrow, medium or wide stream).

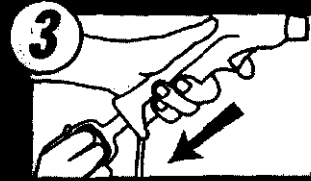

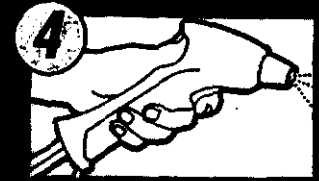

- Point sprayer away from body.
- Grasp sprayer by the middle.
- **SLOWLY** pull trigger at bottom of sprayer handle until you hear and feel for 2 seconds to ready the sprayer.



- Press and hold button on sprayer to begin spraying.
- Pull ring at sprayer bottom again as needed to continue spraying.

## PRODUCT FACTS Treats up to 266 sq ft.

<b>KILLS WEEDS</b>	Unwanted weeds & grasses	
<b>PREVENTS WEEDS</b>	For up to 4 months	
<b>WHERE TO USE</b>	<ul style="list-style-type: none"> <li>• Driveways, sidewalks, patios, curbs and gutters</li> <li>• Along fences</li> <li>• In landscaped areas (except vegetable gardens)</li> </ul>	 <b>FOR OUTDOOR USE ONLY</b>

DO NOT USE ON OR AROUND EDIBLE FEED OR FOOD CROPS.

## DIRECTIONS FOR USE

It is a violation of Federal law to use this product in a manner inconsistent with its labeling.

## WHERE TO USE

Apply only where no vegetation is desired, such as driveways, landscaped areas, around trees and shrubs, along fences, sidewalks, walkways, patios, curbs, gutters and even cracks in sidewalks. **DO NOT USE IN VEGETABLE GARDENS. DO NOT USE IN LAWNS.**

## WHEN TO APPLY

Apply to actively growing weeds and grasses. Visible effects will occur within one week with complete kill in 2 to 4 weeks. If rainfall occurs within 6 hours, repeat treatment may be required. To avoid drift to desirable plants, apply only when air is calm. If leaves of desirable plants are accidentally sprayed, immediately wash off plants with water.

## HOW TO APPLY/USE

- Follow illustrations and instructions above.
1. For best results pull out slowly and hold for 2 seconds.
  2. Spray to thoroughly cover unwanted weeds and grasses or spray to thoroughly cover areas where you want to prevent weed and grass growth.
  3. Do not spray plants or grasses you like - they may die too.
  4. When treating around desirable plants, shield plants from drift with a sheet of cardboard or plastic. If desirable plants are accidentally sprayed, rinse off immediately with water.

## WEEDS CONTROLLED

**NOTE:** For best control, apply to actively growing, immature weeds. Heavy lawn grass or well-established, difficult-to-control perennial weeds, such as Bermudagrass, nimblewill, dandelion, or Canada thistle, may require a repeat application if regrowth occurs.

**GRASSES:** Bahiagrass, bentgrass, Bermudagrass, bluegrass, bromegrass, crabgrass, creeping bentgrass, diffuse lovegrass, fescue, Johnsongrass, maiden cane, orchardgrass, perennial ryegrass, quackgrass, sandspur, St. Augustinegrass, tall fescue, torpedograss, whitetop, wild barley, yellow nutgrass, zoysia

**BROADLEAF WEEDS:** Bindweed, black medic, blue toadflax, brassbuttons, broadleaf plantain, bur clover, Canada thistle, chickweed, common groundsel, common plantain, creeping beggarweed, creeping Charlie, curly dock, dandelion, dog fennel, evening primrose, false dandelion, fennel, fiddleneck, filaree, Florida pusley, garden spurge, henbit, knotweed, lambsquarters, little bitter cress, London rocket, mallow, Mayweed, mouseear chickweed, nimblewill, oldenlandia, oxalis, Pennsylvania smartweed, pennywort, prostrate spurge, primrose, puncture vine, ragweed, shepherdspurge, smooth cat's ear, sowthistle, spotted spurge, tansy ragwort, white clover, wild morningglory

## STORAGE & DISPOSAL

**STORAGE:** Keep from freezing. Keep pesticide in original container. Do not put concentrate or dilute into food or drink containers. Avoid contamination of feed and foodstuffs. Store in a cool, dry place, preferably in a locked storage area. **DISPOSAL: If empty:** Do not reuse this container. Place in trash or offer for recycling if available. **If partly filled:** Call your local solid waste agency or 1-800-CLEANUP for disposal instructions. Never place unused product down any indoor or outdoor drain.

## PRECAUTIONARY STATEMENTS

### HAZARDS TO HUMANS & DOMESTIC ANIMALS

**CAUTION:** Causes moderate irritation. Avoid contact with eyes or clothing. Wash thoroughly with soap and water after handling.

**FIRST AID: IF IN EYES:** Hold eye open and rinse slowly and gently with water for 15-20 minutes. Remove contact lenses, if present, after the first 5 minutes, then continue rinsing eye. Call a poison control center or doctor for treatment advice. Have the product container or label with you when calling a poison control center or doctor, or going for treatment.

**Note to Physicians:** Emergency Information - call 1-800-225-2883

**ENVIRONMENTAL HAZARDS:** Do not apply directly to water. Do not contaminate water when disposing of equipment washwaters.

**NOTICE:** Buyer assumes all risks of use, storage or handling of this product not in accordance with directions.

**THE ORTHO GUARANTEE:** If for any reason you are not satisfied with this product, mail us proof of purchase to obtain a full refund of your purchase price.

 **Questions, Comments or Medical Information?**  
 Call 1-800-225-2883  [www.ortho.com](http://www.ortho.com)

© 2003. Licensed by The ORTHO Group. World rights reserved.  
 Manufactured for The ORTHO Group  
 P.O. Box 190, Marysville, OH 43040  
 Form LB000000000  
 EPA Reg. No. 239-2516, EPA Est. 239-1A-31, 58996-MO-1A  
 Superscript is first letter of lot number. Made in USA



85% SIZE  
 12-digit UPC  
 (non-suppressed)  
 For Position Only

10 71549 04310 2

060203

1025

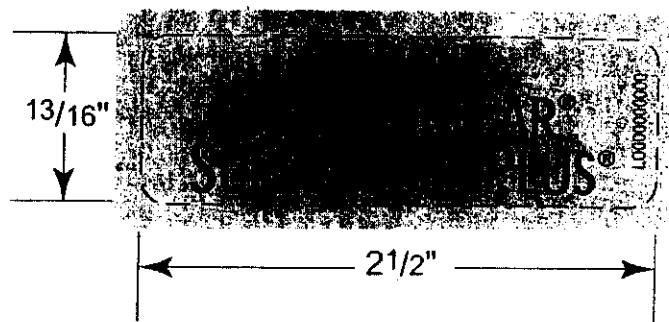
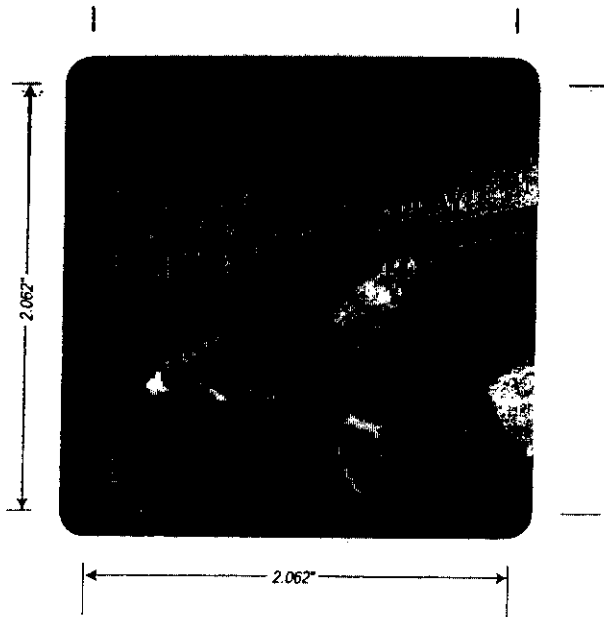

3.25"



3"