



1 Tesla Road  
Austin TX, 78725  
May 4, 2026

Mr. Daniel Cullen  
Vehicle Programs and Compliance Division  
Environmental Protection Agency  
2000 Traverwood Drive,  
Ann Arbor, MI 48105

**Subject: Request for issuance of a revised Certificate of Conformity - Running Change (adding a new carline)**

Tesla, Inc. requests that the EPA issue a Certificate of Conformity for the subject test group.

Attached to this request is the Part 1 Application. Tesla believes that the test group complies with all applicable regulations contained within Title 40 of the CFR, California Amendments to Subparts B, C, and S, Part 86 and Part 88, Title 40 of the CFR and Title 13 of the California Code of Regulations

**Vehicle Classification:** Light Duty Vehicle

**Test Group Identification:** TTSLV00.0L23

L - Lithium Ion Battery  
2 - Dual Motor  
3 - Model 3

**Test Group Description:** Tesla, Inc. differentiates test groups based on: Battery technology, the capacity and voltage of the battery, and the type and size of the electric motor. Using good engineering judgment to combine vehicles in test groups for the purposes of certification.

**Carline(s) covered by this certificate:** Model 3 Premium AWD  
Model 3 Performance  
Model 3 Performance AWD  
Model 3 Premium AWD-I

**Durability Group (EV-CIS):** TTSLEEVN23

**Durability and Emission Testing Requirements:** This is an electric vehicle application. As per § 86.1829-15(f), certification of this vehicle complies with all the emission standards and related requirements of the subpart. Tailpipe emissions of regulated pollutants from vehicles powered solely by electricity are deemed to be zero.

**Evaporative/Refueling and Leak Families:** N/A  
**OBD Group:** N/A

**Applicable Standards:** FEDERAL Tier 3 BIN 0 & CALIFORNIA ZEV

Your early review and issuance of the certificate will be greatly appreciated. If you have any questions, please contact me at our office at (510) 249-3755

Sincerely,

Suraj Nagaraj  
Sr. Director, Safety & Homologation Engineering

## Table of Contents

### **01.00.00 - Communications**

01.01.00 - Correspondence Information

01.01.01 - Mailing Address

01.01.02 - Manufacturer Representatives

01.01.03 - Agent of Service

### **02.00.00 - Vehicle Identification & Description**

02.01.00 - Identification of Vehicle

02.02.00 - Projected Sales Volume (Confidential)

02.03.00 - Propulsion System

02.03.01 - Drive Unit

02.03.02 - Motor

02.03.03 - Inverter

02.03.04 - Transmission

02.04.00 - Energy Storage System

02.04.01 - Battery

02.05.00 - Climate Control System

02.05.01 - Air Conditioning

02.05.02 - Heat pump

02.05.03 - Fuel-fired Heater

02.06.00 - Charging System

02.06.01 - On-board Charger Capability

02.06.02 - Maximum Allowable DC Capability

02.06.03 - Vehicle Connector Specification

02.06.04 - Charging Cord

02.06.05 - HPC Charging Cord

02.06.06 - Regenerative Braking System

### **03.00.00 - Test Results and Procedures**

03.01.00 - Vehicle Configuration and Subconfigurations

03.02.00 - Test Results

03.03.00 - Break-in Procedures

03.03.01 - Battery Pre-conditioning Procedures

03.04.00 - Test Procedures

### **04.00.00 - Statement of Compliance**

### **06.00.00 - Labels**

06.01.00 - Label Locations

06.02.00 - Sample Labels

### **07.00.00 - Vehicle Safety and Manuals**

07.01.00 - Owner's Manual

07.02.00 - Information on Safe Handling of Battery System

07.02.01 - Description of Warning System(s) for Maintenance / Malfunction

07.02.02 - Cut-off Terminal Voltages for Prevention of Battery Damage

07.03.00 - Information on Emergency Procedures

07.04.00 - Information on Battery Recycling

07.05.00 - Maintenance

07.05.01 - Test Vehicle Scheduled Maintenance

07.05.02 - Recommended Customer Maintenance Schedule

### **08.00.00 - General Technical Description**

08.01.00 - Description of Dyno Mode

08.02.00 - Description of Coastdown Mode

08.03.00 - Starting and Shifting Schedules

08.03.01 - Starting

08.03.02 - Shifting

**01.00.00 - Communications**

**01.01.00 - Correspondence Information**

**01.01.01 - Mailing Address**

Tesla, Inc.  
1 Tesla Road  
Austin, TX 78725

**01.01.02 - Manufacturer Representatives**

**Primary Contact**

Mr. Suraj Nagaraj, Sr. Director, Safety & Homologation Engineering

**Additional Contacts**

Mr. Sandeep Pannu, Manager - Global Homologation, Safety & Homologation Engineering

Mr. Shakil Savji, Sr. Homologation Engineer, Safety & Homologation Engineering

## **02.00.00 - Vehicle Identification & Description**

### **02.01.00 - Identification of Vehicle**

This is an electric vehicle, designated as a Zero-emission Vehicle (ZEV)

### **02.02.00 - Projected Sales Volume (Confidential)**

### **02.03.00 - Propulsion System**

#### **02.03.01 - Drive Unit**

##### **Front Drive Unit:**

Motor x 1,  
Inverter,  
Fixed ratio transmission

##### **Rear Drive Unit:**

Motor x 1,  
Inverter,  
Fixed ratio transmission

#### **02.03.02 - Motor**

##### **Front motor:**

3-phase AC internal induction motor

##### **Rear motor:**

3-phase AC permanent magnet motor

#### **02.03.03 - Inverter**

The drive inverter performs several critical functions including torque control, power and torque limit enforcement, and status monitoring.

#### **02.03.04 - Transmission**

The transmission is a fixed ratio, mechanical, transversely mounted gearbox with integral final drive (transaxle configuration).

The shift position is available on the center screen or on the overhead selector. There are four shift positions - one reverse, one drive, one neutral, and one park position. Selecting either forward or reverse position enables drive current to the motor to generate the appropriate torque. There is no physical reverse gear needed. In addition, the park button is used to operate the electrically-actuated park brake.

### **02.04.00 - Energy Storage System**

#### **02.04.01 - Battery**

The battery pack is manufactured with battery modules packed with battery cells, achieving excellent energy density and enabling the long range capability of the vehicle. The low-profile flat packaging enables an efficient and functional occupant area. The battery control system consists of the Battery Monitoring System (BMS) which controls the switches, measures pack current and voltages, electrical isolation of the battery from chassis ground and monitors cell voltages and module temperatures from the Battery Monitor Boards (BMBs) installed on each of the modules.

The battery thermal management system regulates the temperature of the coolant to maintain optimal conditions for the battery, thereby enhancing charging efficiency, overall performance, and durability. Proper temperature regulation is crucial because it ensures that the battery operates within its ideal temperature range, preventing both overheating and overcooling.

### **02.05.00 - Climate Control System**

The climate control modes include Defrost, Panel and Floor (or any combination of these three). The system consists of two panel vents, two front row floor vents, defroster vent, second row floor vents, second row console vents with positive air shut off and turning vane manual control.

Vehicle Controller printed circuit boards activate actuators and responds to evaporator air outlet temperature sensor, heat pump condenser outlet temperature sensor and air duct temperature sensors, as well as user demands from center display.

### **02.05.01 - Air Conditioning**

The air conditioner system is an R1234yf refrigerant consists of a high voltage electric scroll type with integrated inverter with High Voltage Interlock Loop.

### **02.05.02 - Heat pump**

The heater element for the vehicle is a heat pump, which draws HV electrical energy from the battery pack High Voltage. Tesla's heat pump reduces the energy required by the HVAC system in both heating and cooling scenarios. A heat pump consumes a small amount of electrical energy to thermodynamically "upgrade" low-temperature (less useful) thermal energy to higher-temperature (more useful) thermal energy, making it suitable for occupant comfort.

Tesla's system enables the heat pump source to be either the power-train coolant loop, e.g., low-temperature waste heat produced naturally by the vehicle while driving, ambient air, the battery thermal mass, the cabin thermal mass, or combinations thereof. Another advantage of this architecture is the ability to reject heat into the battery pack via a liquid-cooled condenser for a limited amount of time during cabin cooling scenarios when the temperature of the battery is modest. Therefore, for most startups with AC on, the relatively cool, well-coupled, large thermal mass serves to lower discharge pressure and therefore reduces compressor input power relative to a conventional air-cooled condenser setup.

Tesla's heat pump system also provides ways to remove a cabin air high voltage PTC heater completely by using the compressor as an electrical heater in specific scenarios. In fact, the electrical power draw capability of the compressor significantly exceeds a typical HV cabin PTC heater capability. This last point is accomplished via Tesla's unique architecture – the cycle is configured in such a way to provide a controlled environment for the compressor, regardless of ambient conditions, and ultimately unlocks the full electrical input power. Therefore, Tesla's thermal system can sometimes operate like a heat pump (heat efficiently) and sometimes like an electrical heater when heat pump capacity is not sufficient for comfort – using the same compressor.

### **02.05.03 - Fuel-fired Heater**

Not applicable

### 02.06.00 - Charging System

The charging system in the vehicle works in conjunction with either of the three external charging stations; Universal Mobile Connector (UMC), High Power Connector (HPC), or DC Fast Charging (Supercharger). The charging system adjusts automatically to the available AC line voltage, frequency and current, within limits.

Anytime the EV Inlet door is opened, the vehicle will prepare to enter CHARGE state. Once the user connects either supply cable to the vehicle, the charging system signals to the vehicle that it is ready to deliver the charge. The vehicle locks the cable onto the vehicle and then indicates that it is ready to accept energy and charging will commence. Failure of any of these steps will result in fault condition and lack of **full charging capability**. Vehicle could still charge on low power if handle lock is not engaged.

#### Prepare to charge state



#### Low Power Charging Indication



#### High Power Charging Indication



If the battery temperature is near or below freezing temperatures, normal charging will not occur. The vehicle will identify this condition and will begin heating the battery coolant and circulating the coolant to raise the battery temperature to enable charge. When the pack temperature rises to a temperature within the allowable charging range, heating will reduce or stop and charging will commence.

### 02.06.01 - On-board Charger Capability

The vehicle is equipped with one on-board charger, also known as a Power Conversion System (PCS), and is capable of a maximum of 11.5 kW.

### 02.06.02 - Maximum Allowable DC Capability

The vehicle's energy storage system is capable of accepting DC fast charge up to 250 kW from an off-board charger (Supercharger).

### 02.06.03 - Vehicle Connector Specification

The design and specification files are available within SAE J3400 RP.

The document covers the general physical, electrical, functional, safety, and performance requirements for conductive power transfer to an electric vehicle using a coupler, which can be hand-mated and is capable of transferring either DC or AC single-phase power using two current-carrying contacts.



#### Alternative for AC Charger Inlet: J1772 Adapter

<https://shop.tesla.com/product/sae-j1772-charging-adapter>



#### Alternative Option for DC Charger: CCS1 Adapter

<https://shop.tesla.com/product/ccs-combo-1-adapter>



## 02.06.04 - Charging Cord

**Universal Mobile Connector (UMC)** - The universal mobile connector is an individual cable that connects the vehicle to any available domestic power outlet and can deliver current to a maximum of 32A. The UMC has a length of 20ft, with dual amperage capability compatible with AC Level 1 and Level 2 charging. NEMA 5-15 Wall Outlet attachment (12A) provides AC Level 1 charging, whereas NEMA 14-50 Wall Attachment (32A) provides AC Level 2 charging. The cord is configurable by the user without the use of tools. Charging at rates lower than or equal to 32A can also be achieved via a mobile connector through the Vehicle UI “Charge Current at this location” feature which allows the user to select current between 5A and 32A, in 1A increments. The Mobile Connector incorporates similar electronic circuitry as the HPC to communicate with the vehicle and manage the charging process.

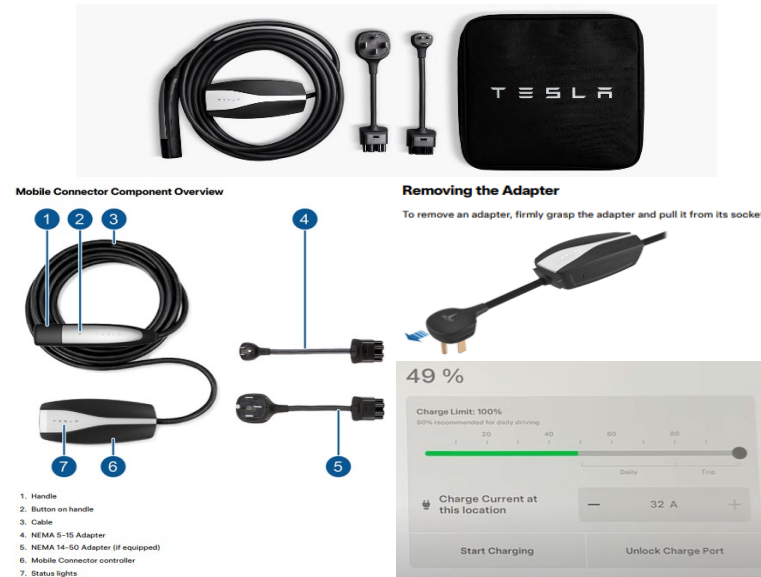

#### **02.06.05 - HPC Charging Cord**

**High Power Connector (HPC)** - Purchased separately from the vehicle, a certified electrician will confirm the capabilities of the residential supply circuit at the vehicle owner's location. Confirmation of a satisfactory residential electrical Supply will lead to the installation of a hard-wired HPC unit, this will expedite vehicle charging at the most efficient rate. The HPC can supply available current up to a maximum of 80 amps and incorporates electronic systems that communicate with the vehicle control systems to indicate the maximum available current so that the vehicle can determine the amount and rate of charge required.

#### **02.06.06 - Regenerative Braking System**

Regenerative braking (RGB) occurs when the driver lifts his foot from the accelerator pedal while the vehicle is moving; the experience is analogous to engine braking on a gasoline-powered car with a conventional manual transmission. The friction braking system is independent of RGB.

The amount of RGB torque generated depends on the accelerator pedal position – largest when the accelerator pedal is fully released, decreasing as the pedal is depressed, reaching zero torque when the pedal reaches its neutral torque position (a position that is a function of vehicle speed). The max RGB deceleration also varies depending on vehicle speed. The maximum RGB profile is defined as a target total deceleration rate as a function of vehicle speed. The max RGB profile is tailored to everyday driving conditions, which typically exhibit higher deceleration rates at lower speeds.

When the battery pack is near maximum capacity, regenerative braking function will be limited to ensure the maximum capacity of the battery is not exceeded. Any RGB limiting will be ramped in gradually to allow the driver to adapt to the changing RGB performance. When the battery pack is below 0 degrees, RGB will not be allowed because the batteries are not rated to accept charge below this temperature. Any RGB limiting will be ramped in gradually to allow the driver to adapt to the changing RGB performance. The vehicle notifies the driver of any limits on the regenerative braking function.

**03.00.00 - Test Results and Procedures**

Internal range test reports are on file at Tesla

**03.01.00 - Vehicle Configuration and Subconfigurations**

Refer to appendix

**03.02.00 - Test Results**

Refer to appendix

**03.03.00 - Break-in Procedures**

SAE J1634 break-in procedures are followed. Vehicles are stabilized as determined by the manufacturer and shall have accumulated a minimum of 1600 km (1000 miles), but no more than 9978 km (6200 miles) (40 CFR § 600.006), on the Durability Driving Schedule as defined in 40 CFR § 86, Appendix V or an equivalent driving schedule.

**03.03.01 - Battery Pre-conditioning Procedures**

The lithium ion battery cells are cycled by the battery cell manufacturer before they are assembled into battery packs. There is no further pre-conditioning necessary.

**03.04.00 - Test Procedures**

SAE J1634 was followed for all range testing and SAE J2263 (as issued 2008-12) was followed for Road load measurement.

**04.00.00 - Statement of Compliance**

This vehicle conforms to US EPA Federal Tier 3 Bin 0 and State of California regulations applicable to 2026 Model Year New ZEV Light-duty Vehicles

**06.00.00 - Labels**

**06.01.00 - Label Locations**

**Vehicle Emission Control Information Label**

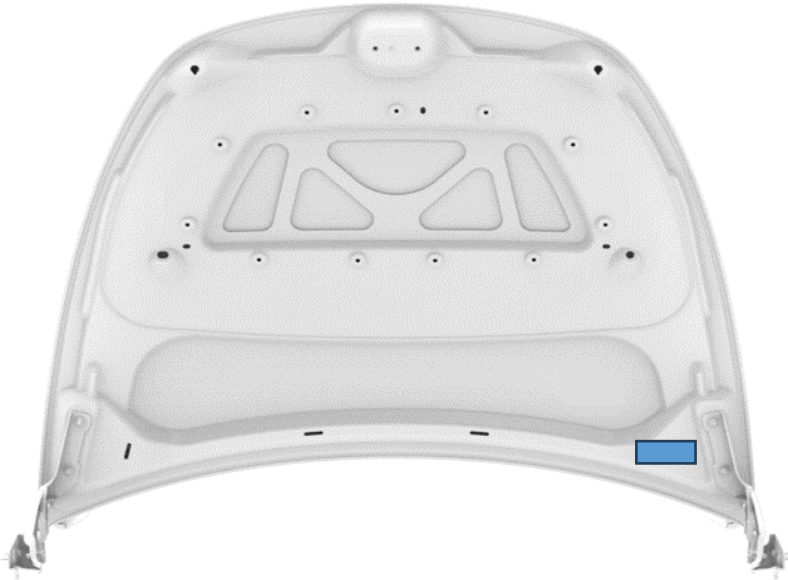

**Monroney Label**

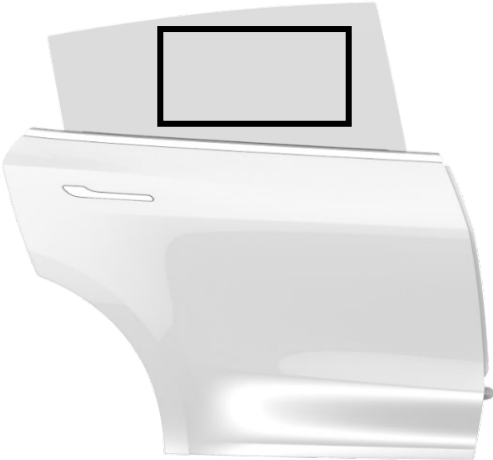

**06.02.00 - Sample Labels**

**Vehicle Emission Control Information: 2026 Model Year**

(Mandated in CFR Title 40, Part 86; §86.1807. Label format agreed with EPA/CARB)

**VEHICLE EMISSION CONTROL INFORMATION**

**THIS VEHICLE CONFORMS TO U.S. EPA REGULATIONS APPLICABLE TO 2026 MODEL YEAR NEW TIER 3 BIN 0 LIGHT-DUTY VEHICLES AND TO CALIFORNIA REGULATIONS APPLICABLE TO ZEV PASSENGER CARS AND IS CERTIFIED FOR SALE IN CALIFORNIA.**

**MODEL: 2026 TESLA MODEL 3**  
**MOTOR: 3 PHASE AC**  
**TEST GROUP: TTSLV00.0L23**  
**EVAPORATIVE FAMILY: TTSLR0000L23**

**TESLA, INC.**

**California Environmental Performance Index Label: 2026 Model Year**

(Mandated in California Environmental Performance Label Specifications for 2009 and Subsequent Model Passenger Cars, Light-Duty Trucks and Medium-Duty Passenger Cars. Label format agreed with EPA/ CARB)

**FE Label**

EPA  
DOT

Fuel Economy and Environment

**Electric Vehicle**

---

**Fuel Economy**

**MPGe** Small SUV range from 14 to 118 MPGe. The best vehicle rates 140 MPGe.

combined city/hwy    city    highway    kW-hr per 100 miles

**Driving Range**  
When fully charged, vehicle can travel about...

0    50    100    150    200    250    300    miles

**Charge Time: 12 hours (240V)**

**You save**

\$

**in fuel costs over 5 years**  
compared to the average new vehicle.

---

**Annual fuel COST**

\$

**Fuel Economy & Greenhouse Gas Rating** (tailpipe only)

MPG **9**

CO<sub>2</sub> **10** Best

This vehicle emits 0 grams CO<sub>2</sub> per mile. The best emits 0 grams per mile (tailpipe only). Producing and distributing fuel also create emissions: learn more at fueleconomy.gov.

**Smog Rating** (tailpipe only)

**10** Best

---

Actual results will vary for many reasons, including driving conditions and how you drive and maintain your vehicle. The average new vehicle gets 28 MPG and costs \$9,500 to fuel over 5 years. Cost estimates are based on 15,000 miles per year at \$0.16 per kWh. MPGe is miles per gasoline gallon equivalent. Vehicle emissions are a significant cause of climate change and smog

fueleconomy.gov

Smartphone QR Code

Calculate personalized estimates and compare vehicles

## **07.00.00 - Vehicle Safety and Manuals**

### **07.01.00 - Owner's Manual**

All Information for safe operation of vehicle. Tesla owner's manual is available at <https://www.tesla.com/ownersmanual>

### **07.02.00 - Information on Safe Handling of Battery System**

#### **HANDLING**

Do not short circuit, puncture, incinerate, crush, immerse, force discharge, or expose the battery pack to temperatures outside the specified maximum storage temperature range of -20°C to 60°C.

The battery pack has a nominal operating voltage of ~400 VDC. The battery pack is sealed in a rigid metal case and its exterior is isolated from high voltage. Handling the battery pack is electrically safe provided the enclosure remains closed.

The battery pack contains hermetically sealed lithium ion cells that contain a number of chemicals and materials of construction. Risk of exposure to electrode materials and Liquid electrolyte will only occur in cases of mechanical or thermal abuse of the battery Pack.

#### **STORAGE**

Do not store the battery pack in a manner that allows terminals to short circuit. Do not place near heating equipment, nor expose to direct sunlight for long periods. The battery pack should only be stored in approved packaging and stacked no more than two (2) packages high. To maintain service life, the battery pack should be stored at a state of charge (SOC) of 15 to 50%.

#### **TRANSPORT**

Lithium ion batteries are regulated as Class 9 Miscellaneous dangerous goods (also known as “hazardous materials”) pursuant to the International Civil Aviation Organization.

(ICAO) Technical Instructions for the Safe Transport of Dangerous Goods by Air, International Air Transport Association (IATA) Dangerous Goods Regulations, the International Maritime Dangerous Goods (IMDG) Code, European Agreements concerning the International Carriage of Dangerous Goods by Rail (RID) and Road (ADR), and applicable national regulations such as the USA’s hazardous materials regulations (see 49 CFR 173.185). These regulations contain very specific packaging, labelling, marking, and documentation requirements. The regulations also require that individuals involved in the preparation of dangerous goods for transport be trained on how to properly package, label, mark and prepare shipping documents.

### **07.02.01 - Description of Warning System(s) for Maintenance / Malfunction**

This vehicle is equipped with a tell-tale lamp located in the display to indicate any malfunctions through user alerts e.g. “battery failure” with battery symbol.

The tell-tale is complemented by more detailed information exhibited on the Center Display. An additional driver aid which indicates the nature of the malfunction as well as a wide range of additional vehicle data, such as when maintenance is needed.

### **07.02.02 - Cut-off Terminal Voltages for Prevention of Battery Damage**

The control electronics inside of the Drive Unit and Charger are programmed not to allow the unit to drive the voltage of the battery above or below hard voltage limits. If the battery pack is unable to achieve a desired response from these systems and the voltage reaches above or below a set limit, the two switches inside the battery pack will open, disabling the entire high voltage system in the car.

### **07.03.00 - Information on Emergency Procedures**

All Information for emergency procedures is available at <https://www.tesla.com/firstresponders>

#### **HIGH VOLTAGE EXPOSURE**

If one of the Tesla products has been visibly damaged or its enclosure compromised, then practice appropriate high voltage preventative measures until the danger has been assessed (and dissipated if necessary).

## **FIREFIGHTING MEASURES**

If a fire or explosion occurs when the battery pack is charging, shut off power to the charger. In case of burning lithium ion fires, flood the area with water. The water may not extinguish them, but will cool the adjacent batteries and control the spread of the fire. CO<sub>2</sub>, dry chemical and foam extinguishers are preferred for small fires, but also may not extinguish burning lithium ion batteries. Burning batteries will burn themselves out. Virtually all fires involving lithium ion batteries can be controlled with water. When water is used, however, hydrogen gas may be a by-product which can form an explosive mixture with air. LITH-X (powdered graphite) or copper powder fire extinguishers, sand, dry ground dolomite or soda ash may also be used. These materials act as smothering agents.

Damaged or opened cells or batteries can result in rapid heating (due to exothermic reaction of constituent materials) and the release of flammable vapors. Water (and other items listed above) disperses heat when applied in sufficient quantity to a fire. Extended heat exposure can lead to ignition of adjacent cells with a potential complete envelopment of the battery pack if not cooled. An extinguished lithium ion battery fire can re-ignite due to the exothermic reaction of constituent materials from broken or damaged cells. To avoid this, remove sources of ignition and cool the burned mass by flooding with (or immersing in) water. Fire-fighters should wear self-contained breathing apparatus. Cells or batteries may flame or leak potentially hazardous organic vapors if exposed to excessive heat, fire or over voltage conditions. These vapors include HF, oxides of carbon, aluminum, lithium, copper, and cobalt. Additionally, volatile phosphorus pentafluoride may form at temperatures above 230° Fahrenheit. Never cut into the sealed battery pack enclosure due to the high voltage and electrocution risks.

If a decision is made to fight a battery fire aggressively, then large amounts of water should be applied from a safe distance with the intent of flooding the battery pack enclosure as completely as possible. Alternatively, if a decision is made to fight a battery fire defensively, then the fire crew should pull back a safe distance and allow the battery to burn itself out. Fire crews may choose to utilize a water stream or fog pattern to protect exposures or control the path of smoke.

## **FIRST AID MEASURES**

Under normal conditions of use, the constituent battery cells are hermetically sealed. Contents of an open (broken) constituent battery cell can cause skin irritation and/or chemical burns. If materials from a ruptured or otherwise damaged cell or battery contact skin, flush immediately with water and wash affected area with soap and water. For eye contact, flush with significant amounts of water for 15 minutes and see physician at once. Avoid inhaling any vented gases. If a chemical burn occurs or if irritation persists, seek medical assistance. Seek immediate medical assistance if an electrical shock or electrocution has occurred (or is suspected).

## **07.04.00 - Information on Battery Recycling**

All Information for battery recycling is available at <https://www.tesla.com/support/sustainability-recycling>

Tesla vehicles are designed to last, but if needed, Tesla Service Centers can help get you back on the road.

What happens to Tesla battery packs once they reach their end of life?

Unlike fossil fuels, which release harmful emissions into the atmosphere that are not recovered for reuse, materials in a Tesla lithium-ion battery are recoverable and recyclable. Battery materials are refined and put into a cell, and will still remain in the cell at the end of their life, when they can be recycled to recover its valuable materials for reuse over and over again.

Extending the life of a battery pack is a superior option to recycling for both environmental and business reasons. For those reasons, before decommissioning a consumer battery pack and sending it for recycling, Tesla does everything it can to extend the useful life of each battery pack. Any battery that is no longer meeting a customer's needs can be serviced by Tesla at one of our Service Centers around the world. None of our scrapped lithium-ion batteries go to landfilling, and 100% are recycled.

Lithium-ion battery packs should only be handled by qualified professionals at specifically designated facilities. The applicable rules and regulations for battery management vary by region and must always be followed.

If a Tesla battery pack needs attention, contact us.

## **07.05.00 - Maintenance**

### **07.05.01 - Test Vehicle Scheduled Maintenance**

Not applicable.

### **07.05.02 - Recommended Customer Maintenance Schedule**

Maintenance schedule can be found in the Tesla owner's manual. It is available at <https://www.tesla.com/ownersmanual>

## **08.00.00 - General Technical Description**

### **08.01.00 - Description of Dyno Mode**

Tesla, Inc. implemented user interface (UI) features that enable access to our “Dyno Mode” for all users. This feature is required to be enabled to maintain representative driving controls while testing on a chassis dynamometer.

In order to preserve the proper driving functionality and behavior, Dyno Mode executes the following features:

- Disable Stability Control to ensure no false interaction with the dyno.
- Disable Traction Control to ensure no false interaction with the dyno.
- Disable Active Drive Line Damping to avoid inducing oscillations in the dyno.
- Force the torque split to be as it would be under normal straight-line driving conditions
- Disable Brake Disk Wipe
- Disable vehicle movement plausibility monitor to ensure the availability of autonomous brake actuation on Dyno.
- Disable sensor inputs that estimate the position of the sun and assume the sun's location is directly overhead the vehicle to avoid inconsistent HVAC controls behavior.
- Transition vehicle light state switch and behavior to OFF state.

When the Stability Control and Traction Control systems become faulted, as is the case on a dynamometer where driving is detected but movement is not, regenerative braking is disabled so that unintended braking torque does not lead to loss of traction or control on low friction surfaces. Disabling Stability Control and Traction Control prevents those systems from disrupting regenerative braking behavior, maintaining the most representative driving energy consumption.

Dyno Mode can be activated by the user, according to the steps in the driver's guide.

Dyno Mode can be deactivated by the user by pressing the “Power Off” button within the Safety & Security tab of the UI.

### **08.02.00 - Description of Coastdown Mode**

Tesla does not use any special mode for coastdown testing.

### **08.03.00 - Starting and Shifting Schedules**

#### **08.03.01 - Starting**

This vehicle does not have a traditional starter switch and instead has a smart entry system for greater safety and customer convenience. The smart entry system comprises of an authenticated phone (using Bluetooth Low Energy or internet connectivity) or key card (using Near Field Communication), a weight sensor embedded into the driver seat, and the brake pedal.

#### **ENTERING**

An authenticated phone can be used to passively unlock the car when connected, in range and a door handle is pulled or trunk release button is pressed.

The Tesla mobile app on an authenticated phone can be used to manually unlock the vehicle.

A key card can be used to unlock the car by scanning the card on the b-pillar.

After a successful key card scan on the b-pillar or center console:

- a. Vehicle is authorized to Drive within a reasonable time period. Time period is extended based on additional user interaction which include: driver opening their door, driver sitting down, driver closing their door while seated.
- b. If time period is exceeded, upon brake press, instruct driver to rescan key card on the center console to reauthorize Drive.
- c. Accessory Mode functions will be available without the user having to rescan their key card.

## **LOCKING**

An authenticated phone can be used to passively lock the car when the phone is disconnected or moved away from the vehicle. This passive function can be disabled in controls on the touchscreen.

The Tesla mobile app on an authenticated phone can be used to manually lock the vehicle.

A key card can be used to lock the car by scanning the card on the b-pillar. There is no passive locking with key cards (car does not auto lock).

Note: Using a key card to lock/unlock will be equivalent to an active lock/unlock—i.e., clicking on the key fob to lock and double-clicking to unlock.

## **STARTING**

If successful interaction between authenticated phone or the key card and vehicle controller occurs, the system deactivates the immobilizer. Immobilizer deactivation only happens after 2 conditions are met below. The vehicle then enters accessory mode analogous to a “ACC” position on a conventional IC engine. In this mode, low voltage (12V) is supplied to the vehicle allowing operation of the radio and other accessories connected to the accessory rail.

High Voltage (HV) necessary to enable vehicle propulsion is enabled only by the closing of the contactors, which can only be triggered when the following conditions are both satisfied,

1. Authenticated phone or key card is authorized and key code is validated AND
2. Brake pedal is depressed.

By requiring brake pedal activation, along with the appropriate key code, this system ensures the safety of vehicle occupants by not allowing self mobility of the vehicle without the driver providing proper control inputs (i.e., service brake activation) and appropriate driver authorization (i.e., presence of the key code). If either the service brake is not activated or the key code not present, the vehicle controller will not close the contactors and self-mobility is not possible.

If the brake pedal is depressed and the proper key code present, the drive rail will activate (immobilizer deactivates) and allows the vehicle to be shifted out of Park.

### **08.03.02 - Shifting**

Not applicable – the vehicle has a single-speed transmission.

**Appendix**

**03.01.00 - Vehicle Configuration and Subconfigurations**

<b>Make</b>	<b>Tesla</b>
<b>Model Name</b>	<b>Model 3 Premium AWD</b>
<b>Vehicle Classification</b>	Passenger Car
<b>Vehicle Type</b>	Battery Electric Vehicle
<b>Test Group</b>	TTSLV00.0L23
<b>Engine Code</b>	L23
<b>Transmission Type / Code</b>	AV/1
<b>Final Drive ratio</b>	1
<b>Emission Control</b>	N/A (BEV)
<b>Exhaust</b>	N/A (BEV)
<b>Evap</b>	N/A (BEV)
<b>Vehicle Configuration #</b>	0
<b>Subconfiguration #</b>	0
<b>Vehicle ID tested</b>	3D324-758491
Gross Vehicle Weight (lbs)	4954
33% Curb Mass (lbs)	4030
Loaded Vehicle Weight (lbs)	4330
Equivalent Test Weight (lbs)	4250
Wheel / Tire	235/45R18
Target Road Load A lbf	30.98
B lbf/mph	0.1596
C lbf/mph <sup>2</sup>	0.0141
Road Load HP @ 50mph	9.90
<b>Subconfiguration #</b>	1
Gross Vehicle Weight (lbs)	4954
33% Curb Mass (lbs)	4030
Loaded Vehicle Weight (lbs)	4330
Equivalent Test Weight (lbs)	4250
Wheel / Tire	235/40R19
Target Road Load A lbf	35.54
B lbf/mph	0.2449
C lbf/mph <sup>2</sup>	0.0144
Road Load HP @ 50mph	11.17

Fuel Economy Data Vehicle (FEDV) Selection Justification – FEDV curb mass vehicle accounts for options that have a greater than 33% take rate and highest sold wheel/tire combination that collectively represents a vehicle configuration / sub configuration that has the largest sales volume within that Model Type. Tesla affirms that the road load power, and the target coefficients are those that are appropriate for the ETW of the vehicle.

**Appendix**

**03.01.01 - Vehicle Configuration and Subconfigurations**

<b>Make</b>	<b>Tesla</b>
<b>Model Name</b>	<b>Model 3 Performance</b>
<b>Vehicle Classification</b>	Passenger Car
<b>Vehicle Type</b>	Battery Electric Vehicle
<b>Test Group</b>	TTSLV00.0L23
<b>Engine Code</b>	L23
<b>Transmission Type / Code</b>	AV/1
<b>Final Drive ratio</b>	1
<b>Emission Control</b>	N/A (BEV)
<b>Exhaust</b>	N/A (BEV)
<b>Evap</b>	N/A (BEV)
<b>Vehicle Configuration #</b>	0
<b>Subconfiguration #</b>	0
<b>Vehicle ID tested</b>	3D226-064265
Gross Vehicle Weight (lbs)	4974
33% Curb Mass (lbs)	4054
Loaded Vehicle Weight (lbs)	4354
Equivalent Test Weight (lbs)	4250
Wheel / Tire	F: 235/35R20 R: 275/30R20
Target Road Load A lbf	36.82
B lbf/mph	0.13857
C lbf/mph <sup>2</sup>	0.01545
Road Load HP @ 50mph	10.99
<b>Subconfiguration #</b>	1
Gross Vehicle Weight (lbs)	4974
33% Curb Mass (lbs)	4054
Loaded Vehicle Weight (lbs)	4354
Equivalent Test Weight (lbs)	4250
Wheel / Tire	F: 235/35R20 R: 275/30R20
Target Road Load A lbf	34.15
B lbf/mph	0.25181
C lbf/mph <sup>2</sup>	0.01524
Road Load HP @ 50mph	11.31

Fuel Economy Data Vehicle (FEDV) Selection Justification – FEDV curb mass vehicle accounts for options that have a greater than 33% take rate and highest sold wheel/tire combination that collectively represents a vehicle configuration / sub configuration that has the largest sales volume within that Model Type. Tesla affirms that the road load power, and the target coefficients are those that are appropriate for the ETW of the vehicle.

**Appendix**

**03.01.02 - Vehicle Configuration and Subconfigurations**

<b>Make</b>	<b>Tesla</b>
<b>Model Name</b>	<b>Model 3 Performance AWD</b>
<b>Vehicle Classification</b>	Passenger Car
<b>Vehicle Type</b>	Battery Electric Vehicle
<b>Test Group</b>	TTSLV00.0L23
<b>Engine Code</b>	L23
<b>Transmission Type / Code</b>	AV/1
<b>Final Drive ratio</b>	1
<b>Emission Control</b>	N/A (BEV)
<b>Exhaust</b>	N/A (BEV)
<b>Evap</b>	N/A (BEV)
<b>Vehicle Configuration #</b>	0
<b>Subconfiguration #</b>	0
<b>Vehicle ID tested</b>	3D226-127749
Gross Vehicle Weight (lbs)	4974
33% Curb Mass (lbs)	4054
Loaded Vehicle Weight (lbs)	4354
Equivalent Test Weight (lbs)	4250
Wheel / Tire	F: 235/35R20 R: 275/30R20
Target Road Load A lbf	36.82
B lbf/mph	0.13857
C lbf/mph <sup>2</sup>	0.01545
Road Load HP @ 50mph	10.99
<b>Subconfiguration #</b>	1
Gross Vehicle Weight (lbs)	4974
33% Curb Mass (lbs)	4054
Loaded Vehicle Weight (lbs)	4354
Equivalent Test Weight (lbs)	4250
Wheel / Tire	F: 235/35R20 R: 275/30R20
Target Road Load A lbf	34.15
B lbf/mph	0.25181
C lbf/mph <sup>2</sup>	0.01524
Road Load HP @ 50mph	11.31

Fuel Economy Data Vehicle (FEDV) Selection Justification – FEDV curb mass vehicle accounts for options that have a greater than 33% take rate and highest sold wheel/tire combination that collectively represents a vehicle configuration / sub configuration that has the largest sales volume within that Model Type. Tesla affirms that the road load power, and the target coefficients are those that are appropriate for the ETW of the vehicle.

**Appendix**

**03.01.03 - Vehicle Configuration and Subconfigurations**

<b>Make</b>	<b>Tesla</b>
<b>Model Name</b>	<b>Model 3 Premium AWD-I</b>
<b>Vehicle Classification</b>	Passenger Car
<b>Vehicle Type</b>	Battery Electric Vehicle
<b>Test Group</b>	TTSLV00.0L23
<b>Engine Code</b>	L23
<b>Transmission Type / Code</b>	AV/1
<b>Final Drive ratio</b>	1
<b>Emission Control</b>	N/A (BEV)
<b>Exhaust</b>	N/A (BEV)
<b>Evap</b>	N/A (BEV)
<b>Vehicle Configuration #</b>	0
<b>Subconfiguration #</b>	0
<b>Vehicle ID tested</b>	3D226-R00620
Gross Vehicle Weight (lbs)	4952
33% Curb Mass (lbs)	4030
Loaded Vehicle Weight (lbs)	4330
Equivalent Test Weight (lbs)	4250
Wheel / Tire	235/45R18
Target Road Load A lbf	27.07
B lbf/mph	0.2869
C lbf/mph <sup>2</sup>	0.0128
Road Load HP @ 50mph	9.78
<b>Subconfiguration #</b>	1
Gross Vehicle Weight (lbs)	4952
33% Curb Mass (lbs)	4030
Loaded Vehicle Weight (lbs)	4330
Equivalent Test Weight (lbs)	4250
Wheel / Tire	235/40R19
Target Road Load A lbf	31.97
B lbf/mph	0.2359
C lbf/mph <sup>2</sup>	0.0149
Road Load HP @ 50mph	10.79

Fuel Economy Data Vehicle (FEDV) Selection Justification – FEDV curb mass vehicle accounts for options that have a greater than 33% take rate and highest sold wheel/tire combination that collectively represents a vehicle configuration / sub configuration that has the largest sales volume within that Model Type. Tesla affirms that the road load power, and the target coefficients are those that are appropriate for the ETW of the vehicle.



### Certification Summary Information Report

<b>Test Group</b>	TTSLV00.0L23	<b>Evaporative/Refueling Family</b>	--
-------------------	--------------	-------------------------------------	----

**Models Covered by this Certificate**

Carline Manufacturer	Division	Carline	Certification Region Code(s)	Drive System	Trans - Type	- # of Gears	Trans - Lockup
Tesla, Inc.	1 - Tesla Motors	95 - Model 3 Performance	Federal	All Wheel Drive	Automatic	1	No
Tesla, Inc.	1 - Tesla Motors	95 - Model 3 Performance	California + CAA Section 177 states	All Wheel Drive	Automatic	1	No
Tesla, Inc.	1 - Tesla Motors	94 - Model 3 Premium AWD-I	Federal	All Wheel Drive	Automatic	1	No
Tesla, Inc.	1 - Tesla Motors	96 - Model 3 Performance AWD	California + CAA Section 177 states	All Wheel Drive	Automatic	1	No
Tesla, Inc.	1 - Tesla Motors	94 - Model 3 Premium AWD-I	California + CAA Section 177 states	All Wheel Drive	Automatic	1	No
Tesla, Inc.	1 - Tesla Motors	93 - Model 3 Premium AWD	Federal	All Wheel Drive	Automatic	1	No
Tesla, Inc.	1 - Tesla Motors	96 - Model 3 Performance AWD	Federal	All Wheel Drive	Automatic	1	No
Tesla, Inc.	1 - Tesla Motors	93 - Model 3 Premium AWD	California + CAA Section 177 states	All Wheel Drive	Automatic	1	No

**Engine Description**

Hybrid Type	--	Hybrid Description	--
Engine Type	--	Mfr Engine Description	--
Engine Block Arrangement	--	Mfr Engine Block Arrangement Description	--
Camless Valvetrain Indicator	--	Oil Viscosity/Classification	--
Number of Cylinders/Rotors	--	Mechanically Variable Compression Ratio Indicator	--

**After Treatment Device(s) (ATD)**

Mfr After Treatment Device (ATD) Comments	--
Direct Ozone Reduction (DOR) Device	--
Mfr Emission Control Device Comments	--

**Official Test Numbers**

Test Group	Fuel	FTP	US06	SC03	Cold CO	Highway	EPA City Litmus Value	EPA City Litmus Threshold	EPA Highway Litmus Value	EPA Highway Litmus Threshold	CREE Weighting Factor
Electricity		--	--	--	--	--	--	--	--	--	--

**SFTP LEV-III Official Test Numbers**

Test Group Fuel	FTP	US06	SC03
Electricity	--	--	--

## Certification Summary Information Report

<b>Test Group</b>	TTSLV00.0L23	<b>Evaporative/Refueling Family</b>	--
<b>Official Charge Depleting Test Numbers</b>			
<b>Test Group Fuel</b>	<b>UDDS</b>	<b>Highway</b>	
Electricity	RTSL10086298	RTSL10086299	
<b>Hybrid Electric Vehicle And Fuel Cell Information</b>			
<b>Rechargeable Energy Storage System</b>	Battery(s)	<b>Rechargeable Energy Storage System, if Other</b>	--
<b>Battery Type</b>	Lithium Ion	<b>Number of Battery Packs</b>	1
<b>Total Voltage of Battery Packs</b>	346	<b>Battery Energy Capacity</b>	228
<b>Battery Specific Energy</b>	176	<b>Battery Charger Type</b>	On-Board
<b>Number of Capacitors</b>	--	<b>Capacitor Rating (In Farads)</b>	--
<b>Mfr Capacitor Comments</b>	--		
<b>Hydraulic System Description</b>	--		
<b>Regenerative Braking Type</b>	Electrical Regen Brake		
<b>Regenerative Braking Source</b>	Both	<b>Driver Controlled Regenerative Braking</b>	No
<b>Mfr Regenerative Braking Description</b>	--		
<b>Drive Motor(s)/Generator(s)</b>	2		
<b>Motor/Generator Type 1</b>	AC Induction	<b>Rated Motor/Generator Power</b>	88
<b>Motor/Generator Type 2</b>	AC 3 PHASE PERMANENT MAGNET	<b>Rated Motor/Generator Power</b>	208
<b>Mfr Fuel Cell Description</b>	--		
<b>Fuel Cell On-Board H2 Storage Capacity (kg)</b>	--	<b>Usable H2 Fill Capacity (kg)</b>	--
<b>Mfr Hybrid Electric/ Electric Vehicle Comments</b>	Electric Vehicle Battery Information Model 3 Premium AWD and Performance - Listed in CSI Model 3 Performance AWD Battery Energy Capacity: 246 Ah Total Voltage of Packs: 346 V Battery Specific Energy: 184 Whr/kg Model 3 Premium AWD-I Battery Energy Capacity: 240 Ah Total Voltage of Packs: 354 V Battery Specific Energy: 182 Whr/kg Drive Motor Information Model 3 Premium AWD - Listed in CSI Model 3 Performance and Performance AWD Front Rated Motor Power: 98 kW Rear Rated Motor Power: 282 kW Model 3 Premium AWD-I Front Rated Motor Power: 76 kW Rear Rated Motor Power: 204 kW		

### Certification Summary Information Report

<b>Test Group</b>	TTSLV00.0L23	<b>Evaporative/Refueling Family</b>	--
-------------------	--------------	-------------------------------------	----

**Emission Data Vehicle Information**

Vehicle ID / Configuration	3D224-758491 / 0	Manufacturer Vehicle Configuration Number	0
Original Test Group Name	RTSLV00.0L23	Original Evaporative/Refueling Family	--
Original Test Vehicle Model Year	2024		
<b>Vehicle Model</b>			
Represented Test Vehicle Make	Tesla	Represented Test Vehicle Model	Model 3 Long Range AWD-E

**Leak Family Details**

Leak Family Identifier	--	Leak Family Name	--
------------------------	----	------------------	----

**Drive Sources and Fuel System Details**

Drive Source and Fuel#	Drive Source	Fuel
1	Electric Motor	Electricity

Hybrid Indicator	No		
Multiple Fuel Storage	--	Multiple Fuel Combustion	--
Fuel Cell Indicator	No	Rechargeable Energy Storage System Indicator	Yes
Rechargeable Energy Storage System	Battery(s)	Rechargeable Energy Storage System, if 'Other'	--
Off-board charge Capable Indicator	Yes		
Odometer Correction -- Initial	1	Odometer Correction Factor	1
Odometer Correction Sign	- = System Miles is equal to (Test odometer reading - Initial system miles) * Correction factor		
Odometer Correction Units	Miles		
Engine Code	L23	Rated Horsepower	397
Displacement (liters)	0.001		
Air Aspiration Method	Naturally Aspirated	Air Aspiration Method, if 'Other'	
Number of Air Aspiration Devices	--	Air Aspiration Device Configuration	--
Charge Air Cooler Type	--	Drive Mode While Testing	All Wheel Drive
Shift Indicator Light Usage	Not equipped	Aged Emission Components	4,000 (mi)
Curb Weight (lbs)	4030	Equivalent Test Weight (pounds)	4250
GVWR (lbs)	4954	N/V Ratio	115
Axle Ratio	1		
Transmission Type	Automatic	# of Transmission Gears	1
Transmission Lockup	No	Creeper Gear	No

**Dynamometer Coefficients:**

Coefficient Category	Target Coefficients			Set Coefficients			EPA Calculated Total Road Load Horse Power for City/Highway/Evap Coefficients
	A (lbf)	B (lbf/mph)	C (lbf/mph**2)	A (lbf)	B (lbf/mph)	C (lbf/mph**2)	
City/Highway/Evap	30.98	0.1596	0.0141	-3.45	0.0734	0.0131	9.9

**Emission Control Device Comments**      No Emissions Control Device - Pure Electric

### Certification Summary Information Report

Test Group	TTSLV00.0L23	Evaporative/Refueling Family	--
<b>Manufacturer Test Vehicle Comments</b>	This is MY2024 Model 3 Long Range AWD-E; Front Motor Power - 88 kW; Rear Motor Power - 208 kW;		

## Certification Summary Information Report

<b>Test Group</b>	TTSLV00.0L23	<b>Evaporative/Refueling Family</b>	--
<b>Test #</b>	<b>RTSL10086298</b>	<b>Test Procedure</b>	<b>81 - Charge Depleting UDDS</b>
<b>Exhaust Test # for this Evap Test</b>	--	<b>Test Fuel Type</b>	62 - Electricity
<b>Test Date</b>	05/09/2024	<b>Fuel</b>	Electricity
<b>Fuel Batch ID</b>	--	<b>Fuel Calibration Number</b>	--
<b>Vehicle Class</b>	LDV/Passenger Car	<b>DF Type</b>	EPA Assigned
<b>Verify Test Lab ID</b>	Tesla Kato		
<b>E10 Evaporative Test Measurement Method</b>	--		
<b>Test Start Odometer Reading</b>	2191	<b>Odometer Units</b>	M
<b>4WD Test Dyno</b>	Yes	<b>Diesel Adjustment Factor Usage</b>	--
<b>State of Charge Delta</b>	--		
<b>Drive Cycle Speed Tolerance Criteria</b>	Used Part 86 (+/- 2 mph, +/- 1 sec)	<b>Road Speed Fan Usage</b>	Yes

**PHEV/EV Charge Depleting Test Information**

<b>Recharge Event Voltage</b>	208	<b>Recharge Event Energy (kiloWatt-hours)</b>	90.946
<b>Charge Depleting Range (Calculated miles)</b>	514	<b>Charge Depleting Range (Actual miles)</b>	514
<b>Charge Depleting Range Highway (Calculated miles)</b>	--	<b>Derived 5-Cycle Coefficient Model Year</b>	--
<b>All Electric Range Unadjusted (miles)</b>	--	<b>Equivalent All Electric Range (miles)</b>	514
<b>Number of Charge Depleting Bags/Phases Conducted</b>	4	<b>Transition Bag/Phase Number</b>	--

**Charge Depleting Bag/Phase #1**

Test Result/Emission Name	Unrounded Test Result
Actual Distance Driven (miles)	0
Carbon Monoxide	0
Carbon dioxide	0
Carbon-Related Exhaust Emissions	0
Drive Trace Absolute Speed Change Rating	5.5051
Drive Trace Energy Economy Rating	4.4151
Drive Trace Inertia Work Ratio Rating	8.2847
Integrated DC KW-HRS	0
Manufacturer Fuel Economy	190.53
Nitrogen Oxide	0
Non-methane organic gases	0
Non-methane organic gases plus Nitrogen Oxides	999.999
Particulate Matter	0
System End State of Charge Watt-hours	80.099
System Start State of Charge Watt-hours	0

### Certification Summary Information Report

<b>Test Group</b>	TTSLV00.0L23	<b>Evaporative/Refueling Family</b>	--
-------------------	--------------	-------------------------------------	----

**Manufacturer Test Comments**

Internal Test results for MY2024 Model 3 Long Range AWD-E. Range determined by using SAE J1634 Multi-cycle test procedure. END-SOC 80099 wh (system gave error limited to 4 digits). MCT dc wh/mi is attached with EPA application. DC energy consumption UDDS1 = 175.35 Wh/mi; UDDS2 = 159.56 Wh/mi; UDDS3 = 153.51 Wh/mi; UDDS4 = 153.37 Wh/mi; UDDS weighted = 155.8 Wh/mi; UDDS1 DC discharge energy = 1305 Wh; MCT UBE energy = 80099 Wh

Certification Region	Useful Life	Standard Level	Emission Name	Rounded Result	RAF	NMOG/NM HC Ratio	Diesel Adjustment Factor	Add DF	Mult DF	Certification Level	Standard	Pass/Fail
Fed	150,000 miles	Federal Tier 3 Bin 0	CO	0.0	--	--	--	0	--	0	0	Pass
Fed	150,000 miles	Federal Tier 3 Bin 0	CREE	0	--	--	--	0	--	0	--	--
CA	150,000 miles	California ZEV	CO	0.0	--	--	--	0	--	0	0	Pass
CA	150,000 miles	California ZEV	CREE	0	--	--	--	0	--	0	--	--

## Certification Summary Information Report

<b>Test Group</b>	TTSLV00.0L23	<b>Evaporative/Refueling Family</b>	--
<b>Test #</b>	<b>RTSL10086299</b>	<b>Test Procedure</b>	<b>84 - Charge Depleting Highway</b>
<b>Exhaust Test # for this Evap Test</b>	--	<b>Test Fuel Type</b>	62 - Electricity
<b>Test Date</b>	05/09/2024	<b>Fuel</b>	Electricity
<b>Fuel Batch ID</b>	--	<b>Fuel Calibration Number</b>	--
<b>Vehicle Class</b>	LDV/Passenger Car	<b>DF Type</b>	EPA Assigned
<b>Verify Test Lab ID</b>	Tesla Kato		
<b>E10 Evaporative Test Measurement Method</b>	--		
<b>Test Start Odometer Reading</b>	2191	<b>Odometer Units</b>	M
<b>4WD Test Dyno</b>	Yes	<b>Diesel Adjustment Factor Usage</b>	--
<b>State of Charge Delta</b>	--		
<b>Drive Cycle Speed Tolerance Criteria</b>	Used Part 86 (+/- 2 mph, +/- 1 sec)	<b>Road Speed Fan Usage</b>	Yes

**PHEV/EV Charge Depleting Test Information**

<b>Recharge Event Voltage</b>	208	<b>Recharge Event Energy (kiloWatt-hours)</b>	90.946
<b>Charge Depleting Range (Calculated miles)</b>	469	<b>Charge Depleting Range (Actual miles)</b>	469
<b>Charge Depleting Range Highway (Calculated miles)</b>	--	<b>Derived 5-Cycle Coefficient Model Year</b>	--
<b>All Electric Range Unadjusted (miles)</b>	--	<b>Equivalent All Electric Range (miles)</b>	469
<b>Number of Charge Depleting Bags/Phases Conducted</b>	2	<b>Transition Bag/Phase Number</b>	--

**Charge Depleting Bag/Phase #1**

Test Result/Emission Name	Unrounded Test Result
Actual Distance Driven (miles)	0
Carbon Monoxide	0
Carbon dioxide	0
Carbon-Related Exhaust Emissions	0
Drive Trace Absolute Speed Change Rating	16.6623
Drive Trace Energy Economy Rating	3.3466
Drive Trace Inertia Work Ratio Rating	21.0054
Integrated DC KW-HRS	0
Manufacturer Fuel Economy	173.67
Nitrogen Oxide	0
Non-methane organic gases	0
Non-methane organic gases plus Nitrogen Oxides	999.999
Particulate Matter	0
System End State of Charge Watt-hours	80.099
System Start State of Charge Watt-hours	0

### Certification Summary Information Report

<b>Test Group</b>	TTSLV00.0L23	<b>Evaporative/Refueling Family</b>	--
-------------------	--------------	-------------------------------------	----

**Manufacturer Test Comments**

Internal Test results for MY2024 Model 3 Long Range AWD-E. Range determined by using SAE J1634 Multi-cycle test procedure. END-SOC - 80099 wh (System error limited to 4 digits). MCT dc wh/mi is attached with application. DC energy consumption HWFE1 = 173.96 Wh/mi; HWFE2 = 167.91 Wh/mi; HWFE average = 170.93 Wh/mi

Certification Region	Useful Life	Standard Level	Emission Name	Rounded Result	RAF	NMOG/NM HC Ratio	Diesel Adjustment Factor	Add DF	Mult DF	Certification Level	Standard	Pass/Fail
Fed	150,000 miles	Federal Tier 3 Bin 0	CO	0.0	--	--	--	0	--	0	0	Pass
Fed	150,000 miles	Federal Tier 3 Bin 0	CREE	0	--	--	--	0	--	0	--	--
CA	150,000 miles	California ZEV	CO	0.0	--	--	--	0	--	0	0	Pass
CA	150,000 miles	California ZEV	CREE	0	--	--	--	0	--	0	--	--

### Certification Summary Information Report

<b>Test Group</b>	TTSLV00.0L23	<b>Evaporative/Refueling Family</b>	--
-------------------	--------------	-------------------------------------	----

**Emission Data Vehicle Information**

Vehicle ID / Configuration	3D226-064265 / 0	Manufacturer Vehicle Configuration Number	0
Original Test Group Name	TTSLV00.0L23	Original Evaporative/Refueling Family	--
Original Test Vehicle Model Year	2026		
<b>Vehicle Model</b>			
Represented Test Vehicle Make	Tesla	Represented Test Vehicle Model	Model 3 Performance

**Leak Family Details**

Leak Family Identifier	--	Leak Family Name	--
------------------------	----	------------------	----

**Drive Sources and Fuel System Details**

Drive Source and Fuel#	Drive Source	Fuel
1	Electric Motor	Electricity

Hybrid Indicator	No	Multiple Fuel Combustion	--
Multiple Fuel Storage	--	Rechargeable Energy Storage System Indicator	Yes
Fuel Cell Indicator	No	Rechargeable Energy Storage System, if 'Other'	--
Rechargeable Energy Storage System	Battery(s)		
Off-board charge Capable Indicator	Yes	Odometer Correction Factor	1
Odometer Correction -- Initial	1	- = System Miles is equal to (Test odometer reading - Initial system miles) * Correction factor	
Odometer Correction Sign			
Odometer Correction Units	Miles	Rated Horsepower	510
Engine Code	L23	Air Aspiration Method, if 'Other'	
Displacement (liters)	0.001	Air Aspiration Device Configuration	--
Air Aspiration Method	Naturally Aspirated	Drive Mode While Testing	All Wheel Drive
Number of Air Aspiration Devices	--	Aged Emission Components	4,000 (mi)
Charge Air Cooler Type	--	Equivalent Test Weight (pounds)	4250
Shift Indicator Light Usage	Not equipped	N/V Ratio	114
Curb Weight (lbs)	4054	# of Transmission Gears	1
GVWR (lbs)	4974	Creeper Gear	No
Axle Ratio	1		
Transmission Type	Automatic		
Transmission Lockup	No		

**Dynamometer Coefficients:**

Coefficient Category	Target Coefficients			Set Coefficients			EPA Calculated Total Road Load Horse Power for City/Highway/Evap Coefficients
	A (lbf)	B (lbf/mph)	C (lbf/mph**2)	A (lbf)	B (lbf/mph)	C (lbf/mph**2)	
City/Highway/Evap	36.82	0.1386	0.01545	-9.24	0.1794	0.01315	11

**Emission Control Device Comments**      No Emissions Control Device - Pure Electric

### Certification Summary Information Report

Test Group	TTSLV00.0L23	Evaporative/Refueling Family	--
<b>Manufacturer Test Vehicle Comments</b>	This is MY2026 Model 3 Performance; Front Motor Power - 98 kW Rear Motor Power - 282 kW		

## Certification Summary Information Report

Test Group	TTSLV00.0L23	Evaporative/Refueling Family	--
<b>Test #</b>	<b>TTSL10092345</b>	<b>Test Procedure</b>	<b>77 - Multi-Cycle Test (MCT)</b>
<b>Exhaust Test # for this Evap Test</b>	--	<b>Test Fuel Type</b>	62 - Electricity
<b>Test Date</b>	09/19/2025	<b>Fuel</b>	Electricity
<b>Fuel Batch ID</b>	--	<b>Fuel Calibration Number</b>	--
<b>Vehicle Class</b>	LDV/Passenger Car	<b>DF Type</b>	EPA Assigned
<b>Verify Test Lab ID</b>	Tesla Kato		
<b>E10 Evaporative Test Measurement Method</b>	--		
<b>Test Start Odometer Reading</b>	2428	<b>Odometer Units</b>	M
<b>4WD Test Dyno</b>	Yes	<b>Diesel Adjustment Factor Usage</b>	--
<b>State of Charge Delta</b>	--		
<b>Drive Cycle Speed Tolerance Criteria</b>	Used Part 86 (+/- 2 mph, +/- 1 sec)	<b>Road Speed Fan Usage</b>	Yes
<b>PHEV/EV Charge Depleting Test Information</b>			
<b>Recharge Event Voltage</b>	208	<b>Recharge Event Energy (kiloWatt-hours)</b>	91.051
<b>Charge Depleting Range (Calculated miles)</b>	463.396	<b>Charge Depleting Range (Actual miles)</b>	463.396
<b>Charge Depleting Range Highway (Calculated miles)</b>	413.843	<b>Derived 5-Cycle Coefficient Model Year</b>	--
<b>All Electric Range Unadjusted (miles)</b>	--	<b>Equivalent All Electric Range (miles)</b>	463.396
<b>Number of Charge Depleting Bags/Phases Conducted</b>	8	<b>Transition Bag/Phase Number</b>	--
<b>Charge Depleting Bag/Phase #1</b>			
<b>Test Result/Emission Name</b>		<b>Unrounded Test Result</b>	
Actual Distance Driven (miles)		7.465	
Carbon-Related Exhaust Emissions		0	
Drive Trace Absolute Speed Change Rating		1.4901	
Drive Trace Energy Economy Rating		1.0394	
Drive Trace Inertia Work Ratio Rating		2.242	
Integrated DC KW-HRS		1.473	
Manufacturer Fuel Economy		19.732	
<b>Charge Depleting Bag/Phase #2</b>			

## Certification Summary Information Report

Test Group	TTSLV00.0L23	Evaporative/Refueling Family	--																
<table border="1"> <thead> <tr> <th>Test Result/Emission Name</th> <th>Unrounded Test Result</th> </tr> </thead> <tbody> <tr> <td>Actual Distance Driven (miles)</td> <td>10.259</td> </tr> <tr> <td>Carbon-Related Exhaust Emissions</td> <td>0</td> </tr> <tr> <td>Drive Trace Absolute Speed Change Rating</td> <td>2.6226</td> </tr> <tr> <td>Drive Trace Energy Economy Rating</td> <td>0.3191</td> </tr> <tr> <td>Drive Trace Inertia Work Ratio Rating</td> <td>3.4171</td> </tr> <tr> <td>Integrated DC KW-HRS</td> <td>2.0075</td> </tr> <tr> <td>Manufacturer Fuel Economy</td> <td>19.569</td> </tr> </tbody> </table>				Test Result/Emission Name	Unrounded Test Result	Actual Distance Driven (miles)	10.259	Carbon-Related Exhaust Emissions	0	Drive Trace Absolute Speed Change Rating	2.6226	Drive Trace Energy Economy Rating	0.3191	Drive Trace Inertia Work Ratio Rating	3.4171	Integrated DC KW-HRS	2.0075	Manufacturer Fuel Economy	19.569
Test Result/Emission Name	Unrounded Test Result																		
Actual Distance Driven (miles)	10.259																		
Carbon-Related Exhaust Emissions	0																		
Drive Trace Absolute Speed Change Rating	2.6226																		
Drive Trace Energy Economy Rating	0.3191																		
Drive Trace Inertia Work Ratio Rating	3.4171																		
Integrated DC KW-HRS	2.0075																		
Manufacturer Fuel Economy	19.569																		
<b>Charge Depleting Bag/Phase #3</b>																			
<table border="1"> <thead> <tr> <th>Test Result/Emission Name</th> <th>Unrounded Test Result</th> </tr> </thead> <tbody> <tr> <td>Actual Distance Driven (miles)</td> <td>7.465</td> </tr> <tr> <td>Carbon-Related Exhaust Emissions</td> <td>0</td> </tr> <tr> <td>Drive Trace Absolute Speed Change Rating</td> <td>1.5653</td> </tr> <tr> <td>Drive Trace Energy Economy Rating</td> <td>0.9521</td> </tr> <tr> <td>Drive Trace Inertia Work Ratio Rating</td> <td>2.65</td> </tr> <tr> <td>Integrated DC KW-HRS</td> <td>1.3157</td> </tr> <tr> <td>Manufacturer Fuel Economy</td> <td>17.624</td> </tr> </tbody> </table>				Test Result/Emission Name	Unrounded Test Result	Actual Distance Driven (miles)	7.465	Carbon-Related Exhaust Emissions	0	Drive Trace Absolute Speed Change Rating	1.5653	Drive Trace Energy Economy Rating	0.9521	Drive Trace Inertia Work Ratio Rating	2.65	Integrated DC KW-HRS	1.3157	Manufacturer Fuel Economy	17.624
Test Result/Emission Name	Unrounded Test Result																		
Actual Distance Driven (miles)	7.465																		
Carbon-Related Exhaust Emissions	0																		
Drive Trace Absolute Speed Change Rating	1.5653																		
Drive Trace Energy Economy Rating	0.9521																		
Drive Trace Inertia Work Ratio Rating	2.65																		
Integrated DC KW-HRS	1.3157																		
Manufacturer Fuel Economy	17.624																		
<b>Charge Depleting Bag/Phase #4</b>																			
<table border="1"> <thead> <tr> <th>Test Result/Emission Name</th> <th>Unrounded Test Result</th> </tr> </thead> <tbody> <tr> <td>Actual Distance Driven (miles)</td> <td>270.65</td> </tr> <tr> <td>Carbon-Related Exhaust Emissions</td> <td>0</td> </tr> <tr> <td>Drive Trace Absolute Speed Change Rating</td> <td>5.5521</td> </tr> <tr> <td>Drive Trace Energy Economy Rating</td> <td>0.8996</td> </tr> <tr> <td>Drive Trace Inertia Work Ratio Rating</td> <td>11.1906</td> </tr> <tr> <td>Integrated DC KW-HRS</td> <td>66.141</td> </tr> <tr> <td>Manufacturer Fuel Economy</td> <td>24.438</td> </tr> </tbody> </table>				Test Result/Emission Name	Unrounded Test Result	Actual Distance Driven (miles)	270.65	Carbon-Related Exhaust Emissions	0	Drive Trace Absolute Speed Change Rating	5.5521	Drive Trace Energy Economy Rating	0.8996	Drive Trace Inertia Work Ratio Rating	11.1906	Integrated DC KW-HRS	66.141	Manufacturer Fuel Economy	24.438
Test Result/Emission Name	Unrounded Test Result																		
Actual Distance Driven (miles)	270.65																		
Carbon-Related Exhaust Emissions	0																		
Drive Trace Absolute Speed Change Rating	5.5521																		
Drive Trace Energy Economy Rating	0.8996																		
Drive Trace Inertia Work Ratio Rating	11.1906																		
Integrated DC KW-HRS	66.141																		
Manufacturer Fuel Economy	24.438																		
<b>Charge Depleting Bag/Phase #5</b>																			
<table border="1"> <thead> <tr> <th>Test Result/Emission Name</th> <th>Unrounded Test Result</th> </tr> </thead> <tbody> <tr> <td>Actual Distance Driven (miles)</td> <td>7.454</td> </tr> <tr> <td>Carbon-Related Exhaust Emissions</td> <td>0</td> </tr> <tr> <td>Drive Trace Absolute Speed Change Rating</td> <td>1.7208</td> </tr> <tr> <td>Drive Trace Energy Economy Rating</td> <td>0.7513</td> </tr> <tr> <td>Drive Trace Inertia Work Ratio Rating</td> <td>2.7039</td> </tr> <tr> <td>Integrated DC KW-HRS</td> <td>1.258</td> </tr> <tr> <td>Manufacturer Fuel Economy</td> <td>16.877</td> </tr> </tbody> </table>				Test Result/Emission Name	Unrounded Test Result	Actual Distance Driven (miles)	7.454	Carbon-Related Exhaust Emissions	0	Drive Trace Absolute Speed Change Rating	1.7208	Drive Trace Energy Economy Rating	0.7513	Drive Trace Inertia Work Ratio Rating	2.7039	Integrated DC KW-HRS	1.258	Manufacturer Fuel Economy	16.877
Test Result/Emission Name	Unrounded Test Result																		
Actual Distance Driven (miles)	7.454																		
Carbon-Related Exhaust Emissions	0																		
Drive Trace Absolute Speed Change Rating	1.7208																		
Drive Trace Energy Economy Rating	0.7513																		
Drive Trace Inertia Work Ratio Rating	2.7039																		
Integrated DC KW-HRS	1.258																		
Manufacturer Fuel Economy	16.877																		
<b>Charge Depleting Bag/Phase #6</b>																			

## Certification Summary Information Report

Test Group	TTSLV00.0L23	Evaporative/Refueling Family	--																
<table border="1"> <thead> <tr> <th>Test Result/Emission Name</th> <th>Unrounded Test Result</th> </tr> </thead> <tbody> <tr> <td>Actual Distance Driven (miles)</td> <td>10.249</td> </tr> <tr> <td>Carbon-Related Exhaust Emissions</td> <td>0</td> </tr> <tr> <td>Drive Trace Absolute Speed Change Rating</td> <td>5.067</td> </tr> <tr> <td>Drive Trace Energy Economy Rating</td> <td>1.4931</td> </tr> <tr> <td>Drive Trace Inertia Work Ratio Rating</td> <td>5.9817</td> </tr> <tr> <td>Integrated DC KW-HRS</td> <td>1.9489</td> </tr> <tr> <td>Manufacturer Fuel Economy</td> <td>19.015</td> </tr> </tbody> </table>				Test Result/Emission Name	Unrounded Test Result	Actual Distance Driven (miles)	10.249	Carbon-Related Exhaust Emissions	0	Drive Trace Absolute Speed Change Rating	5.067	Drive Trace Energy Economy Rating	1.4931	Drive Trace Inertia Work Ratio Rating	5.9817	Integrated DC KW-HRS	1.9489	Manufacturer Fuel Economy	19.015
Test Result/Emission Name	Unrounded Test Result																		
Actual Distance Driven (miles)	10.249																		
Carbon-Related Exhaust Emissions	0																		
Drive Trace Absolute Speed Change Rating	5.067																		
Drive Trace Energy Economy Rating	1.4931																		
Drive Trace Inertia Work Ratio Rating	5.9817																		
Integrated DC KW-HRS	1.9489																		
Manufacturer Fuel Economy	19.015																		
<b>Charge Depleting Bag/Phase #7</b>																			
<table border="1"> <thead> <tr> <th>Test Result/Emission Name</th> <th>Unrounded Test Result</th> </tr> </thead> <tbody> <tr> <td>Actual Distance Driven (miles)</td> <td>7.456</td> </tr> <tr> <td>Carbon-Related Exhaust Emissions</td> <td>0</td> </tr> <tr> <td>Drive Trace Absolute Speed Change Rating</td> <td>1.7517</td> </tr> <tr> <td>Drive Trace Energy Economy Rating</td> <td>1.407</td> </tr> <tr> <td>Drive Trace Inertia Work Ratio Rating</td> <td>2.6807</td> </tr> <tr> <td>Integrated DC KW-HRS</td> <td>1.2707</td> </tr> <tr> <td>Manufacturer Fuel Economy</td> <td>17.044</td> </tr> </tbody> </table>				Test Result/Emission Name	Unrounded Test Result	Actual Distance Driven (miles)	7.456	Carbon-Related Exhaust Emissions	0	Drive Trace Absolute Speed Change Rating	1.7517	Drive Trace Energy Economy Rating	1.407	Drive Trace Inertia Work Ratio Rating	2.6807	Integrated DC KW-HRS	1.2707	Manufacturer Fuel Economy	17.044
Test Result/Emission Name	Unrounded Test Result																		
Actual Distance Driven (miles)	7.456																		
Carbon-Related Exhaust Emissions	0																		
Drive Trace Absolute Speed Change Rating	1.7517																		
Drive Trace Energy Economy Rating	1.407																		
Drive Trace Inertia Work Ratio Rating	2.6807																		
Integrated DC KW-HRS	1.2707																		
Manufacturer Fuel Economy	17.044																		
<b>Charge Depleting Bag/Phase #8</b>																			
<table border="1"> <thead> <tr> <th>Test Result/Emission Name</th> <th>Unrounded Test Result</th> </tr> </thead> <tbody> <tr> <td>Actual Distance Driven (miles)</td> <td>18.09</td> </tr> <tr> <td>Carbon-Related Exhaust Emissions</td> <td>0</td> </tr> <tr> <td>Drive Trace Absolute Speed Change Rating</td> <td>2.0711</td> </tr> <tr> <td>Drive Trace Energy Economy Rating</td> <td>-0.2488</td> </tr> <tr> <td>Drive Trace Inertia Work Ratio Rating</td> <td>4.1692</td> </tr> <tr> <td>Integrated DC KW-HRS</td> <td>4.4235</td> </tr> <tr> <td>Manufacturer Fuel Economy</td> <td>24.453</td> </tr> </tbody> </table>				Test Result/Emission Name	Unrounded Test Result	Actual Distance Driven (miles)	18.09	Carbon-Related Exhaust Emissions	0	Drive Trace Absolute Speed Change Rating	2.0711	Drive Trace Energy Economy Rating	-0.2488	Drive Trace Inertia Work Ratio Rating	4.1692	Integrated DC KW-HRS	4.4235	Manufacturer Fuel Economy	24.453
Test Result/Emission Name	Unrounded Test Result																		
Actual Distance Driven (miles)	18.09																		
Carbon-Related Exhaust Emissions	0																		
Drive Trace Absolute Speed Change Rating	2.0711																		
Drive Trace Energy Economy Rating	-0.2488																		
Drive Trace Inertia Work Ratio Rating	4.1692																		
Integrated DC KW-HRS	4.4235																		
Manufacturer Fuel Economy	24.453																		
<b>Manufacturer Test Comments</b>	--																		

### Certification Summary Information Report

Test Group		TTSLV00.0L23				Evaporative/Refueling Family					--	
Certification Region	Useful Life	Standard Level	Emission Name	Rounded Result	RAF	NMOG/NM HC Ratio	Diesel Adjustment Factor	Add DF	Mult DF	Certification Level	Standard	Pass/Fail
Fed	150,000 miles	Federal Tier 3 Bin 0	CREE	0	--	--	--	0	--	0	--	--
Fed	150,000 miles	Federal Tier 3 Bin 0	CREE	0	--	--	--	0	--	0	--	--
Fed	150,000 miles	Federal Tier 3 Bin 0	CREE	0	--	--	--	0	--	0	--	--
Fed	150,000 miles	Federal Tier 3 Bin 0	CREE	0	--	--	--	0	--	0	--	--
Fed	150,000 miles	Federal Tier 3 Bin 0	CREE	0	--	--	--	0	--	0	--	--
Fed	150,000 miles	Federal Tier 3 Bin 0	CREE	0	--	--	--	0	--	0	--	--
Fed	150,000 miles	Federal Tier 3 Bin 0	CREE	0	--	--	--	0	--	0	--	--
Fed	150,000 miles	Federal Tier 3 Bin 0	CREE	0	--	--	--	0	--	0	--	--
CA	150,000 miles	California ZEV	CREE	0	--	--	--	0	--	0	--	--
CA	150,000 miles	California ZEV	CREE	0	--	--	--	0	--	0	--	--
CA	150,000 miles	California ZEV	CREE	0	--	--	--	0	--	0	--	--
CA	150,000 miles	California ZEV	CREE	0	--	--	--	0	--	0	--	--
CA	150,000 miles	California ZEV	CREE	0	--	--	--	0	--	0	--	--
CA	150,000 miles	California ZEV	CREE	0	--	--	--	0	--	0	--	--
CA	150,000 miles	California ZEV	CREE	0	--	--	--	0	--	0	--	--
CA	150,000 miles	California ZEV	CREE	0	--	--	--	0	--	0	--	--

### Certification Summary Information Report

<b>Test Group</b>	TTSLV00.0L23	<b>Evaporative/Refueling Family</b>	--
-------------------	--------------	-------------------------------------	----

**Emission Data Vehicle Information**

Vehicle ID / Configuration	3D226-127749 / 0	Manufacturer Vehicle Configuration Number	0
Original Test Group Name	TTSLV00.0L23	Original Evaporative/Refueling Family	--
Original Test Vehicle Model Year	2026		
<b>Vehicle Model</b>			
Represented Test Vehicle Make	Tesla	Represented Test Vehicle Model	Model 3 Performance AWD

**Leak Family Details**

Leak Family Identifier	--	Leak Family Name	--
------------------------	----	------------------	----

**Drive Sources and Fuel System Details**

Drive Source and Fuel#	Drive Source	Fuel
1	Electric Motor	Electricity

Hybrid Indicator	No	Multiple Fuel Combustion	--
Multiple Fuel Storage	--	Rechargeable Energy Storage System Indicator	Yes
Fuel Cell Indicator	No	Rechargeable Energy Storage System, if 'Other'	--
Rechargeable Energy Storage System	Battery(s)		
Off-board charge Capable Indicator	Yes	Odometer Correction Factor	1
Odometer Correction -- Initial	1	- = System Miles is equal to (Test odometer reading - Initial system miles) * Correction factor	
Odometer Correction Sign			
Odometer Correction Units	Miles	Rated Horsepower	510
Engine Code	L23	Air Aspiration Method, if 'Other'	
Displacement (liters)	0.001	Air Aspiration Device Configuration	--
Air Aspiration Method	Naturally Aspirated	Drive Mode While Testing	All Wheel Drive
Number of Air Aspiration Devices	--	Aged Emission Components	4,000 (mi)
Charge Air Cooler Type	--	Equivalent Test Weight (pounds)	4250
Shift Indicator Light Usage	Not equipped	N/V Ratio	114
Curb Weight (lbs)	4054	# of Transmission Gears	1
GVWR (lbs)	4974	Creeper Gear	No
Axle Ratio	1		
Transmission Type	Automatic		
Transmission Lockup	No		

**Dynamometer Coefficients:**

Coefficient Category	Target Coefficients			Set Coefficients			EPA Calculated Total Road Load Horse Power for City/Highway/Evap Coefficients
	A (lbf)	B (lbf/mph)	C (lbf/mph**2)	A (lbf)	B (lbf/mph)	C (lbf/mph**2)	
City/Highway/Evap	36.82	0.1386	0.01545	-10.25	0.1725	0.01362	11

**Emission Control Device Comments**      No Emissions Control Device - Pure Electric

### Certification Summary Information Report

Test Group	TTSLV00.0L23	Evaporative/Refueling Family	--
<b>Manufacturer Test Vehicle Comments</b>	This is MY2026 Model 3 Performance AWD; Front Motor Power - 98 kW Rear Motor Power - 282 kW Corrected for EPA CT dyno set coefficients.		

**Certification Summary Information Report**

<b>Test Group</b>	TTSLV00.0L23	<b>Evaporative/Refueling Family</b>	--
<b>Test #</b>	<b>TTSL10092893</b>	<b>Test Procedure</b>	<b>77 - Multi-Cycle Test (MCT)</b>
<b>Exhaust Test # for this Evap Test</b>	--	<b>Test Fuel Type</b>	62 - Electricity
<b>Test Date</b>	12/18/2025	<b>Fuel</b>	Electricity
<b>Fuel Batch ID</b>	--	<b>Fuel Calibration Number</b>	--
<b>Vehicle Class</b>	LDV/Passenger Car	<b>DF Type</b>	EPA Assigned
<b>Verify Test Lab ID</b>	National Vehicle and Fuel Emissions Laboratory		
<b>E10 Evaporative Test Measurement Method</b>	--		
<b>Test Start Odometer Reading</b>	2541	<b>Odometer Units</b>	M
<b>4WD Test Dyno</b>	Yes	<b>Diesel Adjustment Factor Usage</b>	--
<b>State of Charge Delta</b>	--		
<b>Drive Cycle Speed Tolerance Criteria</b>	Used Part 86 (+/- 2 mph, +/- 1 sec)	<b>Road Speed Fan Usage</b>	Yes

**PHEV/EV Charge Depleting Test Information**

<b>Recharge Event Voltage</b>	249	<b>Recharge Event Energy (kiloWatt-hours)</b>	95.3102
<b>Charge Depleting Range (Calculated miles)</b>	471.305	<b>Charge Depleting Range (Actual miles)</b>	471.305
<b>Charge Depleting Range Highway (Calculated miles)</b>	426.815	<b>Derived 5-Cycle Coefficient Model Year</b>	--
<b>All Electric Range Unadjusted (miles)</b>	--	<b>Equivalent All Electric Range (miles)</b>	471.305
<b>Number of Charge Depleting Bags/Phases Conducted</b>	8	<b>Transition Bag/Phase Number</b>	--

**Charge Depleting Bag/Phase #1**

Test Result/Emission Name	Unrounded Test Result
Actual Distance Driven (miles)	7.409
Carbon-Related Exhaust Emissions	0
Drive Trace Absolute Speed Change Rating	-0.31
Drive Trace Energy Economy Rating	-0.225
Drive Trace Inertia Work Ratio Rating	-0.302
Integrated DC KW-HRS	1.42124
Manufacturer Fuel Economy	19.184

**Charge Depleting Bag/Phase #2**

## Certification Summary Information Report

Test Group	TTSLV00.0L23	Evaporative/Refueling Family	--																
<table border="1"> <thead> <tr> <th>Test Result/Emission Name</th> <th>Unrounded Test Result</th> </tr> </thead> <tbody> <tr> <td>Actual Distance Driven (miles)</td> <td>10.244</td> </tr> <tr> <td>Carbon-Related Exhaust Emissions</td> <td>0</td> </tr> <tr> <td>Drive Trace Absolute Speed Change Rating</td> <td>2.23</td> </tr> <tr> <td>Drive Trace Energy Economy Rating</td> <td>-0.263</td> </tr> <tr> <td>Drive Trace Inertia Work Ratio Rating</td> <td>2.828</td> </tr> <tr> <td>Integrated DC KW-HRS</td> <td>2.0205</td> </tr> <tr> <td>Manufacturer Fuel Economy</td> <td>19.724</td> </tr> </tbody> </table>				Test Result/Emission Name	Unrounded Test Result	Actual Distance Driven (miles)	10.244	Carbon-Related Exhaust Emissions	0	Drive Trace Absolute Speed Change Rating	2.23	Drive Trace Energy Economy Rating	-0.263	Drive Trace Inertia Work Ratio Rating	2.828	Integrated DC KW-HRS	2.0205	Manufacturer Fuel Economy	19.724
Test Result/Emission Name	Unrounded Test Result																		
Actual Distance Driven (miles)	10.244																		
Carbon-Related Exhaust Emissions	0																		
Drive Trace Absolute Speed Change Rating	2.23																		
Drive Trace Energy Economy Rating	-0.263																		
Drive Trace Inertia Work Ratio Rating	2.828																		
Integrated DC KW-HRS	2.0205																		
Manufacturer Fuel Economy	19.724																		
<b>Charge Depleting Bag/Phase #3</b>																			
<table border="1"> <thead> <tr> <th>Test Result/Emission Name</th> <th>Unrounded Test Result</th> </tr> </thead> <tbody> <tr> <td>Actual Distance Driven (miles)</td> <td>7.427</td> </tr> <tr> <td>Carbon-Related Exhaust Emissions</td> <td>0</td> </tr> <tr> <td>Drive Trace Absolute Speed Change Rating</td> <td>1.04</td> </tr> <tr> <td>Drive Trace Energy Economy Rating</td> <td>0.826</td> </tr> <tr> <td>Drive Trace Inertia Work Ratio Rating</td> <td>1.598</td> </tr> <tr> <td>Integrated DC KW-HRS</td> <td>1.339</td> </tr> <tr> <td>Manufacturer Fuel Economy</td> <td>18.028</td> </tr> </tbody> </table>				Test Result/Emission Name	Unrounded Test Result	Actual Distance Driven (miles)	7.427	Carbon-Related Exhaust Emissions	0	Drive Trace Absolute Speed Change Rating	1.04	Drive Trace Energy Economy Rating	0.826	Drive Trace Inertia Work Ratio Rating	1.598	Integrated DC KW-HRS	1.339	Manufacturer Fuel Economy	18.028
Test Result/Emission Name	Unrounded Test Result																		
Actual Distance Driven (miles)	7.427																		
Carbon-Related Exhaust Emissions	0																		
Drive Trace Absolute Speed Change Rating	1.04																		
Drive Trace Energy Economy Rating	0.826																		
Drive Trace Inertia Work Ratio Rating	1.598																		
Integrated DC KW-HRS	1.339																		
Manufacturer Fuel Economy	18.028																		
<b>Charge Depleting Bag/Phase #4</b>																			
<table border="1"> <thead> <tr> <th>Test Result/Emission Name</th> <th>Unrounded Test Result</th> </tr> </thead> <tbody> <tr> <td>Actual Distance Driven (miles)</td> <td>258.129</td> </tr> <tr> <td>Carbon-Related Exhaust Emissions</td> <td>0</td> </tr> <tr> <td>Drive Trace Absolute Speed Change Rating</td> <td>0</td> </tr> <tr> <td>Drive Trace Energy Economy Rating</td> <td>0</td> </tr> <tr> <td>Drive Trace Inertia Work Ratio Rating</td> <td>0</td> </tr> <tr> <td>Integrated DC KW-HRS</td> <td>63.31193</td> </tr> <tr> <td>Manufacturer Fuel Economy</td> <td>24.527</td> </tr> </tbody> </table>				Test Result/Emission Name	Unrounded Test Result	Actual Distance Driven (miles)	258.129	Carbon-Related Exhaust Emissions	0	Drive Trace Absolute Speed Change Rating	0	Drive Trace Energy Economy Rating	0	Drive Trace Inertia Work Ratio Rating	0	Integrated DC KW-HRS	63.31193	Manufacturer Fuel Economy	24.527
Test Result/Emission Name	Unrounded Test Result																		
Actual Distance Driven (miles)	258.129																		
Carbon-Related Exhaust Emissions	0																		
Drive Trace Absolute Speed Change Rating	0																		
Drive Trace Energy Economy Rating	0																		
Drive Trace Inertia Work Ratio Rating	0																		
Integrated DC KW-HRS	63.31193																		
Manufacturer Fuel Economy	24.527																		
<b>Charge Depleting Bag/Phase #5</b>																			
<table border="1"> <thead> <tr> <th>Test Result/Emission Name</th> <th>Unrounded Test Result</th> </tr> </thead> <tbody> <tr> <td>Actual Distance Driven (miles)</td> <td>7.403</td> </tr> <tr> <td>Carbon-Related Exhaust Emissions</td> <td>0</td> </tr> <tr> <td>Drive Trace Absolute Speed Change Rating</td> <td>0.33</td> </tr> <tr> <td>Drive Trace Energy Economy Rating</td> <td>0.663</td> </tr> <tr> <td>Drive Trace Inertia Work Ratio Rating</td> <td>0.819</td> </tr> <tr> <td>Integrated DC KW-HRS</td> <td>1.29887</td> </tr> <tr> <td>Manufacturer Fuel Economy</td> <td>17.545</td> </tr> </tbody> </table>				Test Result/Emission Name	Unrounded Test Result	Actual Distance Driven (miles)	7.403	Carbon-Related Exhaust Emissions	0	Drive Trace Absolute Speed Change Rating	0.33	Drive Trace Energy Economy Rating	0.663	Drive Trace Inertia Work Ratio Rating	0.819	Integrated DC KW-HRS	1.29887	Manufacturer Fuel Economy	17.545
Test Result/Emission Name	Unrounded Test Result																		
Actual Distance Driven (miles)	7.403																		
Carbon-Related Exhaust Emissions	0																		
Drive Trace Absolute Speed Change Rating	0.33																		
Drive Trace Energy Economy Rating	0.663																		
Drive Trace Inertia Work Ratio Rating	0.819																		
Integrated DC KW-HRS	1.29887																		
Manufacturer Fuel Economy	17.545																		
<b>Charge Depleting Bag/Phase #6</b>																			

## Certification Summary Information Report

<b>Test Group</b>	TTSLV00.0L23	Evaporative/Refueling Family	--
-------------------	--------------	------------------------------	----

Test Result/Emission Name	Unrounded Test Result
Actual Distance Driven (miles)	10.257
Carbon-Related Exhaust Emissions	0
Drive Trace Absolute Speed Change Rating	2.81
Drive Trace Energy Economy Rating	-0.023
Drive Trace Inertia Work Ratio Rating	3.649
Integrated DC KW-HRS	1.98305
Manufacturer Fuel Economy	19.334

**Charge Depleting Bag/Phase #7**

Test Result/Emission Name	Unrounded Test Result
Actual Distance Driven (miles)	7.432
Carbon-Related Exhaust Emissions	0
Drive Trace Absolute Speed Change Rating	0.57
Drive Trace Energy Economy Rating	0.467
Drive Trace Inertia Work Ratio Rating	1.124
Integrated DC KW-HRS	1.29343
Manufacturer Fuel Economy	17.405

**Charge Depleting Bag/Phase #8**

Test Result/Emission Name	Unrounded Test Result
Actual Distance Driven (miles)	44.678
Carbon-Related Exhaust Emissions	0
Drive Trace Absolute Speed Change Rating	0
Drive Trace Energy Economy Rating	0
Drive Trace Inertia Work Ratio Rating	0
Integrated DC KW-HRS	10.68367
Manufacturer Fuel Economy	23.913

**Manufacturer Test Comments**

NVFEL Laboratory Test Data - Vehicle Emission Test Results Test Record #: D006\_202512180659\_00295 DT-ASCR, DT-EER, DT-IWRR: No data for CSC Phase 4 & 8.

### Certification Summary Information Report

Test Group		TTSLV00.0L23				Evaporative/Refueling Family				--		
Certification Region	Useful Life	Standard Level	Emission Name	Rounded Result	RAF	NMOG/NM HC Ratio	Diesel Adjustment Factor	Add DF	Mult DF	Certification Level	Standard	Pass/Fail
Fed	150,000 miles	Federal Tier 3 Bin 0	CREE	0	--	--	--	0	--	0	--	--
Fed	150,000 miles	Federal Tier 3 Bin 0	CREE	0	--	--	--	0	--	0	--	--
Fed	150,000 miles	Federal Tier 3 Bin 0	CREE	0	--	--	--	0	--	0	--	--
Fed	150,000 miles	Federal Tier 3 Bin 0	CREE	0	--	--	--	0	--	0	--	--
Fed	150,000 miles	Federal Tier 3 Bin 0	CREE	0	--	--	--	0	--	0	--	--
Fed	150,000 miles	Federal Tier 3 Bin 0	CREE	0	--	--	--	0	--	0	--	--
Fed	150,000 miles	Federal Tier 3 Bin 0	CREE	0	--	--	--	0	--	0	--	--
Fed	150,000 miles	Federal Tier 3 Bin 0	CREE	0	--	--	--	0	--	0	--	--
CA	150,000 miles	California ZEV	CREE	0	--	--	--	0	--	0	--	--
CA	150,000 miles	California ZEV	CREE	0	--	--	--	0	--	0	--	--
CA	150,000 miles	California ZEV	CREE	0	--	--	--	0	--	0	--	--
CA	150,000 miles	California ZEV	CREE	0	--	--	--	0	--	0	--	--
CA	150,000 miles	California ZEV	CREE	0	--	--	--	0	--	0	--	--
CA	150,000 miles	California ZEV	CREE	0	--	--	--	0	--	0	--	--
CA	150,000 miles	California ZEV	CREE	0	--	--	--	0	--	0	--	--
CA	150,000 miles	California ZEV	CREE	0	--	--	--	0	--	0	--	--

### Certification Summary Information Report

<b>Test Group</b>	TTSLV00.0L23	<b>Evaporative/Refueling Family</b>	--
-------------------	--------------	-------------------------------------	----

**Emission Data Vehicle Information**

Vehicle ID / Configuration	3D226-R00620 / 0	Manufacturer Vehicle Configuration Number	0
Original Test Group Name	TTSLV00.0L23	Original Evaporative/Refueling Family	--
Original Test Vehicle Model Year	2026		
<b>Vehicle Model</b>			
Represented Test Vehicle Make	Tesla	Represented Test Vehicle Model	Model 3 Premium AWD-I

**Leak Family Details**

Leak Family Identifier	--	Leak Family Name	--
------------------------	----	------------------	----

**Drive Sources and Fuel System Details**

Drive Source and Fuel#	Drive Source	Fuel
1	Electric Motor	Electricity

Hybrid Indicator	No	Multiple Fuel Combustion	--
Multiple Fuel Storage	--	Rechargeable Energy Storage System Indicator	Yes
Fuel Cell Indicator	No	Rechargeable Energy Storage System, if 'Other'	--
Rechargeable Energy Storage System	Battery(s)		
Off-board charge Capable Indicator	Yes	Odometer Correction Factor	1
Odometer Correction -- Initial	1	- = System Miles is equal to (Test odometer reading - Initial system miles) * Correction factor	
Odometer Correction Sign			
Odometer Correction Units	Miles	Rated Horsepower	375
Engine Code	L23	Air Aspiration Method, if 'Other'	
Displacement (liters)	0.001	Air Aspiration Device Configuration	--
Air Aspiration Method	Naturally Aspirated	Drive Mode While Testing	All Wheel Drive
Number of Air Aspiration Devices	--	Aged Emission Components	4,000 (mi)
Charge Air Cooler Type	--	Equivalent Test Weight (pounds)	4250
Shift Indicator Light Usage	Not equipped	N/V Ratio	115
Curb Weight (lbs)	4030	# of Transmission Gears	1
GVWR (lbs)	4952	Creeper Gear	No
Axle Ratio	1		
Transmission Type	Automatic		
Transmission Lockup	No		

**Dynamometer Coefficients:**

Coefficient Category	Target Coefficients			Set Coefficients			EPA Calculated Total Road Load Horse Power for City/Highway/Evap Coefficients
	A (lbf)	B (lbf/mph)	C (lbf/mph**2)	A (lbf)	B (lbf/mph)	C (lbf/mph**2)	
City/Highway/Evap	27.07	0.2869	0.01279	-2.22	0.1042	0.01241	9.8

**Emission Control Device Comments**      No Emissions Control Device - Pure Electric

### Certification Summary Information Report

Test Group	TTSLV00.0L23	Evaporative/Refueling Family	--
<b>Manufacturer Test Vehicle Comments</b>	This is 2026 Model 3 Premium AWD-I; Front Motor Power - 76 kW; Rear Motor Power - 204 kW;		

**Certification Summary Information Report**

<b>Test Group</b>	TTSLV00.0L23	<b>Evaporative/Refueling Family</b>	--
<b>Test #</b>	<b>TTSL10093981</b>	<b>Test Procedure</b>	<b>77 - Multi-Cycle Test (MCT)</b>
<b>Exhaust Test # for this Evap Test</b>	--	<b>Test Fuel Type</b>	62 - Electricity
<b>Test Date</b>	04/20/2026	<b>Fuel</b>	Electricity
<b>Fuel Batch ID</b>	--	<b>Fuel Calibration Number</b>	--
<b>Vehicle Class</b>	LDV/Passenger Car	<b>DF Type</b>	EPA Assigned
<b>Verify Test Lab ID</b>	R&D Innovation Center, Tesla Gigafactory Shanghai		
<b>E10 Evaporative Test Measurement Method</b>	--		
<b>Test Start Odometer Reading</b>	2638	<b>Odometer Units</b>	M
<b>4WD Test Dyno</b>	Yes	<b>Diesel Adjustment Factor Usage</b>	--
<b>State of Charge Delta</b>	--		
<b>Drive Cycle Speed Tolerance Criteria</b>	Used Part 86 (+/- 2 mph, +/- 1 sec)	<b>Road Speed Fan Usage</b>	Yes
<b>PHEV/EV Charge Depleting Test Information</b>			
<b>Recharge Event Voltage</b>	208	<b>Recharge Event Energy (kiloWatt-hours)</b>	93.9215
<b>Charge Depleting Range (Calculated miles)</b>	531.18	<b>Charge Depleting Range (Actual miles)</b>	531.18
<b>Charge Depleting Range Highway (Calculated miles)</b>	482.542	<b>Derived 5-Cycle Coefficient Model Year</b>	--
<b>All Electric Range Unadjusted (miles)</b>	--	<b>Equivalent All Electric Range (miles)</b>	531.18
<b>Number of Charge Depleting Bags/Phases Conducted</b>	8	<b>Transition Bag/Phase Number</b>	--
<b>Charge Depleting Bag/Phase #1</b>			
<b>Test Result/Emission Name</b>		<b>Unrounded Test Result</b>	
Actual Distance Driven (miles)		7.442	
Carbon-Related Exhaust Emissions		0	
Drive Trace Absolute Speed Change Rating		-0.7385	
Drive Trace Energy Economy Rating		-1.5138	
Drive Trace Inertia Work Ratio Rating		-1.4193	
Integrated DC KW-HRS		1.2517	
Manufacturer Fuel Economy		16.818	
<b>Charge Depleting Bag/Phase #2</b>			

## Certification Summary Information Report

Test Group	TTSLV00.0L23	Evaporative/Refueling Family	--																
<table border="1"> <thead> <tr> <th>Test Result/Emission Name</th> <th>Unrounded Test Result</th> </tr> </thead> <tbody> <tr> <td>Actual Distance Driven (miles)</td> <td>10.278</td> </tr> <tr> <td>Carbon-Related Exhaust Emissions</td> <td>0</td> </tr> <tr> <td>Drive Trace Absolute Speed Change Rating</td> <td>4.7383</td> </tr> <tr> <td>Drive Trace Energy Economy Rating</td> <td>1.0394</td> </tr> <tr> <td>Drive Trace Inertia Work Ratio Rating</td> <td>6.4236</td> </tr> <tr> <td>Integrated DC KW-HRS</td> <td>1.7859</td> </tr> <tr> <td>Manufacturer Fuel Economy</td> <td>17.376</td> </tr> </tbody> </table>				Test Result/Emission Name	Unrounded Test Result	Actual Distance Driven (miles)	10.278	Carbon-Related Exhaust Emissions	0	Drive Trace Absolute Speed Change Rating	4.7383	Drive Trace Energy Economy Rating	1.0394	Drive Trace Inertia Work Ratio Rating	6.4236	Integrated DC KW-HRS	1.7859	Manufacturer Fuel Economy	17.376
Test Result/Emission Name	Unrounded Test Result																		
Actual Distance Driven (miles)	10.278																		
Carbon-Related Exhaust Emissions	0																		
Drive Trace Absolute Speed Change Rating	4.7383																		
Drive Trace Energy Economy Rating	1.0394																		
Drive Trace Inertia Work Ratio Rating	6.4236																		
Integrated DC KW-HRS	1.7859																		
Manufacturer Fuel Economy	17.376																		
<b>Charge Depleting Bag/Phase #3</b>																			
<table border="1"> <thead> <tr> <th>Test Result/Emission Name</th> <th>Unrounded Test Result</th> </tr> </thead> <tbody> <tr> <td>Actual Distance Driven (miles)</td> <td>7.439</td> </tr> <tr> <td>Carbon-Related Exhaust Emissions</td> <td>0</td> </tr> <tr> <td>Drive Trace Absolute Speed Change Rating</td> <td>-0.1935</td> </tr> <tr> <td>Drive Trace Energy Economy Rating</td> <td>-0.459</td> </tr> <tr> <td>Drive Trace Inertia Work Ratio Rating</td> <td>0.1425</td> </tr> <tr> <td>Integrated DC KW-HRS</td> <td>1.1741</td> </tr> <tr> <td>Manufacturer Fuel Economy</td> <td>15.783</td> </tr> </tbody> </table>				Test Result/Emission Name	Unrounded Test Result	Actual Distance Driven (miles)	7.439	Carbon-Related Exhaust Emissions	0	Drive Trace Absolute Speed Change Rating	-0.1935	Drive Trace Energy Economy Rating	-0.459	Drive Trace Inertia Work Ratio Rating	0.1425	Integrated DC KW-HRS	1.1741	Manufacturer Fuel Economy	15.783
Test Result/Emission Name	Unrounded Test Result																		
Actual Distance Driven (miles)	7.439																		
Carbon-Related Exhaust Emissions	0																		
Drive Trace Absolute Speed Change Rating	-0.1935																		
Drive Trace Energy Economy Rating	-0.459																		
Drive Trace Inertia Work Ratio Rating	0.1425																		
Integrated DC KW-HRS	1.1741																		
Manufacturer Fuel Economy	15.783																		
<b>Charge Depleting Bag/Phase #4</b>																			
<table border="1"> <thead> <tr> <th>Test Result/Emission Name</th> <th>Unrounded Test Result</th> </tr> </thead> <tbody> <tr> <td>Actual Distance Driven (miles)</td> <td>334.206</td> </tr> <tr> <td>Carbon-Related Exhaust Emissions</td> <td>0</td> </tr> <tr> <td>Drive Trace Absolute Speed Change Rating</td> <td>3.5667</td> </tr> <tr> <td>Drive Trace Energy Economy Rating</td> <td>-0.0096</td> </tr> <tr> <td>Drive Trace Inertia Work Ratio Rating</td> <td>7.1501</td> </tr> <tr> <td>Integrated DC KW-HRS</td> <td>70.8771</td> </tr> <tr> <td>Manufacturer Fuel Economy</td> <td>21.208</td> </tr> </tbody> </table>				Test Result/Emission Name	Unrounded Test Result	Actual Distance Driven (miles)	334.206	Carbon-Related Exhaust Emissions	0	Drive Trace Absolute Speed Change Rating	3.5667	Drive Trace Energy Economy Rating	-0.0096	Drive Trace Inertia Work Ratio Rating	7.1501	Integrated DC KW-HRS	70.8771	Manufacturer Fuel Economy	21.208
Test Result/Emission Name	Unrounded Test Result																		
Actual Distance Driven (miles)	334.206																		
Carbon-Related Exhaust Emissions	0																		
Drive Trace Absolute Speed Change Rating	3.5667																		
Drive Trace Energy Economy Rating	-0.0096																		
Drive Trace Inertia Work Ratio Rating	7.1501																		
Integrated DC KW-HRS	70.8771																		
Manufacturer Fuel Economy	21.208																		
<b>Charge Depleting Bag/Phase #5</b>																			
<table border="1"> <thead> <tr> <th>Test Result/Emission Name</th> <th>Unrounded Test Result</th> </tr> </thead> <tbody> <tr> <td>Actual Distance Driven (miles)</td> <td>7.44</td> </tr> <tr> <td>Carbon-Related Exhaust Emissions</td> <td>0</td> </tr> <tr> <td>Drive Trace Absolute Speed Change Rating</td> <td>-0.7352</td> </tr> <tr> <td>Drive Trace Energy Economy Rating</td> <td>-1.3219</td> </tr> <tr> <td>Drive Trace Inertia Work Ratio Rating</td> <td>-0.9754</td> </tr> <tr> <td>Integrated DC KW-HRS</td> <td>1.1351</td> </tr> <tr> <td>Manufacturer Fuel Economy</td> <td>15.257</td> </tr> </tbody> </table>				Test Result/Emission Name	Unrounded Test Result	Actual Distance Driven (miles)	7.44	Carbon-Related Exhaust Emissions	0	Drive Trace Absolute Speed Change Rating	-0.7352	Drive Trace Energy Economy Rating	-1.3219	Drive Trace Inertia Work Ratio Rating	-0.9754	Integrated DC KW-HRS	1.1351	Manufacturer Fuel Economy	15.257
Test Result/Emission Name	Unrounded Test Result																		
Actual Distance Driven (miles)	7.44																		
Carbon-Related Exhaust Emissions	0																		
Drive Trace Absolute Speed Change Rating	-0.7352																		
Drive Trace Energy Economy Rating	-1.3219																		
Drive Trace Inertia Work Ratio Rating	-0.9754																		
Integrated DC KW-HRS	1.1351																		
Manufacturer Fuel Economy	15.257																		
<b>Charge Depleting Bag/Phase #6</b>																			

## Certification Summary Information Report

Test Group	TTSLV00.0L23	Evaporative/Refueling Family	--																
<table border="1"> <thead> <tr> <th>Test Result/Emission Name</th> <th>Unrounded Test Result</th> </tr> </thead> <tbody> <tr> <td>Actual Distance Driven (miles)</td> <td>10.269</td> </tr> <tr> <td>Carbon-Related Exhaust Emissions</td> <td>0</td> </tr> <tr> <td>Drive Trace Absolute Speed Change Rating</td> <td>3.1549</td> </tr> <tr> <td>Drive Trace Energy Economy Rating</td> <td>0.1093</td> </tr> <tr> <td>Drive Trace Inertia Work Ratio Rating</td> <td>4.5512</td> </tr> <tr> <td>Integrated DC KW-HRS</td> <td>1.7375</td> </tr> <tr> <td>Manufacturer Fuel Economy</td> <td>16.92</td> </tr> </tbody> </table>				Test Result/Emission Name	Unrounded Test Result	Actual Distance Driven (miles)	10.269	Carbon-Related Exhaust Emissions	0	Drive Trace Absolute Speed Change Rating	3.1549	Drive Trace Energy Economy Rating	0.1093	Drive Trace Inertia Work Ratio Rating	4.5512	Integrated DC KW-HRS	1.7375	Manufacturer Fuel Economy	16.92
Test Result/Emission Name	Unrounded Test Result																		
Actual Distance Driven (miles)	10.269																		
Carbon-Related Exhaust Emissions	0																		
Drive Trace Absolute Speed Change Rating	3.1549																		
Drive Trace Energy Economy Rating	0.1093																		
Drive Trace Inertia Work Ratio Rating	4.5512																		
Integrated DC KW-HRS	1.7375																		
Manufacturer Fuel Economy	16.92																		
<b>Charge Depleting Bag/Phase #7</b>																			
<table border="1"> <thead> <tr> <th>Test Result/Emission Name</th> <th>Unrounded Test Result</th> </tr> </thead> <tbody> <tr> <td>Actual Distance Driven (miles)</td> <td>7.442</td> </tr> <tr> <td>Carbon-Related Exhaust Emissions</td> <td>0</td> </tr> <tr> <td>Drive Trace Absolute Speed Change Rating</td> <td>-0.7387</td> </tr> <tr> <td>Drive Trace Energy Economy Rating</td> <td>-0.9432</td> </tr> <tr> <td>Drive Trace Inertia Work Ratio Rating</td> <td>-0.7446</td> </tr> <tr> <td>Integrated DC KW-HRS</td> <td>1.1637</td> </tr> <tr> <td>Manufacturer Fuel Economy</td> <td>15.636</td> </tr> </tbody> </table>				Test Result/Emission Name	Unrounded Test Result	Actual Distance Driven (miles)	7.442	Carbon-Related Exhaust Emissions	0	Drive Trace Absolute Speed Change Rating	-0.7387	Drive Trace Energy Economy Rating	-0.9432	Drive Trace Inertia Work Ratio Rating	-0.7446	Integrated DC KW-HRS	1.1637	Manufacturer Fuel Economy	15.636
Test Result/Emission Name	Unrounded Test Result																		
Actual Distance Driven (miles)	7.442																		
Carbon-Related Exhaust Emissions	0																		
Drive Trace Absolute Speed Change Rating	-0.7387																		
Drive Trace Energy Economy Rating	-0.9432																		
Drive Trace Inertia Work Ratio Rating	-0.7446																		
Integrated DC KW-HRS	1.1637																		
Manufacturer Fuel Economy	15.636																		
<b>Charge Depleting Bag/Phase #8</b>																			
<table border="1"> <thead> <tr> <th>Test Result/Emission Name</th> <th>Unrounded Test Result</th> </tr> </thead> <tbody> <tr> <td>Actual Distance Driven (miles)</td> <td>17.024</td> </tr> <tr> <td>Carbon-Related Exhaust Emissions</td> <td>0</td> </tr> <tr> <td>Drive Trace Absolute Speed Change Rating</td> <td>1.0423</td> </tr> <tr> <td>Drive Trace Energy Economy Rating</td> <td>-1.4648</td> </tr> <tr> <td>Drive Trace Inertia Work Ratio Rating</td> <td>2.0881</td> </tr> <tr> <td>Integrated DC KW-HRS</td> <td>3.6212</td> </tr> <tr> <td>Manufacturer Fuel Economy</td> <td>21.271</td> </tr> </tbody> </table>				Test Result/Emission Name	Unrounded Test Result	Actual Distance Driven (miles)	17.024	Carbon-Related Exhaust Emissions	0	Drive Trace Absolute Speed Change Rating	1.0423	Drive Trace Energy Economy Rating	-1.4648	Drive Trace Inertia Work Ratio Rating	2.0881	Integrated DC KW-HRS	3.6212	Manufacturer Fuel Economy	21.271
Test Result/Emission Name	Unrounded Test Result																		
Actual Distance Driven (miles)	17.024																		
Carbon-Related Exhaust Emissions	0																		
Drive Trace Absolute Speed Change Rating	1.0423																		
Drive Trace Energy Economy Rating	-1.4648																		
Drive Trace Inertia Work Ratio Rating	2.0881																		
Integrated DC KW-HRS	3.6212																		
Manufacturer Fuel Economy	21.271																		
<b>Manufacturer Test Comments</b>	--																		

### Certification Summary Information Report

Test Group		TTSLV00.0L23				Evaporative/Refueling Family				--		
Certification Region	Useful Life	Standard Level	Emission Name	Rounded Result	RAF	NMOG/NM HC Ratio	Diesel Adjustment Factor	Add DF	Mult DF	Certification Level	Standard	Pass/Fail
Fed	150,000 miles	Federal Tier 3 Bin 0	CREE	0	--	--	--	0	--	0	--	--
Fed	150,000 miles	Federal Tier 3 Bin 0	CREE	0	--	--	--	0	--	0	--	--
Fed	150,000 miles	Federal Tier 3 Bin 0	CREE	0	--	--	--	0	--	0	--	--
Fed	150,000 miles	Federal Tier 3 Bin 0	CREE	0	--	--	--	0	--	0	--	--
Fed	150,000 miles	Federal Tier 3 Bin 0	CREE	0	--	--	--	0	--	0	--	--
Fed	150,000 miles	Federal Tier 3 Bin 0	CREE	0	--	--	--	0	--	0	--	--
Fed	150,000 miles	Federal Tier 3 Bin 0	CREE	0	--	--	--	0	--	0	--	--
Fed	150,000 miles	Federal Tier 3 Bin 0	CREE	0	--	--	--	0	--	0	--	--
CA	150,000 miles	California ZEV	CREE	0	--	--	--	0	--	0	--	--
CA	150,000 miles	California ZEV	CREE	0	--	--	--	0	--	0	--	--
CA	150,000 miles	California ZEV	CREE	0	--	--	--	0	--	0	--	--
CA	150,000 miles	California ZEV	CREE	0	--	--	--	0	--	0	--	--
CA	150,000 miles	California ZEV	CREE	0	--	--	--	0	--	0	--	--
CA	150,000 miles	California ZEV	CREE	0	--	--	--	0	--	0	--	--
CA	150,000 miles	California ZEV	CREE	0	--	--	--	0	--	0	--	--
CA	150,000 miles	California ZEV	CREE	0	--	--	--	0	--	0	--	--

**Fuel Properties**

### Certification Summary Information Report

<b>Test Group</b>	TTSLV00.0L23	<b>Evaporative/Refueling Family</b>	--
-------------------	--------------	-------------------------------------	----

#### Consolidated List of Standards

**Exhaust Standards**

<b>Cert Region</b>	California + CAA Section 177 states	<b>Cert/In-Use Code</b>	Cert
<b>Vehicle Class</b>	LDV/Passenger Car	<b>Standard Level</b>	California ZEV
<b>Fuel</b>	Electricity	<b>Test Procedure</b>	Charge Depleting UDDS

Useful Life	Emission Name	Rounded Result	RAF	NMOG / NMHC	Upward Diesel Adjustment Factor	Downward Diesel Adjustment Factor	Mult DF	Add DF	Std
150,000 miles	CO	--	--	--	--	--	--	0	0
150,000 miles	CO-COMP	--	--	--	--	--	--	0	0
150,000 miles	CREE	--	--	--	--	--	--	0	0
150,000 miles	NMOG+NOX-COMP	--	--	--	--	--	--	0	0

<b>Cert Region</b>	California + CAA Section 177 states	<b>Cert/In-Use Code</b>	Cert
<b>Vehicle Class</b>	LDV/Passenger Car	<b>Standard Level</b>	California ZEV
<b>Fuel</b>	Electricity	<b>Test Procedure</b>	Charge Depleting Highway

Useful Life	Emission Name	Rounded Result	RAF	NMOG / NMHC	Upward Diesel Adjustment Factor	Downward Diesel Adjustment Factor	Mult DF	Add DF	Std
150,000 miles	CO	--	--	--	--	--	--	0	0
150,000 miles	CO-COMP	--	--	--	--	--	--	0	0
150,000 miles	CREE	--	--	--	--	--	--	0	0
150,000 miles	NMOG+NOX-COMP	--	--	--	--	--	--	0	0

<b>Cert Region</b>	Federal	<b>Cert/In-Use Code</b>	Cert
<b>Vehicle Class</b>	LDV/Passenger Car	<b>Standard Level</b>	Federal Tier 3 Bin 0
<b>Fuel</b>	Electricity	<b>Test Procedure</b>	CVS 75 and later (w/o can. load)

Useful Life	Emission Name	Rounded Result	RAF	NMOG / NMHC	Upward Diesel Adjustment Factor	Downward Diesel Adjustment Factor	Mult DF	Add DF	Std
150,000 miles	CO	--	--	--	--	--	--	0	0

### Certification Summary Information Report

<b>Test Group</b>		TTSLV00.0L23			<b>Evaporative/Refueling Family</b>			--		
<b>Cert Region</b>		Federal			<b>Cert/In-Use Code</b>			Cert		
<b>Vehicle Class</b>		LDV/Passenger Car			<b>Standard Level</b>			Federal Tier 3 Bin 0		
<b>Fuel</b>		Electricity			<b>Test Procedure</b>			Multi-Cycle Test (MCT)		
<b>Useful Life</b>	<b>Emission Name</b>	<b>Rounded Result</b>	<b>RAF</b>	<b>NMOG / NMHC</b>	<b>Upward Diesel Adjustment Factor</b>	<b>Downward Diesel Adjustment Factor</b>	<b>Mult DF</b>	<b>Add DF</b>	<b>Std</b>	
150,000 miles	CO	--	--	--	--	--	--	0	0	
150,000 miles	CO-COMP	--	--	--	--	--	--	0	0	
150,000 miles	CREE	--	--	--	--	--	--	0	0	
150,000 miles	NMOG+NOX-COMP	--	--	--	--	--	--	0	0	

<b>Cert Region</b>		Federal			<b>Cert/In-Use Code</b>			Cert		
<b>Vehicle Class</b>		LDV/Passenger Car			<b>Standard Level</b>			Federal Tier 3 Bin 0		
<b>Fuel</b>		Electricity			<b>Test Procedure</b>			Charge Depleting UDDS		
<b>Useful Life</b>	<b>Emission Name</b>	<b>Rounded Result</b>	<b>RAF</b>	<b>NMOG / NMHC</b>	<b>Upward Diesel Adjustment Factor</b>	<b>Downward Diesel Adjustment Factor</b>	<b>Mult DF</b>	<b>Add DF</b>	<b>Std</b>	
150,000 miles	CO	--	--	--	--	--	--	0	0	
150,000 miles	CO-COMP	--	--	--	--	--	--	0	0	
150,000 miles	CREE	--	--	--	--	--	--	0	0	
150,000 miles	NMOG+NOX-COMP	--	--	--	--	--	--	0	0	

<b>Cert Region</b>		California + CAA Section 177 states			<b>Cert/In-Use Code</b>			Cert		
<b>Vehicle Class</b>		LDV/Passenger Car			<b>Standard Level</b>			California ZEV		
<b>Fuel</b>		Electricity			<b>Test Procedure</b>			Multi-Cycle Test (MCT)		
<b>Useful Life</b>	<b>Emission Name</b>	<b>Rounded Result</b>	<b>RAF</b>	<b>NMOG / NMHC</b>	<b>Upward Diesel Adjustment Factor</b>	<b>Downward Diesel Adjustment Factor</b>	<b>Mult DF</b>	<b>Add DF</b>	<b>Std</b>	
150,000 miles	CO	--	--	--	--	--	--	0	0	
150,000 miles	CO-COMP	--	--	--	--	--	--	0	0	
150,000 miles	CREE	--	--	--	--	--	--	0	0	
150,000 miles	NMOG+NOX-COMP	--	--	--	--	--	--	0	0	

### Certification Summary Information Report

<b>Test Group</b>		TTSLV00.0L23			<b>Evaporative/Refueling Family</b>			--		
<b>Cert Region</b>		Federal			<b>Cert/In-Use Code</b>			Cert		
<b>Vehicle Class</b>		LDV/Passenger Car			<b>Standard Level</b>			Federal Tier 3 Bin 0		
<b>Fuel</b>		Electricity			<b>Test Procedure</b>			Charge Depleting Highway		
<b>Useful Life</b>	<b>Emission Name</b>	<b>Rounded Result</b>	<b>RAF</b>	<b>NMOG / NMHC</b>	<b>Upward Diesel Adjustment Factor</b>	<b>Downward Diesel Adjustment Factor</b>	<b>Mult DF</b>	<b>Add DF</b>	<b>Std</b>	
150,000 miles	CO	--	--	--	--	--	--	0	0	
150,000 miles	CO-COMP	--	--	--	--	--	--	0	0	
150,000 miles	CREE	--	--	--	--	--	--	0	0	
150,000 miles	NMOG+NOX-COMP	--	--	--	--	--	--	0	0	
<b>Cert Region</b>		California + CAA Section 177 states			<b>Cert/In-Use Code</b>			Cert		
<b>Vehicle Class</b>		LDV/Passenger Car			<b>Standard Level</b>			California ZEV		
<b>Fuel</b>		Electricity			<b>Test Procedure</b>			CVS 75 and later (w/o can. load)		
<b>Useful Life</b>	<b>Emission Name</b>	<b>Rounded Result</b>	<b>RAF</b>	<b>NMOG / NMHC</b>	<b>Upward Diesel Adjustment Factor</b>	<b>Downward Diesel Adjustment Factor</b>	<b>Mult DF</b>	<b>Add DF</b>	<b>Std</b>	
150,000 miles	CO	--	--	--	--	--	--	0	0	

## Certification Summary Information Report

Test Group	TTSLV00.0L23	Evaporative/Refueling Family	--
<b>Glossary</b>			
<b>Useful Life</b>			
4	4,000 miles	120	120,000 miles
50	50,000 miles	150	150,000 miles
100	100,000 miles		
<b>Emission Name</b>			
HC-TOTAL	Total Hydrocarbon	COMB-CREE	Combined Carbon-Related Exhaust Emissions
CO	Carbon Monoxide	COMB-OPT-CREE	Combined Optional Carbon-Related Exhaust Emissions
CO2	Carbon dioxide	HC-TOTAL-EQUIV	Total Hydrocarbon equivalent - Evap only
CREE	Carbon-Related Exhaust Emissions	METHANE-COMB	Combined CH4 for HD 2b/3 vehicles only
OPT-CREE	Optional Carbon-Related Exhaust Emissions	N2O-COMB	Combined Nitrous Oxide for HD 2b/3 vehicles only
NOX	Nitrogen Oxide	LEAK-DIA	Effective Leak Diameter (inches)
PM	Particulate Matter	LEAK-GAS CAP	Gas Cap Leakage (cc/min)
PM-COMP	SFTP Composite Particulate Matter	CO2-COMB	Combined Carbon Dioxide for HD 2b/3 Vehicles Only
HC-NM	Non-methane Hydrocarbon	KW-HRS	Integrated DC KW-HRS
OMHCE	Organic material Hydrocarbon Equivalent	CH4 BAG 1	Bag 1 Methane
OMNMHCE	Organic material non-methane HC equivalent	CH4 BAG 2	Bag 2 Methane
NMOG	Non-methane organic gases	CH4 BAG 3	Bag 3 Methane
HCHO	Formaldehyde	CH4 BAG 4	Bag 4 Methane
H3C2HO	Acetaldehyde	CO BAG 1	Bag 1 Carbon Monoxide
HC-NM+NOX	SFTP Non-methane Hydrocarbon + Nitrogen Oxides for US06 or SC03	CO BAG 2	Bag 2 Carbon Monoxide
HC-NM+NOX-COMP	SFTP Composite Non-methane Hydrocarbon + Nitrogen Oxides	CO BAG 3	Bag 3 Carbon Monoxide
CO-COMP	SFTP Composite Carbon Monoxide	CO BAG 4	Bag 4 Carbon Monoxide
ETHANOL	C2H5OH - Ethanol	NMOG BAG 1	Bag 1 Non-methane organic gases
FE BAG 1	Bag 1 Fuel Economy	NMOG BAG 2	Bag 2 Non-methane organic gases
FE BAG 2	Bag 2 Fuel Economy	NMOG BAG 3	Bag 3 Non-methane organic gases
FE BAG 3	Bag 3 Fuel Economy	NMOG BAG 4	Bag 4 Non-methane organic gases
FE BAG 4	Bag 4 Fuel Economy	ACT-DISTANCE BAG 1	Bag 1 Actual Distance
MFR FE	Manufacturer Fuel Economy	ACT-DISTANCE BAG 2	Bag 2 Actual Distance
HC	Hydrocarbon for Running Loss and ORVR	ACT-DISTANCE BAG 3	Bag 3 Actual Distance
METHANE	CH4 - Methane	ACT-DISTANCE BAG 4	Bag 4 Actual Distance
METHANOL	CH3OH - Methanol	HC-TOTAL BAG 1	Bag 1 Total Hydrocarbon
N2O	Nitrous Oxide	HC-TOTAL BAG 2	Bag 2 Total Hydrocarbon
SPITBACK	Spitback Hydrocarbon in grams	HC-TOTAL BAG 3	Bag 3 Total Hydrocarbon
AMP-HRS	Integrated Amp-hours	HC-TOTAL BAG 4	Bag 4 Total Hydrocarbon
START-SOC	System Start State of Charge Watt-hours	WATT-HRS BAG 1	Bag 1 Watt Hours
END-SOC	System End State of Charge Watt-hours	WATT-HRS BAG 2	Bag 2 Watt Hours

## Certification Summary Information Report

Test Group		TTSLV00.0L23	Evaporative/Refueling Family		--
ACT-DISTANCE	Actual Distance Driven (miles)		WATT-HRS BAG 3	Bag 3 Watt Hours	
AS-VOLT	Average System Voltage		WATT-HRS BAG 4	Bag 4 Watt Hours	
CO2 BAG 1	Bag 1 Carbon Dioxide		WATT-HRS	Watt Hours	
CO2 BAG 2	Bag 2 Carbon Dioxide		HC-NM BAG 1	Bag 1 Non-methane Hydrocarbon	
CO2 BAG 3	Bag 3 Carbon Dioxide		HC-NM BAG 2	Bag 2 Non-methane Hydrocarbon	
CO2 BAG 4	Bag 4 Carbon Dioxide		HC-NM BAG 3	Bag 3 Non-methane Hydrocarbon	
NMOG+NOX	Non-methane organic gases plus Nitrogen Oxides		HC-NM BAG 4	Bag 4 Non-methane Hydrocarbon	
NMOG+NOX-COMP	SFTP Composite Non-methane Organic Gases + Nitrogen Oxides		N2O BAG 1	Bag 1 Nitrous Oxide	
DT-IWRR	Drive Trace Inertia Work Ratio Rating		N2O BAG 2	Bag 2 Nitrous Oxide	
DT-ASCR	Drive Trace Absolute Speed Change Rating		N2O BAG 3	Bag 3 Nitrous Oxide	
DT-EER	Drive Trace Energy Economy Rating		N2O BAG 4	Bag 4 Nitrous Oxide	
<b>Certification Region</b>					
CA	California + CAA Section 177 states		FA	Federal	
<b>Exhaust Emission Standard Level</b>					
B1	Federal Tier 2 Bin 1		HDV2B340	Federal Tier 3 HD Class 2b Transitional Bin 340	
B2	Federal Tier 2 Bin 2		HDV2B250	Federal Tier 3 HD Class 2b Bin 250	
B3	Federal Tier 2 Bin 3		HDV2B200	Federal Tier 3 HD Class 2b Bin 200	
B4	Federal Tier 2 Bin 4		HDV2B170	Federal Tier 3 HD Class 2b Bin 170	
B5	Federal Tier 2 Bin 5		HDV2B150	Federal Tier 3 HD Class 2b Bin 150	
B6	Federal Tier 2 Bin 6		HDV2B0	Federal Tier 3 HD Class 2b Bin 0	
B7	Federal Tier 2 Bin 7		HDV3B630	Federal Tier 3 HD Class 3 Transitional Bin 630	
B8	Federal Tier 2 Bin 8		HDV3B570	Federal Tier 3 HD Class 3 Transitional Bin 570	
B9	Federal Tier 2 Bin 9		HDV3B400	Federal Tier 3 HD Class 3 Bin 400	
B10	Federal Tier 2 Bin 10		HDV3B270	Federal Tier 3 HD Class 3 Bin 270	
B11	Federal Tier 2 Bin 11		HDV3B230	Federal Tier 3 HD Class 3 Bin 230	
HDV1	HDV1 (Federal HD chassis Class 2b GVW 8501-10000)		HDV3B200	Federal Tier 3 HD Class 3 Bin 200	
HDV2	HDV2 (Federal HD chassis Class 3 GVW 10001-14000)		HDV3B0	Federal Tier 3 HD Class 3 Bin 0	
L2	California LEV-II LEV		L4SULEV100	California LEV-IV SULEV100	
L2OP	California LEV-II LEV Optional		L4SULEV125	California LEV-IV SULEV125	
U2	California LEV-II ULEV		L4SULEV15	California LEV-IV SULEV15	
S2	California LEV-II SULEV		L4SULEV150	California LEV-IV SULEV150	
ZEV	California ZEV		L4SULEV170	California LEV-IV SULEV170	
OT	Other		L4SULEV175	California LEV-IV SULEV175	
T1	Federal Tier 1		L4SULEV20	California LEV-IV SULEV20	
PZEV	California PZEV		L4SULEV200	California LEV-IV SULEV200	
L2LEV160	California LEV-II LEV160		L4SULEV230	California LEV-IV SULEV230	
L2ULEV125	California LEV-II ULEV125		L4SULEV25	California LEV-IV SULEV25	
L2SULEV30	California LEV-II SULEV30		L4SULEV30	California LEV-IV SULEV30	
L2LEV395	California LEV-II LEV395		L4SULEV75	California LEV-IV SULEV75	

## Certification Summary Information Report

Test Group	TTSLV00.0L23	Evaporative/Refueling Family	--
L2ULEV340	California LEV-II ULEV340	L4SULEV85	California LEV-IV SULEV85
L2LEV630	California LEV-II LEV630	L4ULEV125	California LEV-IV ULEV125
L2ULEV570	California LEV-II ULEV570	L4ULEV200	California LEV-IV ULEV200
L3LEV160	California LEV-III LEV160	L4ULEV250	California LEV-IV ULEV250
L3ULEV125	California LEV-III ULEV125	L4ULEV270	California LEV-IV ULEV270
L3ULEV70	California LEV-III ULEV70	L4ULEV40	California LEV-IV ULEV40
L3ULEV50	California LEV-III ULEV50	L4ULEV400	California LEV-IV ULEV400
L3SULEV30	California LEV-III SULEV30	L4ULEV50	California LEV-IV ULEV50
L3SULEV20	California LEV-III SULEV20	L4ULEV60	California LEV-IV ULEV60
L3LEV395	California LEV-III LEV395	L4ULEV70	California LEV-IV ULEV70
L3ULEV340	California LEV-III ULEV340	T4B170	Federal Tier 4 MDV Bin 170
L3ULEV250	California LEV-III ULEV250	T4B150	Federal Tier 4 MDV Bin 150
L3ULEV200	California LEV-III ULEV200	T4B125	Federal Tier 4 MDV Bin 125
L3SULEV170	California LEV-III SULEV170	T4B100	Federal Tier 4 MDV Bin 100
L3SULEV150	California LEV-III SULEV150	T4B85	Federal Tier 4 MDV Bin 85
L3LEV630	California LEV-III LEV630	T4B75	Federal Tier 4 MDV Bin 75
L3ULEV570	California LEV-III ULEV570	T4B70	Federal Tier 4 Bin 70
L3ULEV400	California LEV-III ULEV400	T4B65	Federal Tier 4 Bin 65
L3ULEV270	California LEV-III ULEV270	T4B60	Federal Tier 4 Bin 60
L3SULEV230	California LEV-III SULEV230	T4B55	Federal Tier 4 Bin 55
L3SULEV200	California LEV-III SULEV200	T4B50	Federal Tier 4 Bin 50
T3B160	Federal Tier 3 Bin 160	T4B45	Federal Tier 4 Bin 45
T3B125	Federal Tier 3 Bin 125	T4B40	Federal Tier 4 Bin 40
T3B110	Federal Tier 3 Transitional Bin 110	T4B35	Federal Tier 4 Bin 35
T3B85	Federal Tier 3 Transitional Bin 85	T4B30	Federal Tier 4 Bin 30
T3SULEV30	Federal Tier 3 Transitional LEV-II SULEV30 Carryover	T4B25	Federal Tier 4 Bin 25
T3B70	Federal Tier 3 Bin 70	T4B20	Federal Tier 4 Bin 20
T3B50	Federal Tier 3 Bin 50	T4B15	Federal Tier 4 Bin 15
T3B30	Federal Tier 3 Bin 30	T4B10	Federal Tier 4 Bin 10
T3B20	Federal Tier 3 Bin 20	T4B5	Federal Tier 4 Bin 5
T3B0	Federal Tier 3 Bin 0	T4B0	Federal Tier 4 Bin 0
HDV2B395	Federal Tier 3 HD Class 2b Transitional Bin 395		
<b>Transmission Type Code</b>			
AMS	Automated Manual- Selectable (e.g. Automated Manual with paddles)	M	Manual
A	Automatic	OT	Other
AM	Automated Manual	SA	Semi-Automatic
CVT	Continuously Variable	SCV	Selectable Continuously Variable (e.g. CVT with paddles)
<b>Drive System Code</b>			
4	4-Wheel Drive	P	Part-time 4-Wheel Drive

### Certification Summary Information Report

Test Group	TTSLV00.0L23	Evaporative/Refueling Family		--
F	2-Wheel Drive, Front	A	All Wheel Drive	
R	2-Wheel Drive, Rear			
<b>Additional Terms and Acronyms</b>				
AFC	Alternative Fuel Converter	ICI	Independent Commercial Importer	
CSI	Certificate Summary Information	ORVR	Onboard Refueling Vapor Recovery	
DF	Deterioration Factor	SIL	Shift Indicator Light	
Evap	Evaporation, Evaporative	Trans	Transmission	