



UNITED STATES ENVIRONMENTAL PROTECTION AGENCY
WASHINGTON, DC 20460

OFFICE OF CHEMICAL SAFETY
AND POLLUTION PREVENTION

April 7, 2015

Mr. Mark Mongiovi
Assistant Manager
Regulatory Affairs
Woodstream Corporation
69 Locust Street
Lititz, PA 17543-0327

Subject: Notification per PRN 98-10 – Graphics & Symbols, Other Minor Revisions
Product Name: BROMETHALIN MOUSE BAIT STATION
EPA Registration Number: 36488-51
Application Date: March 23, 2015
Decision Number: D502812

Dear Mr. Mongiovi:

The Agency is in receipt of your Application for Pesticide Notification under Pesticide Registration Notice (PRN) 98-10 for the above referenced product. The Registration Division (RD) has conducted a review of this request for its applicability under PRN 98-10 and finds that the action requested falls within the scope of PRN 98-10.

The label submitted with the application has been stamped “Notification” and will be placed in our records.

If you have any questions, you may contact Dr. William W. Jacobs at 703-305-6406 or via email at jacobs.bill@epa.gov.

Sincerely,

A handwritten signature in cursive script that reads "William W. Jacobs" followed by the word "for" written in a smaller, simpler font.

Venus Eagle, Product Manager 01
Invertebrate and Vertebrate Branch 3
Registration Division (7505P)
Office of Pesticide Programs

MASTER LABEL – OUTER CONTAINER FRONT PANEL (Page 1 of 1)

BROMETHALIN MOUSE BAIT STATION

NOTIFICATION

36488-51

The applicant has certified that no changes, other than those reported to the Agency have been made to the labeling. The Agency acknowledges this notification by letter dated:

4/7/15

[Alternate Brand Names]

- Victor V® Fast-Kill® Brand Disposable Bait Station*
- Victor V® Fast-Kill® Brand Bait Station*

[Qualifier statement must immediately follow brand name]

** House Mice may consume a lethal dose in a single night's feeding, but it can take two or more days from the time of bait consumption for these mice to die.*

**THIS BAIT STATION IS NOT TAMPER-RESISTANT
Use Indoors Only in Areas Inaccessible to Children and Pets**

| ACTIVE INGREDIENT: | BY WT. |
|---------------------------------|---------------|
| Bromethalin..... | 0.01% |
| OTHER INGREDIENTS: | <u>99.99%</u> |
| TOTAL: | 100.00% |

KEEP OUT OF REACH OF CHILDREN

CAUTION: (See side [back] panel for additional precautionary statements)

NET CONTENTS:

[Contains] X [disposable] [prefilled] bait station[s] containing 0.75 oz. (21.2 g) bait

MASTER LABEL – OUTER CONTAINER BACK PANEL (Page 1 of 3)

PRECAUTIONARY STATEMENTS:

Hazards to Humans and Domestic Animals

CAUTION: Harmful if swallowed. Keep away from children, domestic animals and pets. Wash thoroughly with soap and water after handling, and before eating, drinking, chewing gum, or using tobacco.

| FIRST AID | |
|---|---|
| Have label with you when obtaining treatment advice. | |
| If swallowed: | <ul style="list-style-type: none">- Call a poison control center, doctor or 1-800-858-7378 immediately for treatment advice.- Have person sip a glass of water if able to swallow.- Do not induce vomiting unless told to do so by the poison control center or doctor.- Do not give anything by mouth to an unconscious person. |
| If on skin or clothing: | <ul style="list-style-type: none">- Take off contaminated clothing.- Rinse skin immediately with plenty of water for 15-20 minutes.- Call a poison control center or doctor for treatment advice. |
| TREATMENT FOR PET POISONING | |
| If an animal eats this bait, call a veterinarian at once. | |
| NOTE TO PHYSICIAN OR VETERINARIAN | |
| Contains the nerve poison Bromethalin. This product is not an anticoagulant rodenticide. For humans or animals ingesting bait and/or showing poisoning signs (such as muscle tremors, loss of hind limb use, or seizures for animals), limit absorption by either emesis or gastric lavage. Sublethal symptoms, if present, would be the result of cerebral edema and should be treated accordingly through administration of an osmotic diuretic and corticosteroid. | |

ENVIRONMENTAL HAZARDS:

This product is toxic to fish, birds and other wildlife. Dogs and scavenging mammals and birds might be poisoned if they feed upon animals that have eaten this bait. Do not apply this product directly to water.

MASTER LABEL – OUTER CONTAINER BACK PANEL (Page 2 of 3)

DIRECTIONS FOR USE

It is a violation of federal law to use this product in a manner inconsistent with its labeling.

READ THIS LABEL and follow all use directions and use precautions. Use only for the sites, pests, and application methods described on this label.

IMPORTANT: Do not expose children, pets or other nontarget animals to rodenticides. To help prevent accidents:

1. Store product not in use in a location out of reach of children and pets.
2. Dispose of product container, bait station, and used, spoiled, or unconsumed bait as specified on this label.

USE RESTRICTIONS:

DO NOT USE THIS PRODUCT OUTDOORS OR IN AREAS ACCESSIBLE TO CHILDREN, PETS, DOMESTIC ANIMALS, OR NONTARGET WILDLIFE. This product may only be used to control house mice inside homes, industrial, commercial, agricultural and public buildings. Do not place bait in areas where there is a possibility of contaminating food or surfaces that come in direct contact with food.

SELECTION OF TREATMENT AREAS: Determine areas where house mice will most likely find and consume bait. Generally, these areas are along walls, by gnawed openings, in corners and concealed places, between floors and walls, or in locations where house mice or their signs have been seen. Remove as much alternative food as possible.

APPLICATION DIRECTIONS:

1. Remove bait station from package.
2. Place bait station on the floor, with flat side down, in areas where signs of house mice have been seen in the types of buildings identified under **USE RESTRICTIONS**.

[Optional Graphics]

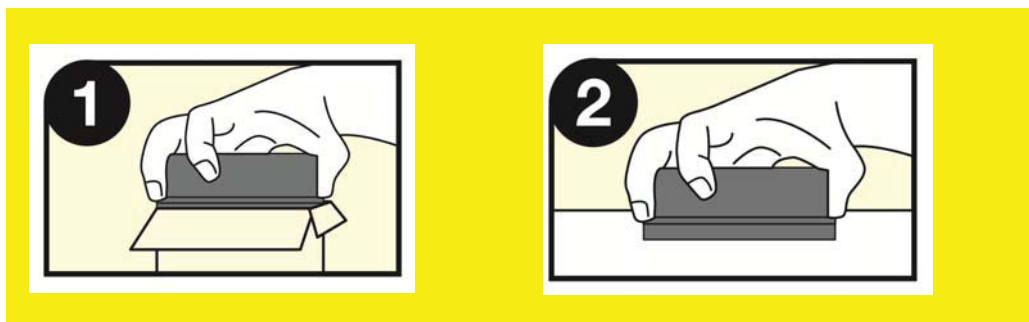

MASTER LABEL – OUTER CONTAINER BACK PANEL (Page 3 of 3)

Use one bait station per placement. If more than one bait station is used, space the stations 8 to 12 feet apart in suitable locations (see **SELECTION OF TREATMENT AREAS**) in infested buildings. After several days, inspect bait stations and replace them if their contents have been consumed or are heavily soiled. If no feeding has occurred after three days, bait stations may be moved to other appropriate locations in the building where there is evidence of feeding.

Baiting Strategy: Highest bait consumption is expected to occur on the first day or two after treatment begins. Normally, the volume of bait consumed will be significantly less with bromethalin baits than with anticoagulant baits. Although one night's feeding will usually provide a lethal dose, maintain an uninterrupted supply of bait for at least one week to provide all house mice a chance to feed on the bait. Continue baiting until at least 4 days have passed without signs of new feeding by house mice.

Follow-Up: Wearing gloves, collect and properly dispose of all dead animals and leftover bait. To discourage reinfestation, limit sources of rodent food, water and harborage as much as possible. If reinfestation does occur, repeat treatment.

STORAGE AND DISPOSAL:

STORAGE: Store in original container in a cool, dry place inaccessible to children and pets.

DISPOSAL: Nonrefillable container. Do not reuse or refill this container. **If empty:** Place in trash or offer for recycling if available. **If Partly Filled:** Call your local solid waste agency for disposal instructions. Never place unused product down any indoor or outdoor drain.

Note: Seller warrants that this product complies with the specifications expressed in this label. To the extent consistent with applicable law, Seller makes no other warranties, and disclaims all other warranties, express or implied, including but not limited to warranties of merchantability and fitness for the intended purpose. To the extent consistent with applicable law, Seller's liability or default, breach or failure under this label shall be limited to the amount of the purchase price. To the extent consistent with applicable law, Seller shall have no liability for consequential damages.

Manufactured For:
Woodstream Corporation
69 N. Locust St
Lititz, PA 17543
For Information Call: 1-800-800-1819

EPA Reg. No. 36488-51

EPA Est. No. 47629-PA-01

Made In USA

MASTER LABEL – LABEL FOR BAIT STATION (Page 1 of 1)

BROMETHALIN MOUSE BAIT STATION

| |
|--|
| <p>THIS BAIT STATION IS NOT TAMPER-RESISTANT Use Indoors Only in Areas Inaccessible to Children and Pets</p> |
|--|

| ACTIVE INGREDIENT: | BY WT. |
|---------------------------------|---------------|
| Bromethalin..... | 0.01% |
| OTHER INGREDIENTS: | <u>99.99%</u> |
| TOTAL: | 100.00% |

KEEP OUT OF REACH OF CHILDREN

CAUTION: (See outer package for additional precautionary statements, first aid information and directions for use.)

Manufactured For:
Woodstream Corporation
69 N. Locust St
Lititz, PA 17543-0327
For Information Call: 1-800-800-1819

EPA Reg. No. 36488-51

EPA Est. No. 47629-PA-01

NET CONTENTS: 0.75 oz (21.2 g)

MASTER LABEL – OPTIONAL CLAIMS (Page 1 of 1)

[Additional - Optional Marketing/Advertising Claim]

- Palatable bait formulation
- Contains Bromethalin
- 0.01% Bromethalin block
- Ready to use
- Disposable bait station
- For indoor use.
- For use in Attics, Kitchens, Basements, Garages at locations consistent with the limitations set for in the **DIRECTIONS FOR USE**
- Contains: (x no. of) prefilled, disposable bait station(s)
- **(X no. of) Bait Stations Included**
- Pre-filled bait station[s]
- Pre-baited
- No need to touch the bait when placing the bait station
- Bait station conceals bait from view
- Bait station
- Formulated for house mouse control
- Controls house mice
- Kills house mice
- Kills house mice in the home
- For use indoors for control of house mice
- For indoor house mouse control
- Kills Anticoagulant Resistant House Mice
- House Mice may consume a lethal dose in a single night's feeding, but it can take two or more days from the time of bait consumption for these mice to die. House mice cease feeding after consuming a toxic dose.
- This product is effective against anticoagulant-resistant house mice.
- Kills house mice dead
- Helps reduce house mouse problems
- Dual entry design
- House mice enter and feed inside the bait station
- Pre-baited station